

12D ADAC REPORT

Current Date: April 13, 2026, 9:02:28 AM (AEST)

Project name: Everleigh 8.3
ADAC version: 5.0.1
Description: SEWER
Project Status: As Constructed
Export date time: 2026-03-10T11:21:10
Owner: LCC
Receiver: LCC

Work Approval ID:
Drawing Number: MIR-0803
Drawing Revision:
Construction date: 2026-03-10
Software product: 12d Model 15.0C1t
Software version: 15.1.20.27

XSLT File: C:\Program Files\12d\12dmodel\15.00\library\adac_report_pdf_501.12dxslt
Output File: Z:\Shared\Drafting\2161-83C Everleigh Precinct 8.3\ASCON\ADAC ASCON\XMLS\ADAC SEWER 20260413.pdf

	Surveyor	Engineer
Name	SHADFORTH	PREMISE
Date Approved	2026-03-10	2026-03-10
Date final survey	2026-03-10	

Coordinate System

Horizontal coordinate MGA56
Horizontal datum GDA2020
Vertical datum AHD
Is approximate false
Origin mark
Notes

Drawing Extents

	X	Y
South West	499130.927396	6932342.968164
North East	499602.519733	6932523.346109

Sewerage Maintenance Hole

		ADACId	3777777	3777778	3777779	3777780	3777781	
		Use	Maintenance Shaft	Maintenance Shaft	Maintenance Shaft	Maintenance Shaft	Maintenance Shaft	Maintenance Shaft
		SurfaceLevel_m	57.364	57.514	54.661	54.69	57.905	
		InvertLevel_m	55.366199	55.481227	52.64	52.646	55.877	
		FloorConstruction	Prefabricated	Prefabricated	Prefabricated	Prefabricated	Prefabricated	
		FloorMaterial	PE	PE	PE	PE	PE	
		WallConstruction	Prefabricated	Prefabricated	Prefabricated	Prefabricated	Prefabricated	
		WallMaterial	PE	PE	PE	PE	PE	
		RoofMaterial	PE	PE	PE	PE	PE	
		Lining	Unlined	Unlined	Unlined	Unlined	Unlined	
		LidMaterial	PE	PE	PE	PE	PE	
		DropType	Straight Through MH	Straight Through MH	Straight Through MH	Straight Through MH	Straight Through MH	
		CatchmentPS						
		LineNumber						
		MH_Number	2/22	8/4	1/22	2/21	3/24	
		Chainage_m						
		TieDistance_m						
OffsetDistance_m								
Rotation	0	0	0	0	0			
ComponentInfo		InfrastructureCode						
		Owner	LCC	LCC	LCC	LCC	LCC	
		DrawingNumber	MIR-0803	MIR-0803	MIR-0803	MIR-0803	MIR-0803	
		DrawingRevision						
		ConstructionDate	2026-03-10	2026-03-10	2026-03-10	2026-03-10	2026-03-10	
		Department						
		Status	Newly Constructed	Newly Constructed	Newly Constructed	Newly Constructed	Newly Constructed	
		DataQuality	APlus	APlus	APlus	APlus	APlus	
		Notes						
		SupportingFiles						
		Surveyor		Name				
				DateFinalSurvey				
				DateApproved				
Engineer		Name						
		DateApproved						
ChamberSize		Type	Circular	Circular	Circular	Circular		
		Length_mm / Diameter_mm / Area_sqm	600	600	600	600		
		Width_mm						
Geometry		X	499418.456619	499413.314758	499519.521525	499540.792668	499505.828247	
		Y	6932407.141421	6932396.512848	6932387.635515	6932393.745964	6932456.105004	

Sewerage Maintenance Hole

	ADACId	3777782	3777783	3777784	3777785	3777786	
	Use	Maintenance Shaft	Maintenance Shaft	Maintenance Hole	Maintenance Shaft	Maintenance Shaft	
	SurfaceLevel_m	59.912	59.043	54.698	61.902	63.136	
	InvertLevel_m	57.685	57.049	52.432	59.737295	60.339	
	FloorConstruction	Prefabricated	Prefabricated	Insitu	Prefabricated	Prefabricated	
	FloorMaterial	PE	PE	Concrete	PE	PE	
	WallConstruction	Prefabricated	Prefabricated	Insitu	Prefabricated	Prefabricated	
	WallMaterial	PE	PE	Concrete	PE	PE	
	RoofMaterial	PE	PE	Concrete	PE	PE	
	Lining	Unlined	Unlined	Unlined	Unlined	Unlined	
	LidMaterial	PE	PE	Cast Iron	PE	PE	
	DropType	Straight Through MH	Straight Through MH	Straight Through MH	Straight Through MH	Straight Through MH	
	CatchmentPS						
	LineNumber						
	MH_Number	4/24	6/23	7/4	5/24	6/24	
	Chainage_m						
	TieDistance_m						
OffsetDistance_m							
Rotation	0	0	0	0	0		
ComponentInfo		InfrastructureCode					
		Owner	LCC	LCC	LCC	LCC	LCC
		DrawingNumber	MIR-0803	MIR-0803	MIR-0803	MIR-0803	MIR-0803
		DrawingRevision					
		ConstructionDate	2026-03-10	2026-03-10	2026-03-10	2026-03-10	2026-03-10
		Department					
		Status	Newly Constructed	Newly Constructed	Newly Constructed	Newly Constructed	Newly Constructed
		DataQuality	APlus	APlus	APlus	APlus	APlus
		Notes					
	SupportingFiles						
	Surveyor	Name					
		DateFinalSurvey					
		DateApproved					
	Engineer	Name					
DateApproved							
ChamberSize	Type	Circular	Circular	Circular	Circular	Circular	
	Length_mm / Diameter_mm / Area_sqm	600	600	1050	600	600	
	Width_mm						
Geometry	X	499430.520614	499400.341173	499517.57933	499323.577157	499236.280517	
	Y	6932470.628977	6932438.615318	6932376.446175	6932491.20144	6932507.904509	

Sewerage Maintenance Hole

	ADACId	3777787	3777788	3777789	3777790	3777791
	Use	Maintenance Shaft	Maintenance Shaft	Maintenance Shaft	Maintenance Shaft	Maintenance Hole
	SurfaceLevel_m	63.88	61.503	59.242	60.434	63.832
	InvertLevel_m	61.025	59.443	57.173	58.375	60.878
	FloorConstruction	Prefabricated	Prefabricated	Prefabricated	Prefabricated	Insitu
	FloorMaterial	PE	PE	PE	PE	Concrete
	WallConstruction	Prefabricated	Prefabricated	Prefabricated	Prefabricated	Insitu
	WallMaterial	PE	PE	PE	PE	Concrete
	RoofMaterial	PE	PE	PE	PE	Concrete
	Lining	Unlined	Unlined	Unlined	Unlined	Unlined
	LidMaterial	PE	PE	PE	PE	Cast Iron
	DropType	Straight Through MH	Straight Through MH	Straight Through MH	Straight Through MH	Straight Through MH
	CatchmentPS					
	LineNumber					
	MH_Number	1/30	2/28	1/29	4/27	8/24
	Chainage_m					
	TieDistance_m					
OffsetDistance_m						
Rotation	0	0	0	0	0	
ComponentInfo		InfrastructureCode				
		Owner	LCC	LCC	LCC	LCC
		DrawingNumber	MIR-0803	MIR-0803	MIR-0803	MIR-0803
		DrawingRevision				
		ConstructionDate	2026-03-10	2026-03-10	2026-03-10	2026-03-10
		Department				
		Status	Newly Constructed	Newly Constructed	Newly Constructed	Newly Constructed
		DataQuality	APlus	APlus	APlus	APlus
		Notes				
	SupportingFiles					
	Surveyor	Name				
		DateFinalSurvey				
		DateApproved				
	Engineer	Name				
DateApproved						
ChamberSize	Type	Circular	Circular	Circular	Circular	
	Length_mm / Diameter_mm / Area_sqm	600	600	600	1050	
	Width_mm					
Geometry	X	499154.435596	499246.465253	499311.603125	499336.831625	499162.337303
	Y	6932489.268294	6932428.592536	6932427.557949	6932451.182103	6932480.862792

Sewerage Maintenance Hole

	ADACId	3777792	3777793	3777797	3799743	
	Use	Maintenance Hole	Maintenance Shaft	Maintenance Hole	Maintenance Hole	
	SurfaceLevel_m	59.19	63.516	59.054	63.771	
	InvertLevel_m	56.73158	60.645	56.467	61.307	
	FloorConstruction	Insitu	Prefabricated	Insitu	Insitu	
	FloorMaterial	Concrete	PE	Concrete	Concrete	
	WallConstruction	Insitu	Prefabricated	Insitu	Insitu	
	WallMaterial	Concrete	PE	Concrete	Concrete	
	RoofMaterial	Concrete	PE	Concrete	Concrete	
	Lining	Unlined	Unlined	Unlined	Unlined	
	LidMaterial	Cast Iron	PE	Cast Iron	Cast Iron	
	DropType	Straight Through MH	Straight Through MH	Straight Through MH	Straight Through MH	
	CatchmentPS					
	LineNumber					
	MH_Number	1/28	7/24	3/27	2/30	
	Chainage_m					
	TieDistance_m					
OffsetDistance_m						
Rotation	0	0	0	0		
ComponentInfo		InfrastructureCode				
		Owner	LCC	LCC	LCC	LCC
		DrawingNumber	MIR-0803	MIR-0803	MIR-0803	MIR-0803
		DrawingRevision				
		ConstructionDate	2026-03-10	2026-03-10	2026-03-10	2026-03-10
		Department				
		Status	Newly Constructed	Newly Constructed	Newly Constructed	Newly Constructed
		DataQuality	APlus	APlus	APlus	APlus
		Notes				
		SupportingFiles				
	Surveyor	Name				
		DateFinalSurvey				
		DateApproved				
	Engineer	Name				
DateApproved						
ChamberSize	Type	Circular	Circular	Circular	Circular	
	Length_mm / Diameter_mm / Area_sqm	1050	600	1050	1050	
	Width_mm					
Geometry	X	499314.374967	499192.803623	499329.293753	499130.927396	
	Y	6932414.53937	6932508.999066	6932411.121788	6932523.346109	

Sewerage Pipe non pressure

	ADACId	3777803	3777804	3777805	3777808	3777809
	LineNumber	8/24 - E/24	8/24 - 1/30	HB1/30 - 1/30	7/24 - 8/24	HB3/24 - 7/24
	Use	Reticulation	Reticulation	Reticulation	Reticulation	Reticulation
	Diameter_mm	150	150	150	150	150
	Material	PVC-U	PVC-U	PVC-U	PVC-U	PVC-U
	Class	SN8	SN8	SN8	SN8	SN8
	Lining	Unlined	Unlined		Unlined	Unlined
	Protection	Uncoated	Uncoated	Uncoated	Uncoated	Uncoated
	JointType	RRJ	RRJ	RRJ	RRJ	RRJ
	US_InvertLevel_m	62.07	60.999	61.027	60.878	60.645
	DS_InvertLevel_m	61.796	60.967	61.02	60.669	60.624
	US_SurfaceLevel_m	64.025	63.88	63.783	63.832	63.516
	DS_SurfaceLevel_m	63.832	63.832	63.88	63.516	63.474
	Alignment_m					
	Depth_m	1.9955	2.873	2.757	2.9005	2.8605
	Embedment	GBS	GBS	GBS	GBS	GBS
	RockExcavated					
PipeGrade	2.3	0.645	0.554	0.521	0.277	
Length_m	11.918	10.07	2.022	40.099	7.591	
ComponentInfo		InfrastructureCode				
		Owner	LCC	LCC	LCC	LCC
		DrawingNumber	MIR-0803	MIR-0803	MIR-0803	MIR-0803
		DrawingRevision				
		ConstructionDate	2026-03-10	2026-03-10	2026-03-10	2026-03-10
		Department				
		Status	Newly Constructed	Newly Constructed	Newly Constructed	Newly Constructed
		DataQuality	APlus	APlus	APlus	APlus
	Notes					
	SupportingFiles					
	Surveyor	Name				
		DateFinalSurvey				
		DateApproved				
Engineer	Name					
	DateApproved					
Geometry	X	499153.129136	499154.890237	499155.307234	499162.999028	499193.540317
	Y	6932472.195405	6932488.585915	6932491.212484	6932481.496528	6932509.400898

Sewerage Pipe non pressure

	ADACId	3777810	3777811	3777812	3777813	3777814
	LineNumber	HB3/24 - HB2/24	HB2/24 - 6/24	5/24 - 6/24	4/24 - 5/24	3/24 - 4/24
	Use	Reticulation	Reticulation	Reticulation	Reticulation	Reticulation
	Diameter_mm	150	150	150	150	150
	Material	PVC-U	PVC-U	PVC-U	PVC-U	PVC-U
	Class	SN8	SN8	SN8	SN8	SN8
	Lining	Unlined	Unlined	Unlined	Unlined	Unlined
	Protection	Uncoated	Uncoated	Uncoated	Uncoated	Uncoated
	JointType	RRJ	RRJ	RRJ	RRJ	RRJ
	US_InvertLevel_m	60.624	60.564	60.326	59.737	57.685
	DS_InvertLevel_m	60.564	60.347	59.774	57.692	55.924
	US_SurfaceLevel_m	63.474	63.363	63.136	61.902	59.912
	DS_SurfaceLevel_m	63.363	63.136	61.902	59.912	57.905
	Alignment_m					
	Depth_m	2.825	2.798	2.469	2.1925	2.104
	Embedment	GBS	GBS	GBS	GBS	GBS
	RockExcavated					
PipeGrade	0.848	0.3	0.625	1.896	2.33	
Length_m	7.079	29.364	88.312	107.905	75.593	
ComponentInfo		InfrastructureCode				
		Owner	LCC	LCC	LCC	LCC
		DrawingNumber	MIR-0803	MIR-0803	MIR-0803	MIR-0803
		DrawingRevision				
		ConstructionDate	2026-03-10	2026-03-10	2026-03-10	2026-03-10
		Department				
		Status	Newly Constructed	Newly Constructed	Newly Constructed	Newly Constructed
		DataQuality	APlus	APlus	APlus	APlus
	Notes					
	SupportingFiles					
	Surveyor	Name				
		DateFinalSurvey				
		DateApproved				
	Engineer	Name				
DateApproved						
Geometry	X	499200.223626	499207.283594	499236.450202	499324.082065	499431.171342
	Y	6932512.966995	6932513.481195	6932507.866392	6932491.062831	6932470.411068

Sewerage Pipe non pressure

	ADACId	3777815	3777816	3777817	3777818	3777819
	LineNumber	EX2/24 - 3/24	1/29 - EX2/29	HB1/28 - 2/28	HB1/28 - 1/28	1/28 - 1/29
	Use	Reticulation	Reticulation	Reticulation	Reticulation	Reticulation
	Diameter_mm	150	150	150	150	150
	Material	PVC-U	PVC-U	PVC-U	PVC-U	PVC-U
	Class	SN8	SN8	SN8	SN8	SN8
	Lining	Unlined	Unlined	Unlined	Unlined	Unlined
	Protection	Uncoated	Uncoated	Uncoated	Uncoated	Uncoated
	JointType	RRJ	RRJ	RRJ	RRJ	RRJ
	US_InvertLevel_m	55.877	59.775	59.443	56.984	57.173
	DS_InvertLevel_m	53.488	57.235	56.984	56.849	56.856
	US_SurfaceLevel_m	57.905	57.905	61.503	59.292	59.242
	DS_SurfaceLevel_m	55.659	59.242	59.292	59.19	59.19
	Alignment_m					
	Depth_m	2.0995	0.0685	2.184	2.3245	2.2015
	Embedment	GBS	GBS	GBS	GBS	GBS
	RockExcavated					
PipeGrade	3.051	3.375	3.784	4.045	2.67	
Length_m	78.329	75.308	65.027	3.35	11.892	
ComponentInfo		InfrastructureCode				
		Owner	LCC	LCC	LCC	LCC
		DrawingNumber	MIR-0803	MIR-0803	MIR-0803	MIR-0803
		DrawingRevision				
		ConstructionDate	2026-03-10	2026-03-10	2026-03-10	2026-03-10
		Department				
		Status	Newly Constructed	Newly Constructed	Newly Constructed	Newly Constructed
		DataQuality	APlus	APlus	APlus	APlus
		Notes				
	SupportingFiles					
	Surveyor	Name				
		DateFinalSurvey				
		DateApproved				
Engineer	Name					
	DateApproved					
Geometry	X	499506.312045	499237.159132	499247.037014	499310.843438	499311.71108
	Y	6932456.002047	6932441.993958	6932428.4396	6932416.154698	6932426.839248

Sewerage Pipe non pressure

	ADACId	3777820	3777821	3777822	3777823	3777824
	LineNumber	3/27 - 1/28	3/27 - 4/27	EX2/27 - 3/27	EX5/23 - 6/23	7/4 - 8/4
	Use	Reticulation	Reticulation	Reticulation	Reticulation	Reticulation
	Diameter_mm	150	150	150	150	150
	Material	PVC-U	PVC-U	PVC-U	PVC-U	PVC-U
	Class	SN8	SN8	SN8	SN8	SN8
	Lining	Unlined	Unlined	Unlined	Unlined	Unlined
	Protection	Uncoated	Uncoated	Uncoated	Uncoated	Uncoated
	JointType	RRJ	RRJ	RRJ	RRJ	RRJ
	US_InvertLevel_m	56.732	58.375	56.467	57.049	55.481
	DS_InvertLevel_m	56.575	57.068	55.879	54.345	52.543
	US_SurfaceLevel_m	59.19	60.434	59.054	59.043	57.514
	DS_SurfaceLevel_m	59.054	59.054	58.041	56.494	54.698
	Alignment_m					
	Depth_m	2.4685	2.0225	2.3745	2.0715	2.094
	Embedment	GBS	GBS	GBS	GBS	GBS
	RockExcavated					
PipeGrade	1.104	3.347	3.176	4.59	2.804	
Length_m	14.178	39.069	18.522	58.975	104.837	
ComponentInfo		InfrastructureCode				
		Owner	LCC	LCC	LCC	LCC
		DrawingNumber	MIR-0803	MIR-0803	MIR-0803	MIR-0803
		DrawingRevision				
		ConstructionDate	2026-03-10	2026-03-10	2026-03-10	2026-03-10
		Department				
		Status	Newly Constructed	Newly Constructed	Newly Constructed	Newly Constructed
		DataQuality	APlus	APlus	APlus	APlus
		Notes				
	SupportingFiles					
	Surveyor	Name				
		DateFinalSurvey				
		DateApproved				
Engineer	Name					
	DateApproved					
Geometry	X	499314.780227	499336.781646	499329.189796	499400.172243	499413.810975
	Y	6932414.443767	6932450.403427	6932410.730951	6932438.054552	6932396.36474

Sewerage Pipe non pressure

	ADACId	3777825	3777826	3777827	3777828	3777829
	LineNumber	HB5/4 - 7/4	HB5/4 - HB4/4	HB4/4 - EX6/4	1/22 - 2/22	7/4 - 1/22
	Use	Reticulation	Reticulation	Reticulation	Reticulation	Reticulation
	Diameter_mm	150	150	150	150	150
	Material	PVC-U	PVC-U	PVC-U	PVC-U	PVC-U
	Class	SN8	SN8	SN8	SN8	SN8
	Lining	Unlined	Unlined	Unlined	Unlined	Unlined
	Protection	Uncoated	Uncoated	Uncoated	Uncoated	Uncoated
	JointType	RRJ	RRJ	RRJ	RRJ	RRJ
	US_InvertLevel_m	52.432	52.022	51.671	55.366	52.64
	DS_InvertLevel_m	52.022	51.671	50.831	52.663	52.541
	US_SurfaceLevel_m	54.698	54.319	53.866	57.364	54.661
	DS_SurfaceLevel_m	54.319	53.866	53.112	54.661	54.698
	Alignment_m					
	Depth_m	2.2815	2.246	2.238	1.998	2.089
	Embedment	GBS	GBS	GBS	GBS	GBS
	RockExcavated					
PipeGrade	4.952	5.203	5.031	2.657	0.988	
Length_m	8.289	6.755	16.716	101.775	10.019	
ComponentInfo		InfrastructureCode				
		Owner	LCC	LCC	LCC	LCC
		DrawingNumber	MIR-0803	MIR-0803	MIR-0803	MIR-0803
		DrawingRevision				
		ConstructionDate	2026-03-10	2026-03-10	2026-03-10	2026-03-10
		Department				
		Status	Newly Constructed	Newly Constructed	Newly Constructed	Newly Constructed
		DataQuality	APlus	APlus	APlus	APlus
		Notes				
	SupportingFiles					
	Surveyor	Name				
		DateFinalSurvey				
		DateApproved				
Engineer	Name					
	DateApproved					
Geometry	X	499518.1321	499526.204738	499530.712859	499419.255079	499519.320608
	Y	6932376.385201	6932374.583948	6932369.595025	6932407.003171	6932387.082745

Sewerage Pipe non pressure

	ADACId	3777830	3777807	3799999			
	LineNumber	EX1/21 - 2/21	FUT 2/30 - HB2/30	HB2/30 - HB1/30			
	Use	Reticulation	Reticulation	Reticulation			
	Diameter_mm	150	150	150			
	Material	PVC-U	PVC-U	PVC-U			
	Class	SN8	SN8	SN8			
	Lining	Unlined	Unlined	Unlined			
	Protection	Uncoated	Uncoated	Uncoated			
	JointType	RRJ	RRJ	RRJ			
	US_InvertLevel_m	52.646	61.307	61.307			
	DS_InvertLevel_m	51.229	61.062	61.062			
	US_SurfaceLevel_m	54.69	63.774	63.774			
	DS_SurfaceLevel_m	53.292	63.576	63.576			
	Alignment_m						
	Depth_m	2.0535	2.491	2.491			
	Embedment	GBS	GBS	GBS			
	RockExcavated						
PipeGrade	4.182	0.681	0.746				
Length_m	33.916	35.999	5.598				
ComponentInfo		InfrastructureCode					
		Owner	LCC	LCC	LCC		
		DrawingNumber	MIR-0803	MIR-0803	MIR-0803		
		DrawingRevision					
		ConstructionDate	2026-03-10	2026-03-10	2026-03-10		
		Department					
		Status	Newly Constructed	Newly Constructed	Newly Constructed		
		DataQuality	APlus	APlus	APlus		
		Notes					
	SupportingFiles						
	Surveyor	Name					
		DateFinalSurvey					
		DateApproved					
Engineer	Name						
	DateApproved						
Geometry	X	499540.847645	499131.435185	499155.287272			
	Y	6932392.995277	6932522.761352	6932496.770581			

Sewerage Fitting

		ADACId	3777776	3777794	3777795	3777796	3777798
		Type	Bend	Bend	Bend	Bend	Bend
		Material	PVC-U	PVC-U	PVC-U	PVC-U	PVC-U
		Lining	Unlined	Unlined	Unlined	Unlined	Unlined
		Protection	Uncoated	Uncoated	Uncoated	Uncoated	Uncoated
		BodySize_mm	150	150	150	150	150
		BranchSize_mm					
		Rotation					
ComponentInfo		InfrastructureCode					
		Owner	LCC	LCC	LCC	LCC	LCC
		DrawingNumber	MIR-0803	MIR-0803	MIR-0803	MIR-0803	MIR-0803
		DrawingRevision					
		ConstructionDate	2026-03-10	2026-03-10	2026-03-10	2026-03-10	2026-03-10
		Department					
		Status	Newly Constructed	Newly Constructed	Newly Constructed	Newly Constructed	Newly Constructed
		DataQuality	APlus	APlus	APlus	APlus	APlus
		Notes					
	SupportingFiles						
	Surveyor	Name					
		DateFinalSurvey					
		DateApproved					
	Engineer	Name					
DateApproved							
Geometry		X	499530.712859	499200.223626	499207.283594	499155.307234	499310.843438
		Y	6932369.595025	6932512.966995	6932513.481195	6932491.212484	6932416.154698

Sewerage Fitting

		ADACId	3777799	3777800	3777802		
		Type	Bend	Bend	Dead Plate		
		Material	PVC-U	PVC-U	PVC-U		
		Lining	Unlined	Unlined	Unlined		
		Protection	Uncoated	Uncoated	Uncoated		
		BodySize_mm	150	150	150		
		BranchSize_mm					
		Rotation					
ComponentInfo		InfrastructureCode					
		Owner	LCC	LCC	LCC		
		DrawingNumber	MIR-0803	MIR-0803	MIR-0803		
		DrawingRevision					
		ConstructionDate	2026-03-10	2026-03-10	2026-03-10		
		Department					
		Status	Newly Constructed	Newly Constructed	Newly Constructed		
		DataQuality	APlus	APlus	APlus		
		Notes					
	SupportingFiles						
	Surveyor	Name					
		DateFinalSurvey					
		DateApproved					
	Engineer	Name					
DateApproved							
Geometry		X	499155.287272	499526.204738	499153.129136		
		Y	6932496.770581	6932374.583948	6932472.195405		

Sewerage Connection

	ADACId	3777699	3777700	3777701	3777702	3777703	
	SurfaceLevel_m	64.203	63.875	63.706	63.265	63.128	
	InvertLevel_m	62.811	62.583	62.452	61.831	61.785	
	Use	House	House	House	House	House	
	Diameter_mm	100	100	100	100	100	
	Material	PVC-U	PVC-U	PVC-U	PVC-U	PVC-U	
	Class	SN10	SN10	SN10	SN10	SN10	
	Length_m	3.097	4.367	4.346	3.011	4.552	
	Type	Ramp Riser	Jump Up	Jump Up	Ramp Riser	Jump Up	
	Chainage_m	0	24.492	9.326	0.698	75.831	
	Offset_m	2.763	2.917	2.891	2.921	2.853	
	LineNumber	8/24 - E/24	7/24 - 8/24	7/24 - 8/24	5/24 - 6/24	5/24 - 6/24	
	DSMHID	E/24	7/24	7/24	6/24	5/24	
	IO_Distance_m	0.1	24.596	9.621	0.698	76.332	
	SO_Nearest_m	0.549	0.593	0.569	0.61	0.609	
SO_Other_m	7.42	7.472	7.504	4.999	5.016		
Sediment_Trap	false	false	false	false	false		
ComponentInfo		InfrastructureCode					
		Owner	LCC	LCC	LCC	LCC	LCC
		DrawingNumber	MIR-0803	MIR-0803	MIR-0803	MIR-0803	MIR-0803
		DrawingRevision					
		ConstructionDate	2026-03-10	2026-03-10	2026-03-10	2026-03-10	2026-03-10
		Department					
		Status	Newly Constructed	Newly Constructed	Newly Constructed	Newly Constructed	Newly Constructed
		DataQuality	APlus	APlus	APlus	APlus	APlus
		Notes					
	SupportingFiles						
	Surveyor	Name					
		DateFinalSurvey					
		DateApproved					
	Engineer	Name					
		DateApproved					
Geometry	X	499154.675491	499176.706322	499187.695748	499235.771728	499248.05961	
	Y	6932469.905358	6932490.17391	6932500.34767	6932505.056695	6932502.696675	

Sewerage Connection

	ADACId	3777704	3777705	3777706	3777707	3777708
	SurfaceLevel_m	62.831	62.66	62.446	62.254	63.043
	InvertLevel_m	61.438	61.278	61.095	60.868	61.707
	Use	House	House	House	House	House
	Diameter_mm	100	100	100	100	100
	Material	PVC-U	PVC-U	PVC-U	PVC-U	PVC-U
	Class	SN10	SN10	SN10	SN10	SN10
	Length_m	4.494	3.807	3.683	3.197	4.423
	Type	Jump Up	Ramp Riser	Ramp Riser	Ramp Riser	Jump Up
	Chainage_m	49.151	39.24	26.891	14.632	63.716
	Offset_m	2.898	2.866	2.9	2.753	2.87
	LineNumber	5/24 - 6/24	5/24 - 6/24	5/24 - 6/24	5/24 - 6/24	5/24 - 6/24
	DSMHID	5/24	5/24	5/24	5/24	5/24
	IO_Distance_m	49.909	39.812	27.426	14.932	63.842
	SO_Nearest_m	0.639	0.601	0.628	0.473	0.619
	SO_Other_m	6.45	2.553	4.942	4.942	5.011
Sediment_Trap	false	false	false	false	false	
ComponentInfo		InfrastructureCode				
		Owner	LCC	LCC	LCC	LCC
		DrawingNumber	MIR-0803	MIR-0803	MIR-0803	MIR-0803
		DrawingRevision				
		ConstructionDate	2026-03-10	2026-03-10	2026-03-10	2026-03-10
		Department				
		Status	Newly Constructed	Newly Constructed	Newly Constructed	Newly Constructed
		DataQuality	APlus	APlus	APlus	APlus
	Notes					
	SupportingFiles					
	Surveyor	Name				
		DateFinalSurvey				
		DateApproved				
	Engineer	Name				
DateApproved						
Geometry	X	499274.002804	499283.925671	499296.083607	499308.382485	499260.323502
	Y	6932497.682755	6932495.814531	6932493.451511	6932491.246426	6932500.330657

Sewerage Connection

	ADACId	3777709	3777710	3777711	3777712	3777713	
	SurfaceLevel_m	62.205	61.792	61.457	61.383	61.25	
	InvertLevel_m	60.628	60.193	60.037	59.962	59.821	
	Use	House	House	House	House	House	
	Diameter_mm	100	100	100	100	100	
	Material	PVC-U	PVC-U	PVC-U	PVC-U	PVC-U	
	Class	SN10	SN10	SN10	SN10	SN10	
	Length_m	3.517	5.658	3.368	3.356	3.424	
	Type	Jump Up	Jump Up	Ramp Riser	Ramp Riser	Ramp Riser	
	Chainage_m	0.401	81.82	72.927	65.418	57.78	
	Offset_m	3.933	4.919	2.974	2.835	2.784	
	LineNumber	5/24 - 6/24	4/24 - 5/24	4/24 - 5/24	4/24 - 5/24	4/24 - 5/24	
	DSMHID	5/24	4/24	4/24	4/24	4/24	
	IO_Distance_m	0.401	82.213	73.209	65.724	58.287	
	SO_Nearest_m	1.624	3.502	0.684	0.548	0.502	
SO_Other_m	7.385	7.567	1.438	1.426	1.367		
Sediment_Trap	false	false	false	false	false		
ComponentInfo		InfrastructureCode					
		Owner	LCC	LCC	LCC	LCC	LCC
		DrawingNumber	MIR-0803	MIR-0803	MIR-0803	MIR-0803	MIR-0803
		DrawingRevision					
		ConstructionDate	2026-03-10	2026-03-10	2026-03-10	2026-03-10	2026-03-10
		Department					
		Status	Newly Constructed	Newly Constructed	Newly Constructed	Newly Constructed	Newly Constructed
		DataQuality	APlus	APlus	APlus	APlus	APlus
		Notes	EXTENDED PROPERTY CONNECTION UNDER RETAINING WALL	EXTENDED PROPERTY CONNECTION UNDER RETAINING WALL			
	SupportingFiles						
	Surveyor	Name					
		DateFinalSurvey					
		DateApproved					
	Engineer	Name					
		DateApproved					
Geometry	X	499322.835465	499348.848629	499358.057526	499365.433722	499372.746676	
	Y	6932487.298066	6932481.282564	6932481.489215	6932480.210006	6932478.852569	

Sewerage Connection

	ADACId	3777714	3777715	3777716	3777717	3777718
	SurfaceLevel_m	61.148	61.014	61.001	59.987	59.608
	InvertLevel_m	59.736	59.599	59.302	58.603	58.231
	Use	House	House	House	House	House
	Diameter_mm	100	100	100	100	100
	Material	PVC-U	PVC-U	PVC-U	PVC-U	PVC-U
	Class	SN10	SN10	SN10	SN10	SN10
	Length_m	3.504	3.725	5.996	2.654	3.179
	Type	Ramp Riser	Ramp Riser	Jump Up	Ramp Riser	Ramp Riser
	Chainage_m	49.983	42.889	29.047	0.686	60.262
	Offset_m	2.914	3.019	4.976	2.919	2.738
	LineNumber	4/24 - 5/24	4/24 - 5/24	4/24 - 5/24	3/24 - 4/24	3/24 - 4/24
	DSMHID	4/24	4/24	4/24	4/24	3/24
	IO_Distance_m	50.673	43.21	29.564	0.686	60.662
	SO_Nearest_m	0.635	0.745	2.008	0.608	0.5
SO_Other_m	1.484	1.45	4.911	7.565	7.525	
Sediment_Trap	false	false	false	false	false	
ComponentInfo	InfrastructureCode					
	Owner	LCC	LCC	LCC	LCC	LCC
	DrawingNumber	MIR-0803	MIR-0803	MIR-0803	MIR-0803	MIR-0803
	DrawingRevision					
	ConstructionDate	2026-03-10	2026-03-10	2026-03-10	2026-03-10	2026-03-10
	Department					
	Status	Newly Constructed	Newly Constructed	Newly Constructed	Newly Constructed	Newly Constructed
	DataQuality	APlus	APlus	APlus	APlus	APlus
	Notes			EXTENDED PROPERTY CONNECTION UNDER RETAINING WALL		
	SupportingFiles					
	Surveyor	Name				
		DateFinalSurvey				
		DateApproved				
Engineer	Name					
	DateApproved					
Geometry	X	499380.198572	499387.506529	499400.536101	499429.969842	499445.735276
	Y	6932477.28522	6932475.769849	6932471.26672	6932467.751176	6932464.832387

Sewerage Connection

	ADACId	3777722	3777723	3777724	3777725	3777726
	SurfaceLevel_m	58.315	57.969	57.605	57.258	56.881
	InvertLevel_m	56.977	56.637	56.261	55.907	55.539
	Use	House	House	House	House	House
	Diameter_mm	100	100	100	100	100
	Material	PVC-U	PVC-U	PVC-U	PVC-U	PVC-U
	Class	SN10	SN10	SN10	SN10	SN10
	Length_m	3.239	2.53	3.145	3.227	3.224
	Type	Ramp Riser	Ramp Riser	Ramp Riser	Ramp Riser	Ramp Riser
	Chainage_m	12.377	0.495	65.406	52.838	40.304
	Offset_m	2.824	2.765	2.8	2.833	2.915
	LineNumber	3/24 - 4/24	EX 2/24 - 3/24	EX2/24 - 3/24	EX2/24 - 3/24	EX2/24 - 3/24
	DSMHID	3/24	3/24	EX 2/24	EX2/24	EX2/24
	IO_Distance_m	12.592	0.495	65.544	53.081	40.492
	SO_Nearest_m	0.565	0.437	0.539	0.567	0.644
	SO_Other_m	6.558	5.024	6.481	4.95	5.045
Sediment_Trap	false	false	false	false	false	
ComponentInfo	InfrastructureCode					
	Owner	LCC	LCC	LCC	LCC	LCC
	DrawingNumber	MIR-0803	MIR-0803	MIR-0803	MIR-0803	MIR-0803
	DrawingRevision					
	ConstructionDate	2026-03-10	2026-03-10	2026-03-10	2026-03-10	2026-03-10
	Department					
	Status	Newly Constructed	Newly Constructed	Newly Constructed	Newly Constructed	Newly Constructed
	DataQuality	APlus	APlus	APlus	APlus	APlus
	Notes					
	SupportingFiles					
	Surveyor	Name				
		DateFinalSurvey				
		DateApproved				
	Engineer	Name				
DateApproved						
Geometry	X	499492.929619	499505.189512	499518.871813	499531.105718	499543.454574
	Y	6932455.700177	6932453.4751	6932450.743234	6932448.364221	6932445.913238

Sewerage Connection

	ADACId	3777727	3777728	3777729	3777730	3777731
	SurfaceLevel_m	56.648	56.253	56.164	55.824	61.163
	InvertLevel_m	55.224	54.988	54.795	54.553	60.191
	Use	House	House	House	House	House
	Diameter_mm	100	100	100	100	100
	Material	PVC-U	PVC-U	PVC-U	PVC-U	PVC-U
	Class	SN10	SN10	SN10	SN10	SN10
	Length_m	3.355	3.383	3.378	3.242	3.327
	Type	Ramp Riser	Ramp Riser	Ramp Riser	Ramp Riser	Ramp Riser
	Chainage_m	31.357	17.463	14.496	2.538	63.824
	Offset_m	3.013	2.817	2.837	2.775	2.907
	LineNumber	EX2/24 - 3/24	EX2/24 - 3/24	EX2/24 - 3/24	EX2/24 - 3/24	1/29 - EX2/29
	DSMHID	2/24	2/24	EX2/24	EX2/24	1/29
	IO_Distance_m	31.618	18.031	15.026	3.109	64.036
	SO_Nearest_m	0.739	0.537	0.556	0.49	0.594
	SO_Other_m	1.423	1.482	1.523	1.549	5.066
Sediment_Trap	false	false	false	false	false	
ComponentInfo		InfrastructureCode				
		Owner	LCC	LCC	LCC	LCC
		DrawingNumber	MIR-0803	MIR-0803	MIR-0803	MIR-0803
		DrawingRevision				
		ConstructionDate	2026-03-10	2026-03-10	2026-03-10	2026-03-10
		Department				
		Status	Newly Constructed	Newly Constructed	Newly Constructed	Newly Constructed
		DataQuality	APlus	APlus	APlus	APlus
	Notes					
	SupportingFiles					
	Surveyor	Name				
		DateFinalSurvey				
		DateApproved				
	Engineer	Name				
DateApproved						
Geometry	X	499552.150952	499565.532379	499568.480151	499580.200269	499249.29108
	Y	6932444.145971	6932441.780953	6932441.195196	6932439.011102	6932442.613696

Sewerage Connection

	ADACId	3777732	3777733	3777734	3777735	3777736
	SurfaceLevel_m	61.117	60.756	60.304	59.892	59.519
	InvertLevel_m	59.699	59.359	58.932	58.507	58.015
	Use	House	House	House	House	House
	Diameter_mm	100	100	100	100	100
	Material	PVC-U	PVC-U	PVC-U	PVC-U	PVC-U
	Class	SN10	SN10	SN10	SN10	SN10
	Length_m	3.338	3.35	3.432	3.295	2.854
	Type	Ramp Riser	Ramp Riser	Ramp Riser	Ramp Riser	Ramp Riser
	Chainage_m	49.859	39.902	27.494	14.79	0.57
	Offset_m	2.927	2.915	3.005	2.91	3.057
	LineNumber	1/29 - EX2/29	1/29 - EX2/29	1/29 - EX2/29	1/29 - EX2/29	1/29 - EX2/29
	DSMHID	1/29	1/29	1/29	1/29	1/29
	IO_Distance_m	50.142	40.09	27.714	15.072	0.57
	SO_Nearest_m	0.602	0.581	0.661	0.555	0.631
	SO_Other_m	6.466	2.523	4.903	5.051	7.656
Sediment_Trap	false	false	false	false	false	
ComponentInfo		InfrastructureCode				
		Owner	LCC	LCC	LCC	LCC
		DrawingNumber	MIR-0803	MIR-0803	MIR-0803	MIR-0803
		DrawingRevision				
		ConstructionDate	2026-03-10	2026-03-10	2026-03-10	2026-03-10
		Department				
		Status	Newly Constructed	Newly Constructed	Newly Constructed	Newly Constructed
		DataQuality	APlus	APlus	APlus	APlus
	Notes					
	SupportingFiles					
	Surveyor	Name				
		DateFinalSurvey				
		DateApproved				
Engineer	Name					
	DateApproved					
Geometry	X	499262.937396	499272.804286	499284.973218	499297.369055	499312.211873
	Y	6932439.999781	6932438.083576	6932435.826513	6932433.337546	6932430.563697

Sewerage Connection

	ADACId	3777737	3777738	3777739	3777740	3777741
	SurfaceLevel_m	61.549	61.09	60.797	60.464	59.947
	InvertLevel_m	60.208	59.746	59.394	59.065	58.525
	Use	House	House	House	House	House
	Diameter_mm	100	100	100	100	100
	Material	PVC-U	PVC-U	PVC-U	PVC-U	PVC-U
	Class	SN10	SN10	SN10	SN10	SN10
	Length_m	2.107	2.836	2.72	2.604	2.712
	Type	Ramp Riser	Ramp Riser	Ramp Riser	Ramp Riser	Ramp Riser
	Chainage_m	0.592	55.06	44.91	34.969	20.969
	Offset_m	2.369	2.479	2.339	2.212	2.316
	LineNumber	HB1/28 - 2/28	HB1/28 - 2/28	HB1/28 - 2/28	HB1/28 - 2/28	HB1/28 - 2/28
	DSMHID	2/28	1/28	1/28	1/28	1/28
	IO_Distance_m	0.592	55.458	45.357	35.425	21.42
	SO_Nearest_m	0.537	0.732	0.588	0.457	0.556
SO_Other_m	7.51	6.434	2.542	2.482	6.5	
Sediment_Trap	false	false	false	false	false	
ComponentInfo		InfrastructureCode				
		Owner	LCC	LCC	LCC	LCC
		DrawingNumber	MIR-0803	MIR-0803	MIR-0803	MIR-0803
		DrawingRevision				
		ConstructionDate	2026-03-10	2026-03-10	2026-03-10	2026-03-10
		Department				
		Status	Newly Constructed	Newly Constructed	Newly Constructed	Newly Constructed
		DataQuality	APlus	APlus	APlus	APlus
		Notes				
	SupportingFiles					
	Surveyor	Name				
		DateFinalSurvey				
		DateApproved				
Engineer	Name					
	DateApproved					
Geometry	X	499245.976455	499259.633767	499269.581624	499279.363549	499293.106825
	Y	6932426.321482	6932423.499654	6932421.735386	6932419.98911	6932417.248247

Sewerage Connection

	ADACId	3777742	3777743	3777744	3777745	3777746
	SurfaceLevel_m	59.447	59.187	58.815	58.243	57.604
	InvertLevel_m	58.065	57.807	57.432	56.895	56.257
	Use	House	House	House	House	House
	Diameter_mm	100	100	100	100	100
	Material	PVC-U	PVC-U	PVC-U	PVC-U	PVC-U
	Class	SN10	SN10	SN10	SN10	SN10
	Length_m	2.753	2.603	3.568	3.683	3.962
	Type	Ramp Riser	Ramp Riser	Ramp Riser	Ramp Riser	Ramp Riser
	Chainage_m	3.883	0.586	47.466	33.581	19.088
	Offset_m	2.339	2.925	2.805	2.878	2.885
	LineNumber	HB1/28 - 2/28	EX5/23 - 6/23	EX5/23 - 6/23	EX5/23 - 6/23	EX5/23 - 6/23
	DSMHID	1/28	6/23	5/23	5/23	5/23
	IO_Distance_m	3.883	0.586	48.073	34.111	20.085
	SO_Nearest_m	0.574	0.551	0.541	0.612	0.615
	SO_Other_m	7.423	6.599	4.987	6.453	6.486
Sediment_Trap	false	false	false	false	false	
ComponentInfo		InfrastructureCode				
		Owner	LCC	LCC	LCC	LCC
		DrawingNumber	MIR-0803	MIR-0803	MIR-0803	MIR-0803
		DrawingRevision				
		ConstructionDate	2026-03-10	2026-03-10	2026-03-10	2026-03-10
		Department				
		Status	Newly Constructed	Newly Constructed	Newly Constructed	Newly Constructed
		DataQuality	APlus	APlus	APlus	APlus
	Notes					
	SupportingFiles					
	Surveyor	Name				
		DateFinalSurvey				
		DateApproved				
	Engineer	Name				
DateApproved						
Geometry	X	499307.752725	499397.562858	499395.236295	499392.533417	499389.883517
	Y	6932414.416423	6932439.376538	6932427.215067	6932413.517773	6932399.74351

Sewerage Connection

	ADACId	3777747	3777748	3777749	3777750	3777751
	SurfaceLevel_m	57.162	57.532	57.171	56.744	56.512
	InvertLevel_m	55.756	56.127	55.721	55.356	55.091
	Use	House	House	House	House	House
	Diameter_mm	100	100	100	100	100
	Material	PVC-U	PVC-U	PVC-U	PVC-U	PVC-U
	Class	SN10	SN10	SN10	SN10	SN10
	Length_m	3.619	2.807	3.297	3.424	3.512
	Type	Ramp Riser	Ramp Riser	Ramp Riser	Ramp Riser	Ramp Riser
	Chainage_m	9.446	0.81	86.446	72.512	62.465
	Offset_m	2.907	3.076	2.741	2.911	2.909
	LineNumber	EX5/23 - 6/23	1/22 - 2/22	1/22 - 2/22	1/22 - 2/22	1/22 - 2/22
	DSMHID	5/23	2/22	1/22	1/22	1/22
	IO_Distance_m	10.04	0.81	87.029	72.976	63
	SO_Nearest_m	0.635	0.663	0.419	0.58	0.571
	SO_Other_m	2.537	7.408	7.527	6.526	2.507
Sediment_Trap	false	false	false	false	false	
ComponentInfo		InfrastructureCode				
		Owner	LCC	LCC	LCC	LCC
		DrawingNumber	MIR-0803	MIR-0803	MIR-0803	MIR-0803
		DrawingRevision				
		ConstructionDate	2026-03-10	2026-03-10	2026-03-10	2026-03-10
		Department				
		Status	Newly Constructed	Newly Constructed	Newly Constructed	Newly Constructed
		DataQuality	APlus	APlus	APlus	APlus
	Notes					
	SupportingFiles					
	Surveyor	Name				
		DateFinalSurvey				
DateApproved						
Engineer	Name					
	DateApproved					
Geometry	X	499387.969359	499419.049373	499434.591932	499448.423135	499458.218059
	Y	6932389.882647	6932410.0722	6932406.837584	6932404.344164	6932402.454103

Sewerage Connection

	ADACId	3777752	3777753	3777754	3777755	3777756
	SurfaceLevel_m	56.257	55.882	55.561	55.269	54.965
	InvertLevel_m	54.812	54.457	54.097	53.816	53.463
	Use	House	House	House	House	House
	Diameter_mm	100	100	100	100	100
	Material	PVC-U	PVC-U	PVC-U	PVC-U	PVC-U
	Class	SN10	SN10	SN10	SN10	SN10
	Length_m	3.746	3.753	3.733	3.914	2.973
	Type	Ramp Riser	Ramp Riser	Ramp Riser	Ramp Riser	Ramp Riser
	Chainage_m	52.217	38.247	24.174	14.255	0.382
	Offset_m	2.903	2.877	2.873	3.047	3.109
	LineNumber	1/22 - 2/22	1/22 - 2/22	1/22 - 2/22	1/22 - 2/22	1/22 - 2/22
	DSMHID	1/22	1/22	1/22	1/22	1/22
	IO_Distance_m	53.035	39.009	25.016	14.966	0.382
	SO_Nearest_m	0.558	0.523	0.51	0.677	0.713
	SO_Other_m	2.476	6.507	6.506	2.561	7.469
Sediment_Trap	false	false	false	false	false	
ComponentInfo	InfrastructureCode					
	Owner	LCC	LCC	LCC	LCC	LCC
	DrawingNumber	MIR-0803	MIR-0803	MIR-0803	MIR-0803	MIR-0803
	DrawingRevision					
	ConstructionDate	2026-03-10	2026-03-10	2026-03-10	2026-03-10	2026-03-10
	Department					
	Status	Newly Constructed	Newly Constructed	Newly Constructed	Newly Constructed	Newly Constructed
	DataQuality	APlus	APlus	APlus	APlus	APlus
	Notes					
	SupportingFiles					
	Surveyor	Name				
		DateFinalSurvey				
		DateApproved				
Engineer	Name					
	DateApproved					
Geometry	X	499468.001424	499481.76925	499495.508527	499505.409403	499520.052305
	Y	6932400.561332	6932397.880259	6932395.22736	6932393.496078	6932390.719231

Sewerage Connection

	ADACId	3777757	3777758	3777759	3777760	3777761
	SurfaceLevel_m	54.69	54.738	54.253	53.62	57.586
	InvertLevel_m	53.417	53.308	52.822	52.462	56.239
	Use	House	House	House	House	House
	Diameter_mm	100	100	100	100	100
	Material	PVC-U	PVC-U	PVC-U	PVC-U	PVC-U
	Class	SN10	SN10	SN10	SN10	SN10
	Length_m	2.116	3.263	3.418	3.591	2.221
	Type	Ramp Riser	Ramp Riser	Ramp Riser	Ramp Riser	Ramp Riser
	Chainage_m	0.753	32.558	19.525	9.606	0.518
	Offset_m	3.268	2.919	2.838	2.935	2.353
	LineNumber	EX1/21 - 2/21	EX1/21 - 2/21	EX1/21 - 2/21	EX1/21 - 2/21	7/4 - 8/4
	DSMHID	2/21	1/21	1/21	1/21	8/4
	IO_Distance_m	0.753	32.643	20.108	10.142	0.518
	SO_Nearest_m	0.634	0.573	0.504	0.611	0.569
	SO_Other_m	7.713	5.002	5.042	2.513	7.563
Sediment_Trap	false	false	false	false	false	
ComponentInfo		InfrastructureCode				
		Owner	LCC	LCC	LCC	LCC
		DrawingNumber	MIR-0803	MIR-0803	MIR-0803	MIR-0803
		DrawingRevision				
		ConstructionDate	2026-03-10	2026-03-10	2026-03-10	2026-03-10
		Department				
		Status	Newly Constructed	Newly Constructed	Newly Constructed	Newly Constructed
		DataQuality	APlus	APlus	APlus	APlus
	Notes					
	SupportingFiles					
	Surveyor	Name				
		DateFinalSurvey				
		DateApproved				
	Engineer	Name				
DateApproved						
Geometry	X	499540.690909	499543.922364	499544.704035	499545.486706	499412.796973
	Y	6932396.259628	6932390.830178	6932378.319388	6932368.383525	6932394.241794

Sewerage Connection

	ADACId	3777762	3777763	3777764	3777765	3777766	
	SurfaceLevel_m	57.226	56.889	56.445	56.195	55.813	
	InvertLevel_m	55.882	55.563	55.117	54.796	54.445	
	Use	House	House	House	House	House	
	Diameter_mm	100	100	100	100	100	
	Material	PVC-U	PVC-U	PVC-U	PVC-U	PVC-U	
	Class	SN10	SN10	SN10	SN10	SN10	
	Length_m	2.998	2.884	2.826	2.972	3.3	
	Type	Ramp Riser	Ramp Riser	Ramp Riser	Ramp Riser	Ramp Riser	
	Chainage_m	91.428	79.02	63.135	50.679	36.323	
	Offset_m	2.315	2.257	2.256	2.237	2.263	
	LineNumber	7/4 - 8/4	7/4 - 8/4	7/4 - 8/4	7/4 - 8/4	7/4 - 8/4	
	DSMHID	7/4	7/4	7/4	7/4	7/4	
	IO_Distance_m	92.146	79.72	63.72	51.26	37.335	
	SO_Nearest_m	0.603	0.54	0.534	0.509	0.531	
SO_Other_m	6.551	4.982	7.506	4.954	6.385		
Sediment_Trap	false	false	false	false	false		
ComponentInfo		InfrastructureCode					
		Owner	LCC	LCC	LCC	LCC	LCC
		DrawingNumber	MIR-0803	MIR-0803	MIR-0803	MIR-0803	MIR-0803
		DrawingRevision					
		ConstructionDate	2026-03-10	2026-03-10	2026-03-10	2026-03-10	2026-03-10
		Department					
		Status	Newly Constructed	Newly Constructed	Newly Constructed	Newly Constructed	Newly Constructed
		DataQuality	APlus	APlus	APlus	APlus	APlus
		Notes					
	SupportingFiles						
	Surveyor	Name					
		DateFinalSurvey					
		DateApproved					
Engineer	Name						
	DateApproved						
Geometry	X	499426.650455	499438.865013	499454.578368	499466.81948	499480.490777	
	Y	6932391.545634	6932389.263425	6932386.251069	6932383.924174	6932381.276175	

Sewerage Connection

	ADACId	3777767	3777768	3777769	3777770	3777771	
	SurfaceLevel_m	55.445	53.77	60.651	60.234	59.743	
	InvertLevel_m	54.109	52.394	59.178	58.785	58.347	
	Use	House	House	House	House	House	
	Diameter_mm	100	100	100	100	100	
	Material	PVC-U	PVC-U	PVC-U	PVC-U	PVC-U	
	Class	SN10	SN10	SN10	SN10	SN10	
	Length_m	3.66	2.656	2.65	3.415	3.135	
	Type	Ramp Riser	Ramp Riser	Ramp Riser	Ramp Riser	Ramp Riser	
	Chainage_m	23.358	12.274	0.78	28.113	14.014	
	Offset_m	2.482	2.281	2.885	2.993	2.717	
	LineNumber	7/4 - 8/4	HB5/4 - EX6/4	3/27 - 4/27	3/27 - 4/27	3/27 - 4/27	
	DSMHID	7/4	6/4	4/27	3/27	3/27	
	IO_Distance_m	24.4	12.497	0.78	28.293	14.278	
	SO_Nearest_m	0.744	0.682	0.428	0.655	0.388	
SO_Other_m	5.325	7.421	6.443	4.937	6.457		
Sediment_Trap	false	false	false	false	false		
ComponentInfo	InfrastructureCode						
	Owner	LCC	LCC	LCC	LCC	LCC	
	DrawingNumber	MIR-0803	MIR-0803	MIR-0803	MIR-0803	MIR-0803	
	DrawingRevision						
	ConstructionDate	2026-03-10	2026-03-10	2026-03-10	2026-03-10	2026-03-10	
	Department						
	Status	Newly Constructed	Newly Constructed	Newly Constructed	Newly Constructed	Newly Constructed	
	DataQuality	APlus	APlus	APlus	APlus	APlus	
	Notes						
	SupportingFiles						
	Surveyor	Name					
		DateFinalSurvey					
DateApproved							
Engineer	Name						
	DateApproved						
Geometry	X	499493.152917	499528.912607	499339.655449	499337.522334	499334.61654	
	Y	6932378.625952	6932364.690068	6932450.65932	6932438.353445	6932424.640157	

Sewerage Connection

	ADACId	3777772	3777773	3777774	3777775	3777721	
	SurfaceLevel_m	59.143	58.616	63.327	63.995	58.666	
	InvertLevel_m	57.769	57.272	61.987	62.577	57.32	
	Use	House	House	House	House	House	
	Diameter_mm	100	100	100	100	100	
	Material	PVC-U	PVC-U	PVC-U	PVC-U	PVC-U	
	Class	SN10	SN10	SN10	SN10	SN10	
	Length_m	2.569	3.355	4.45	2.895	3.409	
	Type	Ramp Riser	Ramp Riser	Jump Up	Ramp Riser	Ramp Riser	
	Chainage_m	0.942	9.781	11.81	0.916	26.513	
	Offset_m	3.164	2.832	2.944	3.117	2.932	
	LineNumber	3/27 - 4/27	EX2/27 - 3/27	HB2/24 - 6/24	7/24 - 8/24	3/24 - 4/24	
	DSMHID	3/27	2/27	6/24	8/24	3/24	
	IO_Distance_m	0.942	10.033	12.381	0.916	26.681	
	SO_Nearest_m	0.743	0.534	0.648	0.596	0.679	
SO_Other_m	7.4	2.474	7.43	5.471	2.466		
Sediment_Trap	false	false	false	false	false		
ComponentInfo		InfrastructureCode					
		Owner	LCC	LCC	LCC	LCC	LCC
		DrawingNumber	MIR-0803	MIR-0803	MIR-0803	MIR-0803	MIR-0803
		DrawingRevision					
		ConstructionDate	2026-03-10	2026-03-10	2026-03-10	2026-03-10	2026-03-10
		Department					
		Status	Newly Constructed	Newly Constructed	Newly Constructed	Newly Constructed	Newly Constructed
		DataQuality	APlus	APlus	APlus	APlus	APlus
		Notes					
	SupportingFiles						
	Surveyor	Name					
		DateFinalSurvey					
		DateApproved					
Engineer	Name						
	DateApproved						
Geometry	X	499332.298677	499330.230593	499223.558815	499164.181535	499479.07239	
	Y	6932410.695486	6932401.038381	6932507.363738	6932478.612729	6932458.24612	

Sewerage Connection

	ADACId	3777720	3777719		
	SurfaceLevel_m	58.959	59.197		
	InvertLevel_m	57.736	57.989		
	Use	House	House		
	Diameter_mm	100	100		
	Material	PVC-U	PVC-U		
	Class	SN10	SN10		
	Length_m	3.319	3.337		
	Type	Ramp Riser	Ramp Riser		
	Chainage_m	36.253	46.236		
	Offset_m	2.753	2.743		
	LineNumber	3/24 - 4/24	3/24 - 4/24		
	DSMHID	3/24	3/24		
	IO_Distance_m	36.578	46.678		
	SO_Nearest_m	0.505	0.499		
SO_Other_m	2.564	6.458			
Sediment_Trap	false	false			
ComponentInfo		InfrastructureCode			
		Owner	LCC	LCC	
		DrawingNumber	MIR-0803	MIR-0803	
		DrawingRevision			
		ConstructionDate	2026-03-10	2026-03-10	
		Department			
		Status	Newly Constructed	Newly Constructed	
		DataQuality	APlus	APlus	
		Notes			
		SupportingFiles			
	Surveyor	Name			
		DateFinalSurvey			
		DateApproved			
Engineer	Name				
	DateApproved				
Geometry	X	499469.385425	499459.467556		
	Y	6932460.284274	6932462.195481		

Cadastre Land Parcel Lot

		ADACId	3777610	3777611	3777612	3777613	3777614
		LotNo	4199	4200	4201	4202	4203
		PlanNo	SP353603	SP353603	SP353603	SP353603	SP353603
		CancelledLotPlan	9003 on SP344892	9003 on SP344892	9003 on SP344892	9003 on SP344892	9003 on SP344892
		TitledArea_sqm	530	419	479	512	710
ComponentInfo		InfrastructureCode					
		Owner	LCC	LCC	LCC	LCC	LCC
		DrawingNumber	MIR-0803	MIR-0803	MIR-0803	MIR-0803	MIR-0803
		DrawingRevision					
		ConstructionDate	2026-02-16	2026-02-16	2026-02-16	2026-02-16	2026-02-16
		Department					
		Status	Newly Constructed	Newly Constructed	Newly Constructed	Newly Constructed	Newly Constructed
		DataQuality	APlus	APlus	APlus	APlus	APlus
		Notes					
		SupportingFiles					
	Surveyor	Name					
		DateFinalSurvey					
		DateApproved					
	Engineer	Name					
		DateApproved					
Geometry		X	499159.756696	499170.041205	499181.794931	499200.561684	499230.977957
		Y	6932475.340748	6932484.83105	6932495.677109	6932510.797349	6932506.59848

Cadastre Land Parcel Lot

		ADACId	3777615	3777616	3777617	3777618	3777619
		LotNo	4204	4205	4206	4207	4208
		PlanNo	SP353603	SP353603	SP353603	SP353603	SP353603
		CancelledLotPlan	9003 on SP344892	9003 on SP344892	9003 on SP344892	9003 on SP344892	9003 on SP344892
		TitledArea_sqm	374	374	374	419	299
ComponentInfo		InfrastructureCode					
		Owner	LCC	LCC	LCC	LCC	LCC
		DrawingNumber	MIR-0803	MIR-0803	MIR-0803	MIR-0803	MIR-0803
		DrawingRevision					
		ConstructionDate	2026-02-16	2026-02-16	2026-02-16	2026-02-16	2026-02-16
		Department					
		Status	Newly Constructed	Newly Constructed	Newly Constructed	Newly Constructed	Newly Constructed
		DataQuality	APlus	APlus	APlus	APlus	APlus
		Notes					
		SupportingFiles					
	Surveyor	Name					
		DateFinalSurvey					
		DateApproved					
	Engineer	Name					
DateApproved							
Geometry	X	499243.248386	499255.518814	499267.789243	499281.532123	499291.348466	
	Y	6932504.241234	6932501.883988	6932499.526743	6932496.886628	6932495.000831	

Cadastre Land Parcel Lot

		ADACId	3777620	3777621	3777622	3777623	3777624
		LotNo	4209	4210	4211	4198	4197
		PlanNo	SP353603	SP353603	SP353603	SP353603	SP353603
		CancelledLotPlan	9003 on SP344892	9003 on SP344892	9003 on SP344892	9003 on SP344892	9003 on SP344892
		TitledArea_sqm	374	374	437	530	419
ComponentInfo		InfrastructureCode					
		Owner	LCC	LCC	LCC	LCC	LCC
		DrawingNumber	MIR-0803	MIR-0803	MIR-0803	MIR-0803	MIR-0803
		DrawingRevision					
		ConstructionDate	2026-02-16	2026-02-16	2026-02-16	2026-02-16	2026-02-16
		Department					
		Status	Newly Constructed	Newly Constructed	Newly Constructed	Newly Constructed	Newly Constructed
		DataQuality	APlus	APlus	APlus	APlus	APlus
		Notes					
		SupportingFiles					
	Surveyor	Name					
		DateFinalSurvey					
		DateApproved					
	Engineer	Name					
		DateApproved					
Geometry		X	499303.618895	499315.889324	499329.384197	499180.093056	499190.377566
		Y	6932492.643586	6932490.28634	6932481.586698	6932453.302513	6932462.792815

Cadastre Land Parcel Lot

		ADACId	3777625	3777626	3777627	3777628	3777629
		LotNo	4196	4195	4194	4193	4192
		PlanNo	SP353603	SP353603	SP353603	SP353603	SP353603
		CancelledLotPlan	9003 on SP344892	9003 on SP344892	9003 on SP344892	9003 on SP344892	9003 on SP344892
		TitledArea_sqm	544	637	374	374	419
ComponentInfo		InfrastructureCode					
		Owner	LCC	LCC	LCC	LCC	LCC
		DrawingNumber	MIR-0803	MIR-0803	MIR-0803	MIR-0803	MIR-0803
		DrawingRevision					
		ConstructionDate	2026-02-16	2026-02-16	2026-02-16	2026-02-16	2026-02-16
		Department					
		Status	Newly Constructed	Newly Constructed	Newly Constructed	Newly Constructed	Newly Constructed
		DataQuality	APlus	APlus	APlus	APlus	APlus
		Notes					
		SupportingFiles					
	Surveyor	Name					
		DateFinalSurvey					
		DateApproved					
	Engineer	Name					
DateApproved							
Geometry	X	499209.275907	499237.590996	499249.861425	499262.131854	499275.874734	
	Y	6932480.231756	6932474.792205	6932472.43496	6932470.077714	6932467.437599	

Cadastre Land Parcel Lot

		ADACId	3777630	3777631	3777632	3777633	3777634
		LotNo	4191	4190	4189	4188	4182
		PlanNo	SP353603	SP353603	SP353603	SP353603	SP353603
		CancelledLotPlan	9003 on SP344892	9003 on SP344892	9003 on SP344892	9003 on SP344892	9003 on SP344892
		TitledArea_sqm	299	374	374	437	855
ComponentInfo		InfrastructureCode					
		Owner	LCC	LCC	LCC	LCC	LCC
		DrawingNumber	MIR-0803	MIR-0803	MIR-0803	MIR-0803	MIR-0803
		DrawingRevision					
		ConstructionDate	2026-02-16	2026-02-16	2026-02-16	2026-02-16	2026-02-16
		Department					
		Status	Newly Constructed	Newly Constructed	Newly Constructed	Newly Constructed	Newly Constructed
		DataQuality	APlus	APlus	APlus	APlus	APlus
		Notes					
		SupportingFiles					
	Surveyor	Name					
		DateFinalSurvey					
		DateApproved					
	Engineer	Name					
DateApproved							
Geometry	X	499285.691077	499297.961505	499310.231934	499324.858285	499253.453316	
	Y	6932465.551802	6932463.194557	6932460.837311	6932458.027475	6932425.432211	

Cadastre Land Parcel Lot

		ADACId	3777635	3777636	3777637	3777638	3777639
		LotNo	4183	4184	4185	4186	4187
		PlanNo	SP353603	SP353603	SP353603	SP353603	SP353603
		CancelledLotPlan	9003 on SP344892	9003 on SP344892	9003 on SP344892	9003 on SP344892	9003 on SP344892
		TitledArea_sqm	419	299	299	419	470
ComponentInfo		InfrastructureCode					
		Owner	LCC	LCC	LCC	LCC	LCC
		DrawingNumber	MIR-0803	MIR-0803	MIR-0803	MIR-0803	MIR-0803
		DrawingRevision					
		ConstructionDate	2026-02-16	2026-02-16	2026-02-16	2026-02-16	2026-02-16
		Department					
		Status	Newly Constructed	Newly Constructed	Newly Constructed	Newly Constructed	Newly Constructed
		DataQuality	APlus	APlus	APlus	APlus	APlus
		Notes					
		SupportingFiles					
	Surveyor	Name					
		DateFinalSurvey					
		DateApproved					
	Engineer	Name					
DateApproved							
Geometry		X	499267.196196	499277.012539	499286.828882	499300.571763	499315.146433
		Y	6932422.792096	6932420.9063	6932419.020503	6932416.380388	6932407.473308

Cadastre Land Parcel Lot

		ADACId	3777640	3777641	3777642	3777643	3777644
		LotNo	4224	4223	4222	4221	4220
		PlanNo	SP353603	SP353603	SP353603	SP353603	SP353603
		CancelledLotPlan	9003 on SP344892	9003 on SP344892	9003 on SP344892	9003 on SP344892	9003 on SP344892
		TitledArea_sqm	299	299	419	419	374
ComponentInfo		InfrastructureCode					
		Owner	LCC	LCC	LCC	LCC	LCC
		DrawingNumber	MIR-0803	MIR-0803	MIR-0803	MIR-0803	MIR-0803
		DrawingRevision					
		ConstructionDate	2026-02-16	2026-02-16	2026-02-16	2026-02-16	2026-02-16
		Department					
		Status	Newly Constructed	Newly Constructed	Newly Constructed	Newly Constructed	Newly Constructed
		DataQuality	APlus	APlus	APlus	APlus	APlus
		Notes					
		SupportingFiles					
	Surveyor	Name					
		DateFinalSurvey					
		DateApproved					
	Engineer	Name					
		DateApproved					
Geometry		X	499357.736418	499359.622214	499362.262329	499364.902444	499367.25969
		Y	6932388.094957	6932397.9113	6932411.65418	6932425.39706	6932437.667489

Cadastre Land Parcel Lot

		ADACId	3777645	3777646	3777647	3777648	3777649
		LotNo	4219	4212	4213	4214	4215
		PlanNo	SP353603	SP353603	SP353603	SP353603	SP353603
		CancelledLotPlan	9003 on SP344892	9003 on SP344892	9003 on SP344892	9003 on SP344892	9003 on SP344892
		TitledArea_sqm	419	305	209	209	209
ComponentInfo		InfrastructureCode					
		Owner	LCC	LCC	LCC	LCC	LCC
		DrawingNumber	MIR-0803	MIR-0803	MIR-0803	MIR-0803	MIR-0803
		DrawingRevision					
		ConstructionDate	2026-02-16	2026-02-16	2026-02-16	2026-02-16	2026-02-16
		Department					
		Status	Newly Constructed	Newly Constructed	Newly Constructed	Newly Constructed	Newly Constructed
		DataQuality	APlus	APlus	APlus	APlus	APlus
		Notes					
		SupportingFiles					
	Surveyor	Name					
		DateFinalSurvey					
		DateApproved					
	Engineer	Name					
		DateApproved					
Geometry	X	499369.899805	499356.774392	499364.136649	499371.498906	499378.861164	
	Y	6932451.410369	6932482.431998	6932481.017651	6932479.603303	6932478.188956	

Cadastre Land Parcel Lot

		ADACId	3777650	3777651	3777652	3777653	3777654
		LotNo	4216	4217	4218	4234	4233
		PlanNo	SP353603	SP353603	SP353603	SP353603	SP353603
		CancelledLotPlan	9003 on SP344892	9003 on SP344892	9003 on SP344892	9003 on SP344892	9003 on SP344892
		TitledArea_sqm	209	209	305	419	374
ComponentInfo		InfrastructureCode					
		Owner	LCC	LCC	LCC	LCC	LCC
		DrawingNumber	MIR-0803	MIR-0803	MIR-0803	MIR-0803	MIR-0803
		DrawingRevision					
		ConstructionDate	2026-02-16	2026-02-16	2026-02-16	2026-02-16	2026-02-16
		Department					
		Status	Newly Constructed	Newly Constructed	Newly Constructed	Newly Constructed	Newly Constructed
		DataQuality	APlus	APlus	APlus	APlus	APlus
		Notes					
		SupportingFiles					
	Surveyor	Name					
		DateFinalSurvey					
		DateApproved					
	Engineer	Name					
		DateApproved					
Geometry		X	499386.223421	499393.585678	499403.497586	499399.348834	499396.708719
		Y	6932476.774609	6932475.360261	6932467.348934	6932445.75298	6932432.0101

Cadastre Land Parcel Lot

		ADACId	3777655	3777656	3777657	3777658	3777659
		LotNo	4232	4231	4230	4229	4235
		PlanNo	SP353603	SP353603	SP353603	SP353603	SP353603
		CancelledLotPlan	9003 on SP344892	9003 on SP344892	9003 on SP344892	9003 on SP344892	9003 on SP344892
		TitledArea_sqm	419	419	299	299	530
ComponentInfo		InfrastructureCode					
		Owner	LCC	LCC	LCC	LCC	LCC
		DrawingNumber	MIR-0803	MIR-0803	MIR-0803	MIR-0803	MIR-0803
		DrawingRevision					
		ConstructionDate	2026-02-16	2026-02-16	2026-02-16	2026-02-16	2026-02-16
		Department					
		Status	Newly Constructed	Newly Constructed	Newly Constructed	Newly Constructed	Newly Constructed
		DataQuality	APlus	APlus	APlus	APlus	APlus
		Notes					
		SupportingFiles					
	Surveyor	Name					
		DateFinalSurvey					
		DateApproved					
	Engineer	Name					
		DateApproved					
Geometry		X	499394.351473	499391.711358	499389.071243	499387.185447	499437.513813
		Y	6932419.739671	6932405.996791	6932392.253911	6932382.437568	6932466.921322

Cadastre Land Parcel Lot

		ADACId	3777660	3777661	3777662	3777663	3777664
		LotNo	4236	4237	4238	4239	4240
		PlanNo	SP353603	SP353603	SP353603	SP353603	SP353603
		CancelledLotPlan	9003 on SP344892	9003 on SP344892	9003 on SP344892	9003 on SP344892	9003 on SP344892
		TitledArea_sqm	479	419	299	299	419
ComponentInfo		InfrastructureCode					
		Owner	LCC	LCC	LCC	LCC	LCC
		DrawingNumber	MIR-0803	MIR-0803	MIR-0803	MIR-0803	MIR-0803
		DrawingRevision					
		ConstructionDate	2026-02-16	2026-02-16	2026-02-16	2026-02-16	2026-02-16
		Department					
		Status	Newly Constructed	Newly Constructed	Newly Constructed	Newly Constructed	Newly Constructed
		DataQuality	APlus	APlus	APlus	APlus	APlus
		Notes					
		SupportingFiles					
	Surveyor	Name					
		DateFinalSurvey					
		DateApproved					
	Engineer	Name					
DateApproved							
Geometry	X	499453.219961	499466.962842	499476.779185	499486.595528	499500.338408	
	Y	6932463.904048	6932461.263933	6932459.378136	6932457.49234	6932454.852225	

Cadastre Land Parcel Lot

		ADACId	3777665	3777666	3777667	3777668	3777669
		LotNo	4241	4493	4494	4495	4496
		PlanNo	SP353603	SP353603	SP353603	SP353603	SP353603
		CancelledLotPlan	9003 on SP344892	9003 on SP344892	9003 on SP344892	9003 on SP344892	9003 on SP344892
		TitledArea_sqm	374	419	374	374	269
ComponentInfo		InfrastructureCode					
		Owner	LCC	LCC	LCC	LCC	LCC
		DrawingNumber	MIR-0803	MIR-0803	MIR-0803	MIR-0803	MIR-0803
		DrawingRevision					
		ConstructionDate	2026-02-16	2026-02-16	2026-02-16	2026-02-16	2026-02-16
		Department					
		Status	Newly Constructed	Newly Constructed	Newly Constructed	Newly Constructed	Newly Constructed
		DataQuality	APlus	APlus	APlus	APlus	APlus
		Notes					
		SupportingFiles					
	Surveyor	Name					
		DateFinalSurvey					
		DateApproved					
	Engineer	Name					
DateApproved							
Geometry		X	499512.608836	499526.351716	499538.622145	499550.892574	499559.727283
		Y	6932452.494979	6932449.854864	6932447.497618	6932445.140373	6932443.443156

Cadastre Land Parcel Lot

		ADACId	3777670	3777671	3777672	3777673	3777674
		LotNo	4497	4498	4499	4500	4501
		PlanNo	SP353603	SP353603	SP353603	SP353603	SP353603
		CancelledLotPlan	9003 on SP344892	9003 on SP344892	9003 on SP344892	9003 on SP344892	9003 on SP344892
		TitledArea_sqm	224	224	224	224	453
ComponentInfo		InfrastructureCode					
		Owner	LCC	LCC	LCC	LCC	LCC
		DrawingNumber	MIR-0803	MIR-0803	MIR-0803	MIR-0803	MIR-0803
		DrawingRevision					
		ConstructionDate	2026-02-16	2026-02-16	2026-02-16	2026-02-16	2026-02-16
		Department					
		Status	Newly Constructed	Newly Constructed	Newly Constructed	Newly Constructed	Newly Constructed
		DataQuality	APlus	APlus	APlus	APlus	APlus
		Notes					
		SupportingFiles					
	Surveyor	Name					
		DateFinalSurvey					
		DateApproved					
	Engineer	Name					
DateApproved							
Geometry		X	499567.08954	499574.451797	499581.814054	499589.176311	499600.82314
		Y	6932442.028809	6932440.614461	6932439.200114	6932437.785767	6932429.642774

Cadastre Land Parcel Lot

		ADACId	3777675	3777676	3777677	3777678	3777679
		LotNo	4492	4491	4490	4489	4488
		PlanNo	SP353603	SP353603	SP353603	SP353603	SP353603
		CancelledLotPlan	9003 on SP344892	9003 on SP344892	9003 on SP344892	9003 on SP344892	9003 on SP344892
		TitledArea_sqm	716	374	374	299	299
ComponentInfo		InfrastructureCode					
		Owner	LCC	LCC	LCC	LCC	LCC
		DrawingNumber	MIR-0803	MIR-0803	MIR-0803	MIR-0803	MIR-0803
		DrawingRevision					
		ConstructionDate	2026-02-16	2026-02-16	2026-02-16	2026-02-16	2026-02-16
		Department					
		Status	Newly Constructed	Newly Constructed	Newly Constructed	Newly Constructed	Newly Constructed
		DataQuality	APlus	APlus	APlus	APlus	APlus
		Notes					
		SupportingFiles					
	Surveyor	Name					
		DateFinalSurvey					
		DateApproved					
	Engineer	Name					
DateApproved							
Geometry	X	499572.065261	499572.930114	499573.777588	499574.625062	499575.303042	
	Y	6932410.537076	6932397.815419	6932385.349392	6932372.883366	6932362.910545	

Cadastre Land Parcel Lot

		ADACId	3777680	3777681	3777682	3777683	3777684
		LotNo	4266	4265	4255	4254	4253
		PlanNo	SP353603	SP353603	SP353603	SP353603	SP353603
		CancelledLotPlan	9003 on SP344892	9003 on SP344892	9003 on SP344892	9003 on SP344892	9003 on SP344892
		TitledArea_sqm	349	520	502	419	374
ComponentInfo		InfrastructureCode					
		Owner	LCC	LCC	LCC	LCC	LCC
		DrawingNumber	MIR-0803	MIR-0803	MIR-0803	MIR-0803	MIR-0803
		DrawingRevision					
		ConstructionDate	2026-02-16	2026-02-16	2026-02-16	2026-02-16	2026-02-16
		Department					
		Status	Newly Constructed	Newly Constructed	Newly Constructed	Newly Constructed	Newly Constructed
		DataQuality	APlus	APlus	APlus	APlus	APlus
		Notes					
		SupportingFiles					
	Surveyor	Name					
		DateFinalSurvey					
		DateApproved					
	Engineer	Name					
		DateApproved					
Geometry	X	499530.0962	499528.517117	499500.641932	499488.063913	499474.321033	
	Y	6932357.332533	6932369.742631	6932377.94534	6932380.361676	6932383.001791	

Cadastre Land Parcel Lot

		ADACId	3777685	3777686	3777687	3777688	3777689
		LotNo	4252	4251	4250	4249	4248
		PlanNo	SP353603	SP353603	SP353603	SP353603	SP353603
		CancelledLotPlan	9003 on SP344892	9003 on SP344892	9003 on SP344892	9003 on SP344892	9003 on SP344892
		TitledArea_sqm	479	374	419	440	530
ComponentInfo		InfrastructureCode					
		Owner	LCC	LCC	LCC	LCC	LCC
		DrawingNumber	MIR-0803	MIR-0803	MIR-0803	MIR-0803	MIR-0803
		DrawingRevision					
		ConstructionDate	2026-02-16	2026-02-16	2026-02-16	2026-02-16	2026-02-16
		Department					
		Status	Newly Constructed	Newly Constructed	Newly Constructed	Newly Constructed	Newly Constructed
		DataQuality	APlus	APlus	APlus	APlus	APlus
		Notes					
		SupportingFiles					
	Surveyor	Name					
		DateFinalSurvey					
		DateApproved					
	Engineer	Name					
DateApproved							
Geometry		X	499462.050604	499446.344455	499434.074027	499420.331147	499431.856423
		Y	6932385.359037	6932388.376311	6932390.733557	6932393.373672	6932437.472293

Cadastre Land Parcel Lot

		ADACId	3777690	3777691	3777692	3777693	3777694
		LotNo	4247	4246	4245	4244	4243
		PlanNo	SP353603	SP353603	SP353603	SP353603	SP353603
		CancelledLotPlan	9003 on SP344892	9003 on SP344892	9003 on SP344892	9003 on SP344892	9003 on SP344892
		TitledArea_sqm	479	419	299	299	419
ComponentInfo		InfrastructureCode					
		Owner	LCC	LCC	LCC	LCC	LCC
		DrawingNumber	MIR-0803	MIR-0803	MIR-0803	MIR-0803	MIR-0803
		DrawingRevision					
		ConstructionDate	2026-02-16	2026-02-16	2026-02-16	2026-02-16	2026-02-16
		Department					
		Status	Newly Constructed	Newly Constructed	Newly Constructed	Newly Constructed	Newly Constructed
		DataQuality	APlus	APlus	APlus	APlus	APlus
		Notes					
		SupportingFiles					
	Surveyor	Name					
		DateFinalSurvey					
		DateApproved					
	Engineer	Name					
		DateApproved					
Geometry		X	499447.562572	499461.305452	499471.121795	499480.938138	499494.681018
		Y	6932434.455019	6932431.814904	6932429.929107	6932428.043311	6932425.403196

Cadastre Land Parcel Lot

		ADACId	3777695	3777696	3777697		
		LotNo	4242	4263	4264		
		PlanNo	SP353603	SP353603	SP353603		
		CancelledLotPlan	9003 on SP344892	9003 on SP344892	9003 on SP344892		
		TitledArea_sqm	419	299	522		
ComponentInfo		InfrastructureCode					
		Owner	LCC	LCC	LCC		
		DrawingNumber	MIR-0803	MIR-0803	MIR-0803		
		DrawingRevision					
		ConstructionDate	2026-02-16	2026-02-16	2026-02-16		
		Department					
		Status	Newly Constructed	Newly Constructed	Newly Constructed		
		DataQuality	APlus	APlus	APlus		
		Notes					
		SupportingFiles					
	Surveyor	Name					
		DateFinalSurvey					
		DateApproved					
	Engineer	Name					
DateApproved							
Geometry		X	499508.423898	499518.240241	499531.867318		
		Y	6932422.763081	6932420.877284	6932412.335979		

Cadastre Eastment

		ADACId	3777698			
		LotNo	1			
		PlanNo	SP344913			
ComponentInfo		InfrastructureCode				
		Owner	LCC			
		DrawingNumber	MIR-0803			
		DrawingRevision				
		ConstructionDate	2026-02-16			
		Department				
		Status	Newly Constructed			
		DataQuality	APlus			
		Notes				
		SupportingFiles				
	Surveyor	Name				
		DateFinalSurvey				
		DateApproved				
Engineer	Name					
	DateApproved					
Geometry		X	499218.761358			
		Y	6932427.098417			

PM61308 RL
 E: 498528.701
 N: 6931172.420
 RL: 54.660m

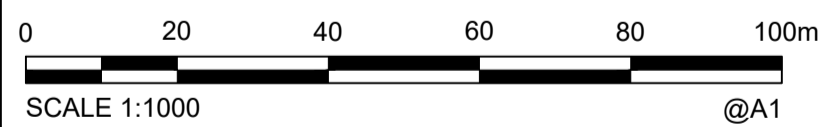

AS CONSTRUCTED

COORDINATE DATUM NOTE:
 HORIZONTAL COORDINATES(E,N) SUPPLIED ARE MAPPING GRID OF AUSTRALIA(MGA), ZONE 56 BASED ON THE UNIVERSAL TRANSVERSE MERCATOR PROJECTION AND THE GEOCENTRIC DATUM OF AUSTRALIA 2020.
 HORIZONTAL DATUM DERIVED FROM PSM 61308 E 498528.701 N 6931172.420.
 LEVELS SUPPLIED ARE ON THE AUSTRALIAN HEIGHT DATUM(AHD)
 LEVEL DATUM DERIVED FROM PSM 61308 RL54.660 (AHD)

ENGINEER'S CERTIFICATION
 I, _____, hereby certify that:
 1. The information contained in this drawing / document is in compliance with approved drawings and design.
 2. The new water and sewerage works defined by this drawing have been designed and constructed in accordance with the SEQ Code.
 3. This represents an accurate record of as-constructed works.
 4. I accept responsibility for the information contained in this drawing / document.
 RPEQ (signature) RPEQ No. _____ Date: _____

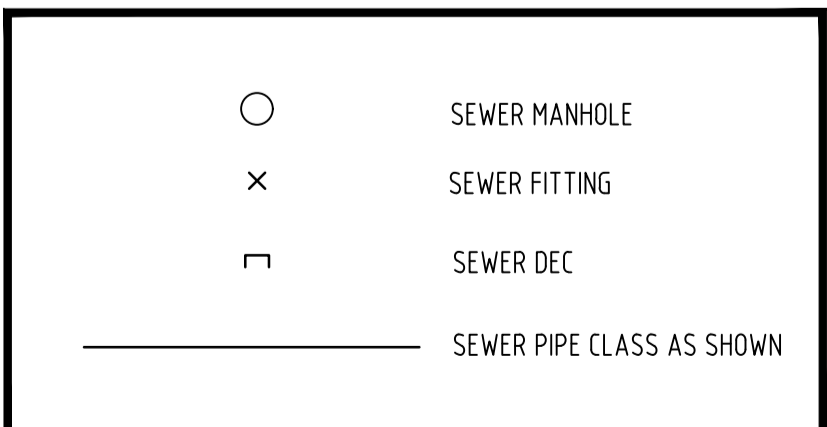

REGISTERED SURVEYOR'S CERTIFICATION
 I, Dale DeLaforce, hereby certify that the vertical and horizontal locations and dimensions shown on this plan are a true and correct record and were located by survey.
 Registered Surveyor (sig) Reg. Surveyor No. 6176 Date: 17/03/2026

A1									
	17/03/2026	AS CONSTRUCTED		JH	PASSED	JH	17/03/2026		
	INDEX	DATE	REVISIONS	DRAWN	CHECKED	PASSED	INITIALS	DATE	



LOGAN CITY COUNCIL
 MIRVAC MIR-0803
 AS CONSTRUCTED SURVEY - SEWER
 EVERLEIGH PRECINCT 8.3C
 GREENBANK QLD

SHEET 1 OF 6 SHEETS	SCALE 1:1000 A1
REVISION DATE 17/03/2026	REVISION -
DISCIPLINE CODE -	
DRAWING NO. ASC-SEWER-01-8.3C	

PM61308 RL
 E: 498528.701
 N: 6931172.420
 RL: 54.660m

AS CONSTRUCTED

ENGINEER'S CERTIFICATION

I, _____, hereby certify that:
 1. The information contained in this drawing / document is in compliance with approved drawings and design.
 2. The new water and sewerage works defined by this drawing have been designed and constructed in accordance with the SEQ Code.
 3. This represents an accurate record of as-constructed works
 4. I accept responsibility for the information contained in this drawing / document.

RPEQ (signature) RPEQ No. _____ Date: _____

- SEWER MANHOLE
- × SEWER FITTING
- ⌊ SEWER DEC
- _____ SEWER PIPE CLASS AS SHOWN

REGISTERED SURVEYOR'S CERTIFICATION

I, Dale Delaforce, hereby certify that the vertical and horizontal locations and dimensions shown on this plan are a true and correct record and were located by survey.
 Registered Surveyor (sig) Reg. Surveyor No. 6176 Date: 17/03/2026

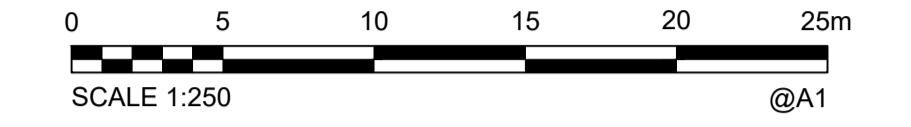

COORDINATE DATUM NOTE:
 HORIZONTAL COORDINATES(E,N) SUPPLIED ARE MAPPING GRID OF AUSTRALIA(MGA), ZONE 56 BASED ON THE UNIVERSAL TRANSVERSE MERCATOR PROJECTION AND THE GEOCENTRIC DATUM OF AUSTRALIA 2020.
 HORIZONTAL DATUM DERIVED FROM PSM 61308 E 498528.701 N 6931172.420.
 LEVELS SUPPLIED ARE ON THE AUSTRALIAN HEIGHT DATUM(AHD)
 LEVEL DATUM DERIVED FROM PSM 61308 RL54.660 (AHD)

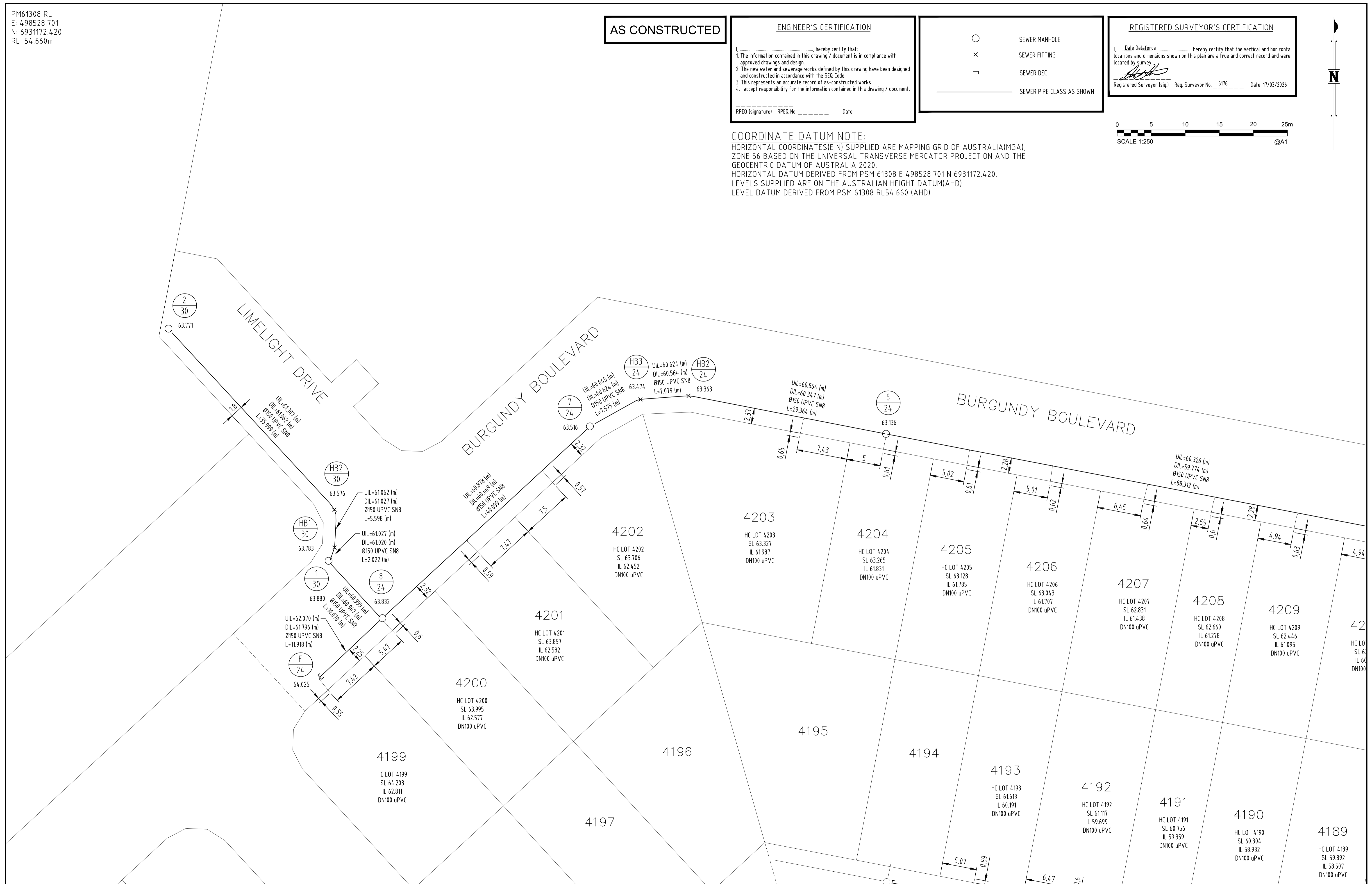

A1	INDEX	DATE	AS CONSTRUCTED	REVISIONS	DRAWN	CHECKED	PASSED	INITIALS	DATE

shadforth
 90 Sandshwood Lane, Forest Glen QLD 4056
 Ph: 07 5438 3300 | F: 07 5438 3308 | E: admin@shadforth.com.au

LOGAN CITY COUNCIL

LOGAN CITY COUNCIL
 MIRVAC MIR-003
 AS CONSTRUCTED SURVEY - SEWER
 EVERLEIGH PRECINCT 8.3C
 GREENBANK QLD

SHEET 2 OF 6 SHEETS	SCALE 1:250 A1
REVISION DATE	REVISION -
DISCIPLINE CODE -	
DRAWING NO. ASC-SEWER-02-8.3C	



AS CONSTRUCTED

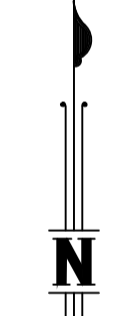
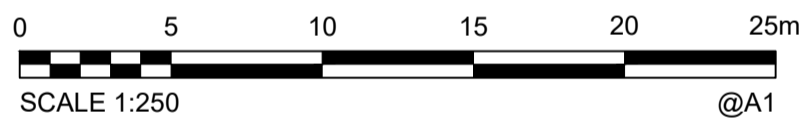

REGISTERED SURVEYOR'S CERTIFICATION
 I, Dale DeLaforce, hereby certify that the vertical and horizontal locations and dimensions shown on this plan are a true and correct record and were located by survey.
 Registered Surveyor (sig) Reg. Surveyor No. 6176 Date: 17/03/2026

ENGINEER'S CERTIFICATION
 I, _____, hereby certify that:
 1. The information contained in this drawing / document is in compliance with approved drawings and design.
 2. The new water and sewerage works defined by this drawing have been designed and constructed in accordance with the SEQ Code.
 3. This represents an accurate record of as-constructed works.
 4. I accept responsibility for the information contained in this drawing / document.
 RPEQ (signature) RPEQ No. _____ Date: _____

- SEWER MANHOLE
- × SEWER FITTING
- SEWER DEC
- SEWER PIPE CLASS AS SHOWN

COORDINATE DATUM NOTE:
 HORIZONTAL COORDINATES(E,N) SUPPLIED ARE MAPPING GRID OF AUSTRALIA(MGA), ZONE 56 BASED ON THE UNIVERSAL TRANSVERSE MERCATOR PROJECTION AND THE GEOCENTRIC DATUM OF AUSTRALIA 2020.
 HORIZONTAL DATUM DERIVED FROM PSM 61308 E 498528.701 N 6931172.420.
 LEVELS SUPPLIED ARE ON THE AUSTRALIAN HEIGHT DATUM(AHD)
 LEVEL DATUM DERIVED FROM PSM 61308 RL54.660 (AHD)

A1

INDEX	DATE	AS CONSTRUCTED	REVISIONS	DRAWN	CHECKED	PASSED	INITIALS	DATE
	17/03/2026	AS CONSTRUCTED		JH				17/03/2026



LOGAN CITY COUNCIL
 MIRVAC MIR-003
 AS CONSTRUCTED SURVEY - SEWER
 EVERLEIGH PRECINCT 8.3C
 GREENBANK QLD

SHEET 3 OF 6 SHEETS	SCALE 1:250 A1
REVISION DATE	REVISION -
DISCIPLINE CODE -	
DRAWING NO.	
ASC-SEWER-03-8.3C	

PM61308 RL
 E: 498528.701
 N: 6931172.420
 RL: 54.660m

COORDINATE DATUM NOTE:
 HORIZONTAL COORDINATES(E,N) SUPPLIED ARE MAPPING GRID OF AUSTRALIA(MGA), ZONE 56 BASED ON THE UNIVERSAL TRANSVERSE MERCATOR PROJECTION AND THE GEOCENTRIC DATUM OF AUSTRALIA 2020.
 HORIZONTAL DATUM DERIVED FROM PSM 61308 E 498528.701 N 6931172.420.
 LEVELS SUPPLIED ARE ON THE AUSTRALIAN HEIGHT DATUM(AHD)
 LEVEL DATUM DERIVED FROM PSM 61308 RL54.660 (AHD)

ENGINEER'S CERTIFICATION
 I, _____, hereby certify that:
 1. The information contained in this drawing / document is in compliance with approved drawings and design.
 2. The new water and sewerage works defined by this drawing have been designed and constructed in accordance with the SEQ Code.
 3. This represents an accurate record of as-constructed works.
 4. I accept responsibility for the information contained in this drawing / document.
 RPEQ (signature) RPEQ No. _____ Date: _____

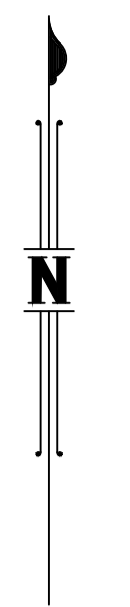
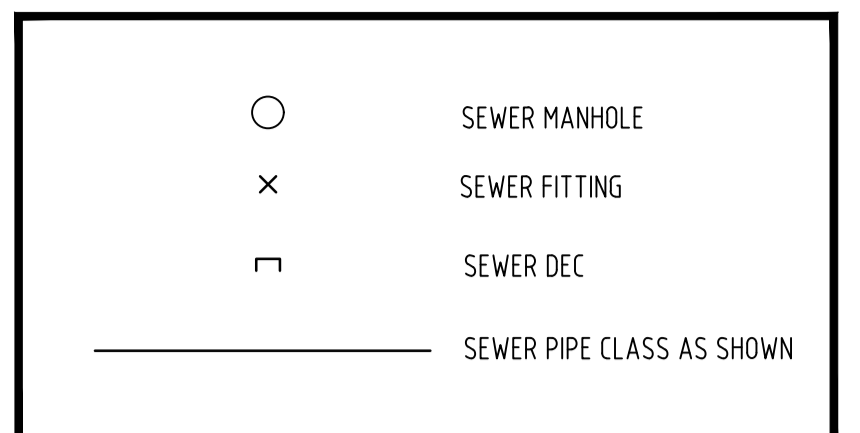

REGISTERED SURVEYOR'S CERTIFICATION
 I, Dale DeLaforce, hereby certify that the vertical and horizontal locations and dimensions shown on this plan are a true and correct record and were located by survey.
 Registered Surveyor (sig.) Reg. Surveyor No. 6176 Date: 17/03/2026

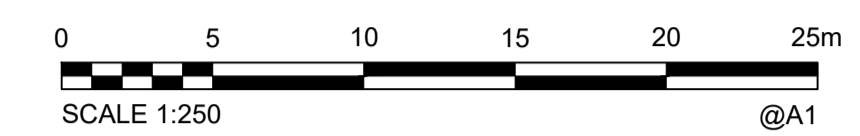

AS CONSTRUCTED



A1	17/03/2026	AS CONSTRUCTED	JH	17/03/2026
	INDEX	DATE	AS CONSTRUCTED	REVISIONS

DRAWN	ALS	17/03/2026
CHECKED	DAM	17/03/2026
PASSED	JH	17/03/2026
INITIALS		DATE



LOGAN CITY COUNCIL
 MIRVAC MIR-003
 AS CONSTRUCTED SURVEY - SEWER
 EVERLEIGH PRECINCT 8.3C
 GREENBANK QLD

SHEET 4 OF 6 SHEETS	SCALE 1:250 A1
REVISION DATE	REVISION -
DISCIPLINE CODE	-
DRAWING NO.	ASC-SEWER-04-8.3C

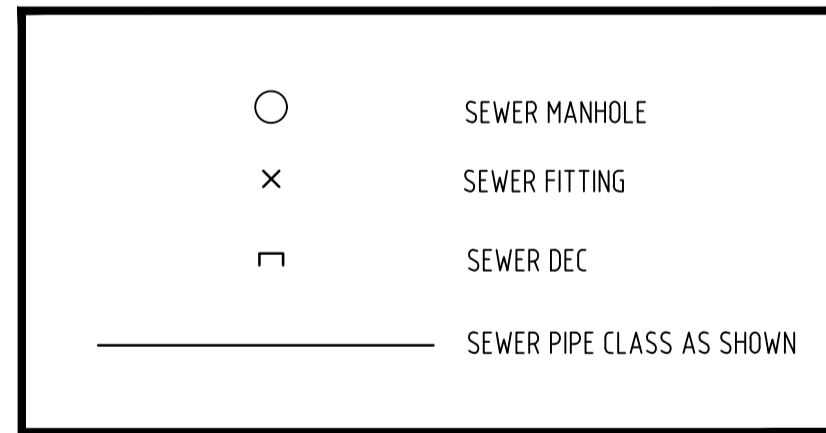
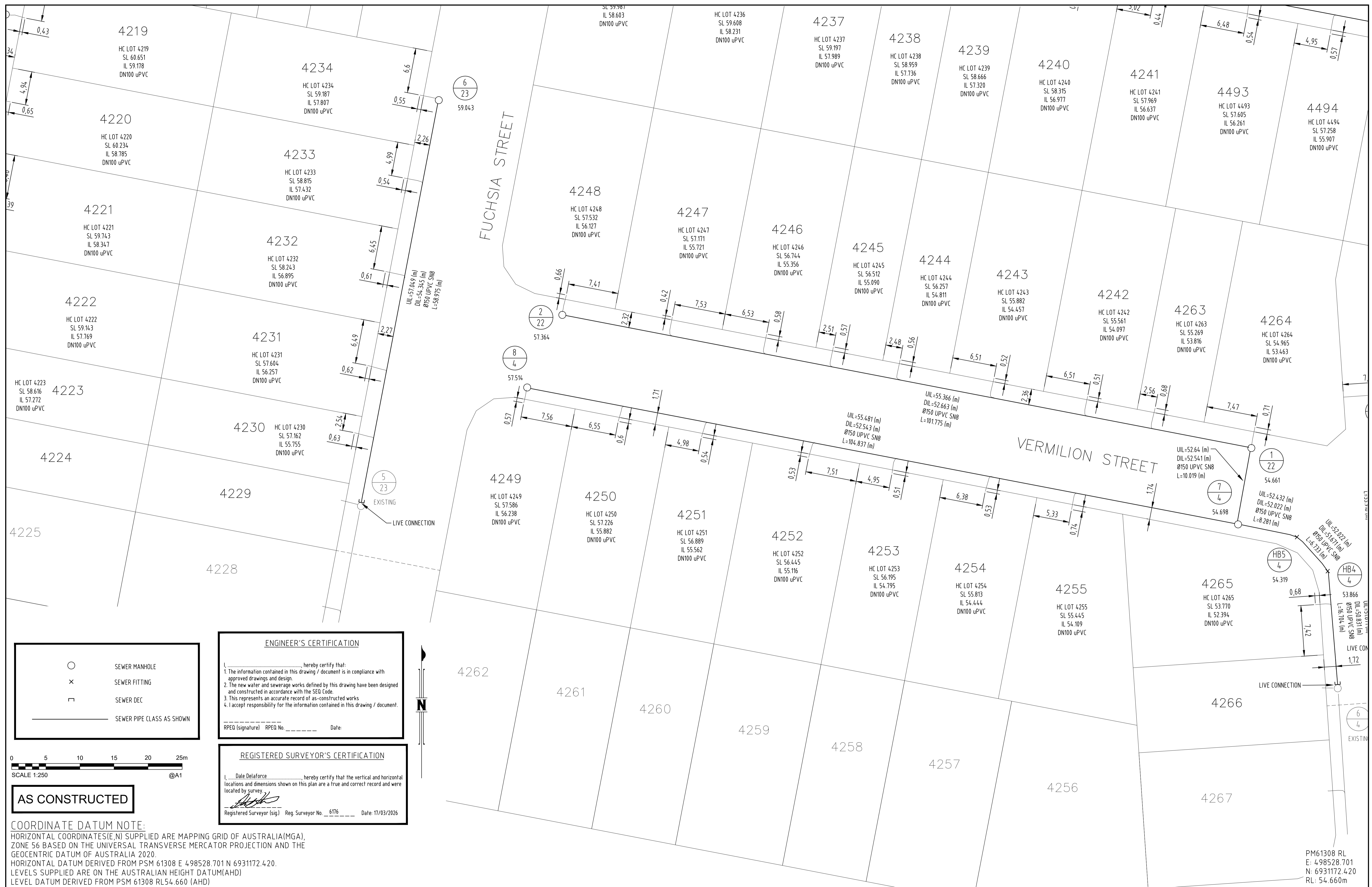

ENGINEER'S CERTIFICATION

I, _____, hereby certify that:

- The information contained in this drawing / document is in compliance with approved drawings and design.
- The new water and sewerage works defined by this drawing have been designed and constructed in accordance with the SEQ Code.
- This represents an accurate record of as-constructed works.
- I accept responsibility for the information contained in this drawing / document.

RPEQ (signature) RPEQ No. _____ Date: _____

REGISTERED SURVEYOR'S CERTIFICATION

I, Dale Delaforce, hereby certify that the vertical and horizontal locations and dimensions shown on this plan are a true and correct record and were located by survey.

Registered Surveyor (sig) Reg. Surveyor No. 6176 Date: 17/03/2026

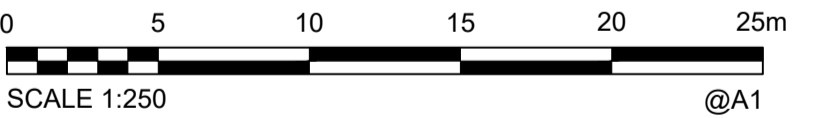

AS CONSTRUCTED

COORDINATE DATUM NOTE:
 HORIZONTAL COORDINATES(E,N) SUPPLIED ARE MAPPING GRID OF AUSTRALIA(MGA), ZONE 56 BASED ON THE UNIVERSAL TRANSVERSE MERCATOR PROJECTION AND THE GEOCENTRIC DATUM OF AUSTRALIA 2020.
 HORIZONTAL DATUM DERIVED FROM PSM 61308 E 4 98528.701 N 6931172.420.
 LEVELS SUPPLIED ARE ON THE AUSTRALIAN HEIGHT DATUM(AHD)
 LEVEL DATUM DERIVED FROM PSM 61308 RL54.660 (AHD)

PM61308 RL
 E: 498528.701
 N: 6931172.420
 RL: 54.660m

A1	INDEX	DATE	AS CONSTRUCTED	REVISIONS	DRAWN	CHECKED	PASSED	DRAWN	CHECKED	PASSED	INITIALS	DATE
		17/03/2026			JH							17/03/2026



LOGAN CITY COUNCIL

MIRVAC MIR-0803
 AS CONSTRUCTED SURVEY - SEWER
 EVERLEIGH PRECINCT 8.3C
 GREENBANK QLD

SHEET 5 OF 6 SHEETS	SCALE 1:250 A1
REVISION DATE	REVISION -
DISCIPLINE CODE	-
DRAWING NO.	ASC-SEWER-05-8.3C

MAINTENANCE HOLE / SHAFT NO.	TE3/4	HB4/4	HB5/4	7/4	8/4
MH / MS COVER TYPE				B	B
MH / MS TYPE	TE	LRB	LRB	A	J
MH DROP TYPE				V	V
LINE NO.				22	4
PROPERTY CONNECTION DEPTH				1.250	1.250
PROPERTY CONNECTION INVERT LEVEL	52.394 52.393		54.109 54.109	54.444 54.445	56.238 56.239
PROPERTY CONNECTION TYPE	B		B	B	B
LOT NO.	4265		4255	4254	4250

MAINTENANCE HOLE / SHAFT NO.	TE2/21	2/21
MH / MS COVER TYPE		B
MH / MS TYPE	TE	J
MH DROP TYPE		
LINE NO.		
PROPERTY CONNECTION DEPTH		1.250
PROPERTY CONNECTION INVERT LEVEL	52.461 52.456	52.822 52.823
PROPERTY CONNECTION TYPE	B	B
LOT NO.	4489	4490

MAINTENANCE HOLE / SHAFT NO.	7/4	1/22	2/22
MH / MS COVER TYPE	B	B	B
MH / MS TYPE	A	J	J
MH DROP TYPE	V	V	V
LINE NO.	22	4	22
PROPERTY CONNECTION DEPTH			
PROPERTY CONNECTION INVERT LEVEL	53.463 53.447	53.816 53.809	55.090 55.088
PROPERTY CONNECTION TYPE	B	B	B
LOT NO.	4264	4263	4245

LEGEND

RR DENOTES ROAD RESERVE
PP DENOTES PRIVATE PROPERTY

MANHOLE TYPES	
A	CONCRETE MANHOLE 1.05Ø
B	CONCRETE MANHOLE 1.20Ø
C	CONCRETE MANHOLE 1.50Ø
J	TYPE 'J' 1 MAINTENANCE SHAFT (DN300 SHAFT)
TE	TEMPORARY END
LRB	HORIZONTAL BEND (3m HORIZ. RADIUS)

LID TYPES	
B	CLASS B NON TRAFFICABLE CAST IRON
BD	CLASS B NON TRAFFICABLE BOLT DOWN
D	CLASS D TRAFFICABLE CAST IRON

MAINTENANCE STRUCTURE DROP TYPES	
V	FALL THROUGH MH
W	OBLIQUE 45° BACKDROP
X	INTERNAL DROP
Y	EXTERNAL DROP
VORT	INTERNAL VORTEX DROP
Z	MAINTENANCE SHAFT DROP

PROPERTY CONNECTION TYPES	
A	TYPE A - STD
B	TYPE B - SLOPE UP
D	TYPE D - VERTICAL
D(E)	TYPE D(E) - EXTENDED PROPERTY CONNECTION UNDER RETAINING WALL. SEE C530 FOR DETAILS

- NOTES:**
- EMBEDMENT TYPE 3 SHALL USE CRUSHED ROCK NOMINAL 5-7mm (SINGLE SIZED).
 - DUCTILE IRON PIPES SHALL HAVE MIN. 1300 MICRON POLYURETHANE INTERNAL LINING.

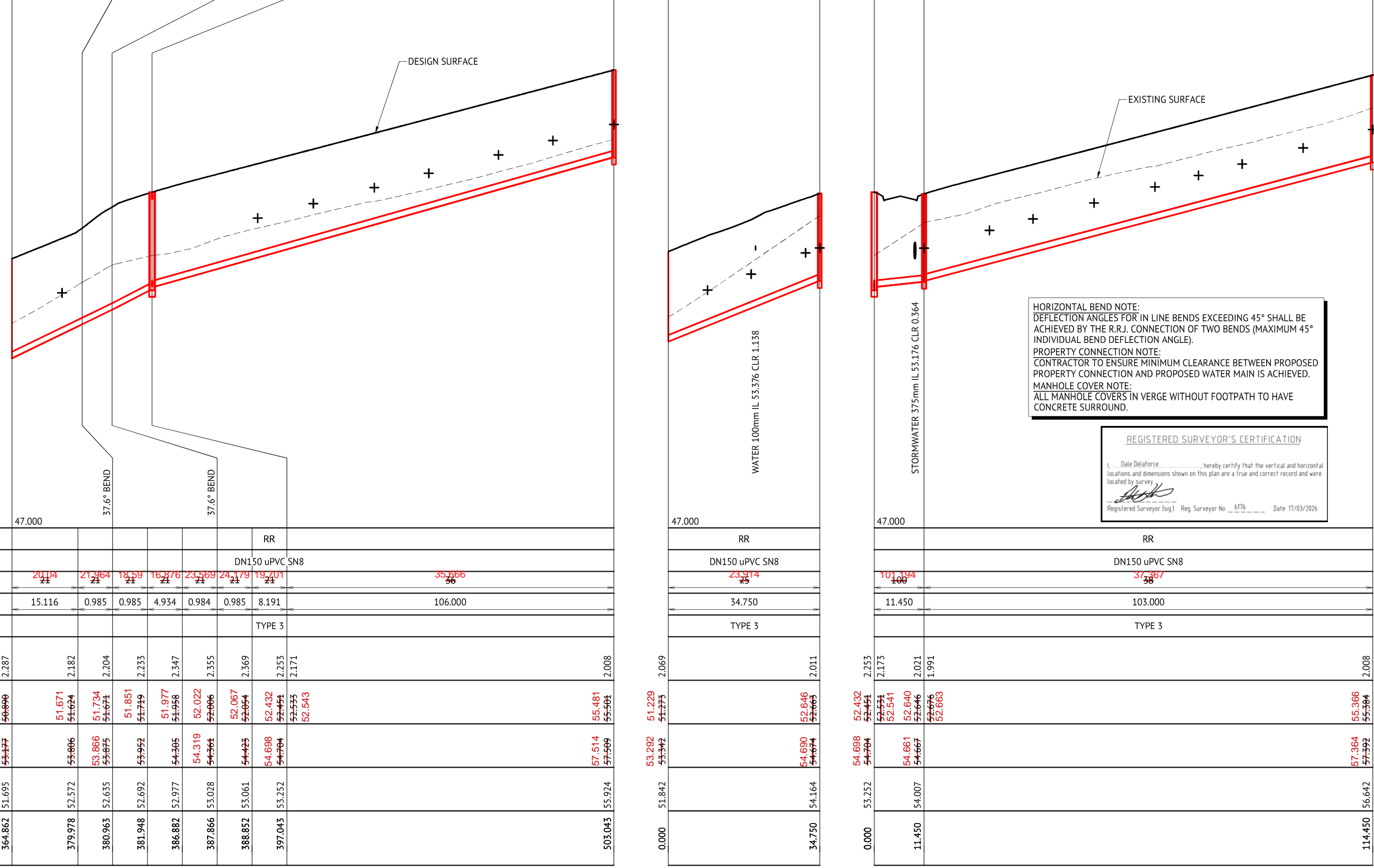

DATUM RL	47.000									
PROPERTY DESCRIPTION	RR									
PIPE SIZE (mm), CLASS	DN150 uPVC SN8									
GRADE (1 IN X)	20.14 21	21.964 21	18.59 21	16.376 21	23.569 21	24.179 21	19.701 21	35.566 36		
LENGTH	15.116	0.985	0.985	4.934	0.984	0.985	8.191	106.000		
EMBEDMENT TYPE	TYPE 3									
DEPTH OF INVERT BELOW FSL	2.287	2.182	2.204	2.235	2.347	2.355	2.369	2.253	2.171	2.008
INVERT LEVEL (IL)	50.831 50.890	51.671 51.674	51.734 51.674	51.851 51.749	51.977 51.958	52.022 52.006	52.067 52.064	52.432 52.451	52.533 52.533	55.481 55.504
FINISHED SURFACE LEVEL (FSL)	52.477 52.477	53.806	53.866 53.875	53.952	54.305	54.319 54.364	54.423	54.688 54.704	57.514 57.509	
EXISTING SURFACE LEVEL (ESL)	51.695	51.572	51.635	51.692	51.977	53.028	53.061	53.252	55.924	
CHAINAGE (CH)	364.862	379.978	380.963	381.948	386.882	387.866	388.852	397.043	503.043	

DATUM RL	47.000	
PROPERTY DESCRIPTION	RR	
PIPE SIZE (mm), CLASS	DN150 uPVC SN8	
GRADE (1 IN X)	23.314 25	101.194 100
LENGTH	34.750	103.000
EMBEDMENT TYPE	TYPE 3	
DEPTH OF INVERT BELOW FSL	2.253	2.011
INVERT LEVEL (IL)	52.432 52.451	55.366 55.384
FINISHED SURFACE LEVEL (FSL)	54.688 54.704	57.364 57.392
EXISTING SURFACE LEVEL (ESL)	53.252	56.642
CHAINAGE (CH)	0.000	114.450

HORIZONTAL BEND NOTE:
DEFLECTION ANGLES FOR IN LINE BENDS EXCEEDING 45° SHALL BE ACHIEVED BY THE R.R.J. CONNECTION OF TWO BENDS (MAXIMUM 45° INDIVIDUAL BEND DEFLECTION ANGLE).

PROPERTY CONNECTION NOTE:
CONTRACTOR TO ENSURE MINIMUM CLEARANCE BETWEEN PROPOSED PROPERTY CONNECTION AND PROPOSED WATER MAIN IS ACHIEVED.

MANHOLE COVER NOTE:
ALL MANHOLE COVERS IN VERGE WITHOUT FOOTPATH TO HAVE CONCRETE SURROUND.

REGISTERED SURVEYOR'S CERTIFICATION

I, Dale DeLaforce, hereby certify that the vertical and horizontal locations and dimensions shown on this plan are a true and correct record and were located by survey.

Dale DeLaforce
Registered Surveyor (sig) Reg. Surveyor No. 6176 Date: 17/03/2026

FOR CONSTRUCTION			
24/01/2025	B	ISSUED FOR CONSTRUCTION	KK PB
28/05/2024	A	ISSUED FOR APPROVAL	KK PB
DATE	REV	DESCRIPTION	REVISIONS

Premise

BRISBANE OFFICE
LEVEL 11, 300 ADELAIDE STREET
BRISBANE, QLD 4000
PH: (07) 3253 2222
WEB: www.premise.com.au

DESIGNED
KLYNT KIWANG

CHECKED
ANDREW LANGDON

PROJECT MANAGER
NICK SOMERVILLE

PROJECT DIRECTOR
Patrick Brady
PATRICK BRADY RPEQ 7112

SCALE

HORIZONTAL 1:500 (A1)
VERTICAL 1:50 (A1)

ORIGINAL SHEET SIZE A1

CLIENT
MIRVAC QLD PTY LTD

PROJECT
EVERLEIGH PRECINCT 8.3 SUBDIVISION DEVELOPMENT

LOCATION
TEVIOT ROAD, GREENBANK

SHEET TITLE
SEWERAGE GRAVITY MAIN LONG SECTIONS - SHEET 1

JOB CODE
MIR-0803

SHEET NUMBER
C520

REV
B

MAINTENANCE HOLE / SHAFT NO.	TE1/23	6/23
MH / MS COVER TYPE		B
MH / MS TYPE	TE	J
MH DROP TYPE		
LINE NO.		
PROPERTY CONNECTION DEPTH	1.250	1.250
PROPERTY CONNECTION INVERT LEVEL	55.755 55.762	56.257 56.259
PROPERTY CONNECTION TYPE	B	B
LOT NO.	4230	4234

MAINTENANCE HOLE / SHAFT NO.	TE1/24	3/24	4/24
MH / MS COVER TYPE		B	B
MH / MS TYPE	TE	J	J
MH DROP TYPE		V	V
LINE NO.		24	24
PROPERTY CONNECTION DEPTH	1.250	1.250	1.250
PROPERTY CONNECTION INVERT LEVEL	54.563 54.572	54.795 54.795	54.988 55.018
PROPERTY CONNECTION TYPE	B	B	B
LOT NO.	4499	4498	4497

LEGEND RR DENOTES ROAD RESERVE
PP DENOTES PRIVATE PROPERTY

MANHOLE TYPES	
A	CONCRETE MANHOLE 1.05Ø
B	CONCRETE MANHOLE 1.20Ø
C	CONCRETE MANHOLE 1.50Ø
J	TYPE 'J' 1 MAINTENANCE SHAFT (DN300 SHAFT)
TE	TEMPORARY END
LRB	HORIZONTAL BEND (3m HORIZ. RADIUS)

LID TYPES	
B	CLASS B NON TRAFFICABLE CAST IRON
BD	CLASS B NON TRAFFICABLE BOLT DOWN
D	CLASS D TRAFFICABLE CAST IRON

MAINTENANCE STRUCTURE DROP TYPES	
V	FALL THROUGH MH
W	OBLIQUE 45° BACKDROP
X	INTERNAL DROP
Y	EXTERNAL DROP
VORT	INTERNAL VORTEX DROP
Z	MAINTENANCE SHAFT DROP

PROPERTY CONNECTION TYPES	
A	TYPE A - STD
B	TYPE B - SLOPE UP
D	TYPE D - VERTICAL
D(E)	TYPE D(E) - EXTENDED PROPERTY CONNECTION UNDER RETAINING WALL. SEE C530 FOR DETAILS

- NOTES:**
1. EMBEDMENT TYPE 3 SHALL USE CRUSHED ROCK NOMINAL 5-7mm (SINGLE SIZED).
 2. DUCTILE IRON PIPES SHALL HAVE MIN. 1300 MICRON POLYURETHANE INTERNAL LINING.

DATUM RL	51.000
PROPERTY DESCRIPTION	RR
PIPE SIZE (mm), CLASS	DN150 uPVC SN8
GRADE (1 IN X)	21.87 24
LENGTH	59.500
EMBEDMENT TYPE	TYPE 3
DEPTH OF INVERT BELOW FSL	2.000
INVERT LEVEL (IL)	54.345 54.564
FINISHED SURFACE LEVEL (FSL)	56.494 56.564
EXISTING SURFACE LEVEL (ESL)	55.238
CHAINAGE (CH)	191.025

LINE 23

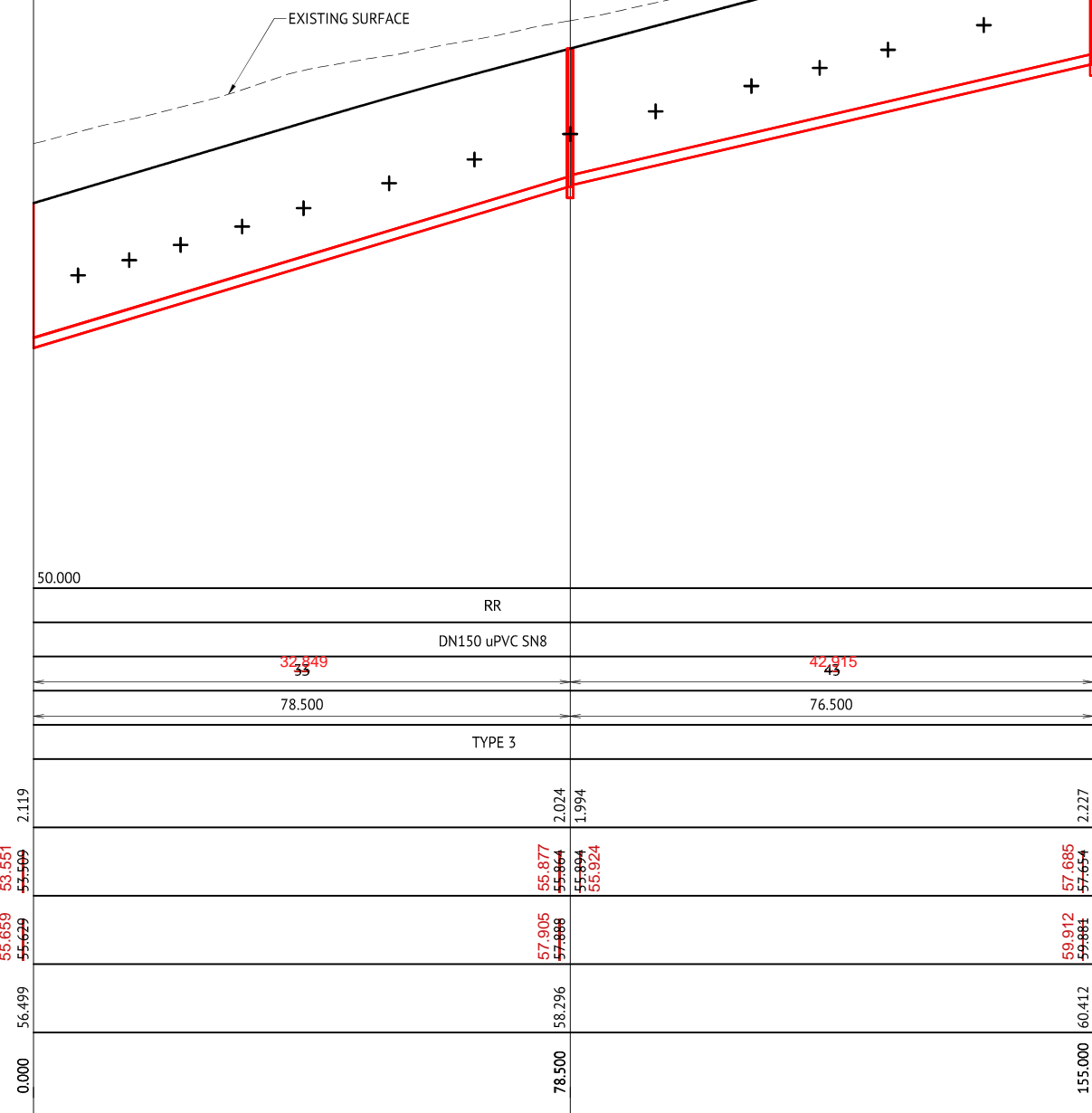

LINE 24

HORIZONTAL BEND NOTE:
DEFLECTION ANGLES FOR IN LINE BENDS EXCEEDING 45° SHALL BE ACHIEVED BY THE R.R.J. CONNECTION OF TWO BENDS (MAXIMUM 45° INDIVIDUAL BEND DEFLECTION ANGLE).
PROPERTY CONNECTION NOTE:
CONTRACTOR TO ENSURE MINIMUM CLEARANCE BETWEEN PROPOSED PROPERTY CONNECTION AND PROPOSED WATER MAIN IS ACHIEVED.
MANHOLE COVER NOTE:
ALL MANHOLE COVERS IN VERGE WITHOUT FOOTPATH TO HAVE CONCRETE SURROUND.

REGISTERED SURVEYOR'S CERTIFICATION
I, Dale DeLaforce, hereby certify that the vertical and horizontal locations and dimensions shown on this plan are a true and correct record and were located by survey.
Registered Surveyor (sig) Reg. Surveyor No. 6176 Date 17/03/2026

FOR CONSTRUCTION			
24/01/2025	B	ISSUED FOR CONSTRUCTION	KK PB
28/05/2024	A	ISSUED FOR APPROVAL	KK PB
DATE	REV	DESCRIPTION	REC APP

Premise
BRISBANE OFFICE
LEVEL 11, 300 ADELAIDE STREET
BRISBANE, QLD 4000
PH: (07) 3253 2222
WEB: www.premise.com.au

DESIGNED
KLYNT KIWANG
CHECKED
ANDREW LANGDON
PROJECT MANAGER
NICK SOMERVILLE
PROJECT DIRECTOR
PATRICK BRADY
KPEQ 7112

SCALE
HORIZONTAL 1:500 (A1)
VERTICAL 1:50 (A1)
ORIGINAL SHEET SIZE A1

CLIENT
MIRVAC QLD PTY LTD
PROJECT
EVERLEIGH PRECINCT 8.3 SUBDIVISION DEVELOPMENT
LOCATION
TEVIOT ROAD, GREENBANK
SHEET TITLE
SEWERAGE GRAVITY MAIN LONG SECTIONS - SHEET 2

JOB CODE
MIR-0803
SHEET NUMBER
C521
REV
B

MAINTENANCE HOLE / SHAFT NO.	4/24	5/24	6/24	HB2/24	HB3/24	7/24
MH / MS COVER TYPE	B	B	B			B
MH / MS TYPE	J	J	J	LRB	LRB	J
MH DROP TYPE	V	V	V			V
LINE NO.	24	24	24			24
PROPERTY CONNECTION DEPTH	1.250	1.250	1.250	1.250	1.250	1.250
PROPERTY CONNECTION INVERT LEVEL	58.603 58.634	59.302 59.307	59.599 59.604	59.736 59.725	59.821 59.844	59.962 59.963
PROPERTY CONNECTION TYPE	B	D(E)	B	B	B	D
LOT NO.	4235	4218	4217	4216	4215	4214

LEGEND
 RR DENOTES ROAD RESERVE
 PP DENOTES PRIVATE PROPERTY

MANHOLE TYPES	
A	CONCRETE MANHOLE 1.05Ø
B	CONCRETE MANHOLE 1.20Ø
C	CONCRETE MANHOLE 1.50Ø
J	TYPE 'J' 1 MAINTENANCE SHAFT (DN300 SHAFT)
TE	TEMPORARY END
LRB	HORIZONTAL BEND (3m HORIZ. RADIUS)

LID TYPES	
B	CLASS B NON TRAFFICABLE CAST IRON
BD	CLASS B NON TRAFFICABLE BOLT DOWN
D	CLASS D TRAFFICABLE CAST IRON

MAINTENANCE STRUCTURE DROP TYPES	
V	FALL THROUGH MH
W	OBLIQUE 45° BACKDROP
X	INTERNAL DROP
Y	EXTERNAL DROP
VORT	INTERNAL VORTEX DROP
Z	MAINTENANCE SHAFT DROP

PROPERTY CONNECTION TYPES	
A	TYPE A - STD
B	TYPE B - SLOPE UP
D	TYPE D - VERTICAL
D(E)	TYPE D(E) - EXTENDED PROPERTY CONNECTION UNDER RETAINING WALL. SEE C530 FOR DETAILS

- NOTES:**
- EMBEDMENT TYPE 3 SHALL USE CRUSHED ROCK NOMINAL 5-7mm (SINGLE SIZED).
 - DUCTILE IRON PIPES SHALL HAVE MIN. 1300 MICRON POLYURETHANE INTERNAL LINING.

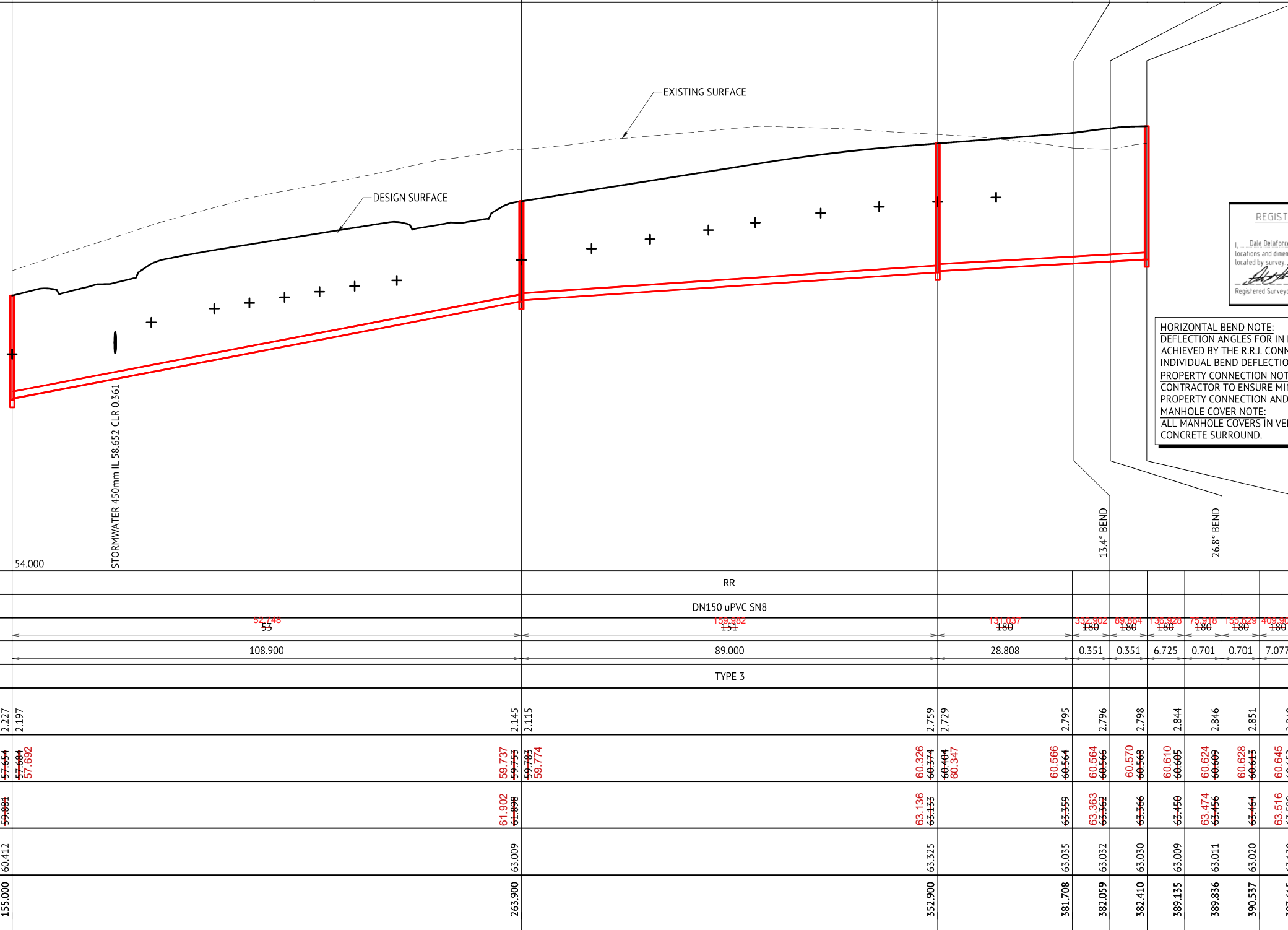

REGISTERED SURVEYOR'S CERTIFICATION
 I, Dale DeLaforce, hereby certify that the vertical and horizontal locations and dimensions shown on this plan are a true and correct record and were located by survey.
 Registered Surveyor (sig) Reg. Surveyor No. 6176 Date 11/03/2026

HORIZONTAL BEND NOTE:
 DEFLECTION ANGLES FOR IN LINE BENDS EXCEEDING 45° SHALL BE ACHIEVED BY THE R.R.J. CONNECTION OF TWO BENDS (MAXIMUM 45° INDIVIDUAL BEND DEFLECTION ANGLE).
PROPERTY CONNECTION NOTE:
 CONTRACTOR TO ENSURE MINIMUM CLEARANCE BETWEEN PROPOSED PROPERTY CONNECTION AND PROPOSED WATER MAIN IS ACHIEVED.
MANHOLE COVER NOTE:
 ALL MANHOLE COVERS IN VERGE WITHOUT FOOTPATH TO HAVE CONCRETE SURROUND.

DATUM RL	54.000
PROPERTY DESCRIPTION	RR
PIPE SIZE (mm), CLASS	DN150 uPVC SN8
GRADE (1 IN X)	52.728 55
LENGTH	108.900
EMBEDMENT TYPE	TYPE 3
DEPTH OF INVERT BELOW FSL	2.227 2.197
INVERT LEVEL (IL)	57.685 57.654 57.692 57.694
FINISHED SURFACE LEVEL (FSL)	59.912 59.881
EXISTING SURFACE LEVEL (ESL)	60.412
CHAINAGE (CH)	155.000

FOR CONSTRUCTION

DATE	REV	DESCRIPTION	REC	APP
24/01/2025	B	ISSUED FOR CONSTRUCTION	KK	PB
28/05/2024	A	ISSUED FOR APPROVAL	KK	PB

Premise
 BRISBANE OFFICE
 LEVEL 11, 300 ADELAIDE STREET
 BRISBANE, QLD 4000
 PH: (07) 3253 2222
 WEB: www.premise.com.au

DESIGNED
 KLYNT KIWANG
 CHECKED
 ANDREW LANGDON
 PROJECT MANAGER
 NICK SOMERVILLE
 PROJECT DIRECTOR
 PATRICK BRADY
 KPEQ 7112

SCALE
 HORIZONTAL 1:500 (A1)
 VERTICAL 1:50 (A1)
 ORIGINAL SHEET SIZE A1

CLIENT
MIRVAC QLD PTY LTD
 PROJECT
EVERLEIGH PRECINCT 8.3 SUBDIVISION DEVELOPMENT
 LOCATION
TEVIOT ROAD, GREENBANK
 SHEET TITLE
SEWERAGE GRAVITY MAIN LONG SECTIONS - SHEET 3

JOB CODE
MIR-0803
 SHEET NUMBER
C522
 REV
B

MAINTENANCE HOLE / SHAFT NO.	7/24	8/24	E/24
MH / MS COVER TYPE	B	B	END
MH / MS TYPE	J	A	
MH DROP TYPE	V	V	X
LINE NO.	24	30	24
PROPERTY CONNECTION DEPTH	1.250	1.250	1.250
PROPERTY CONNECTION INVERT LEVEL	62.452 62.329	62.582 62.446	62.577 62.566 62.811 62.805
PROPERTY CONNECTION TYPE	D	D	B
LOT NO.	4202	4201	4200

TE/1/27	3/27	4/27
TE	B	B
	A	J
	V	W
	28	27
	1.250	1.250
	57.272 57.276	57.769 57.772
	B	B
	4223	4222
	1.250	1.250
	58.347 58.356	58.785 58.807
	B	B
	4220	4219
	1.250	1.250
	59.178 59.180	

3/27	1/28	H/1/28	2/28
B	B		B
A	A	LRB	J
V	V		V
28	27		29
	1.250	1.250	1.250
	58.065 58.071	58.525 58.579	59.065 59.064 59.384 59.411
	B	B	B
	4187	4186	4185
	1.250	1.250	1.250
	59.746 59.758	60.208 60.243	

1/28	1/29
B	B
A	J
V	V
29	29
	1.250
	58.015 58.005
	B
	4188



LEGEND
 RR DENOTES ROAD RESERVE
 PP DENOTES PRIVATE PROPERTY

MANHOLE TYPES	
A	CONCRETE MANHOLE 1.05Ø
B	CONCRETE MANHOLE 1.20Ø
C	CONCRETE MANHOLE 1.50Ø
J	TYPE 'J' 1 MAINTENANCE SHAFT (DN300 SHAFT)
TE	TEMPORARY END
LRB	HORIZONTAL BEND (3m HORIZ. RADIUS)

LID TYPES	
B	CLASS B NON TRAFFICABLE CAST IRON
BD	CLASS B NON TRAFFICABLE BOLT DOWN
D	CLASS D TRAFFICABLE CAST IRON

MAINTENANCE STRUCTURE DROP TYPES	
V	FALL THROUGH MH
W	OBLIQUE 45° BACKDROP
X	INTERNAL DROP
Y	EXTERNAL DROP
VORT	INTERNAL VORTEX DROP
Z	MAINTENANCE SHAFT DROP

PROPERTY CONNECTION TYPES	
A	TYPE A - STD
B	TYPE B - SLOPE UP
D	TYPE D - VERTICAL
D(E)	TYPE D(E) - EXTENDED PROPERTY CONNECTION UNDER RETAINING WALL. SEE C530 FOR DETAILS

- NOTES:**
 1. EMBEDMENT TYPE 3 SHALL USE CRUSHED ROCK NOMINAL 5-7mm (SINGLE SIZED).
 2. DUCTILE IRON PIPES SHALL HAVE MIN. 1300 MICRON POLYURETHANE INTERNAL LINING.

DATUM RL	56.000
PROPERTY DESCRIPTION	RR
PIPE SIZE (mm), CLASS	DN150 uPVC SN8
GRADE (1 IN X)	131.857 130 / 64
LENGTH	42.037
EMBEDMENT TYPE	TYPE 3
DEPTH OF INVERT BELOW FSL	2.848 2.818
INVERT LEVEL (IL)	60.645 60.652 60.669 60.669
FINISHED SURFACE LEVEL (FSL)	63.516 63.500
EXISTING SURFACE LEVEL (ESL)	63.138
CHAINAGE (CH)	397.615

DATUM RL	51.000
PROPERTY DESCRIPTION	RR
PIPE SIZE (mm), CLASS	DN150 uPVC SN8
GRADE (1 IN X)	31.284 31 / 29
LENGTH	19.000
EMBEDMENT TYPE	TYPE 3
DEPTH OF INVERT BELOW FSL	2.167
INVERT LEVEL (IL)	56.467 56.496 57.044 57.068
FINISHED SURFACE LEVEL (FSL)	59.054 59.022
EXISTING SURFACE LEVEL (ESL)	59.190
CHAINAGE (CH)	78.144

DATUM RL	52.000
PROPERTY DESCRIPTION	RR
PIPE SIZE (mm), CLASS	DN150 uPVC SN8
GRADE (1 IN X)	91.582 100 / 26
LENGTH	15.409
EMBEDMENT TYPE	TYPE 3
DEPTH OF INVERT BELOW FSL	2.526 2.446
INVERT LEVEL (IL)	56.467 56.576 56.575 56.732 56.730 56.838 56.959 56.957
FINISHED SURFACE LEVEL (FSL)	59.190 59.141
EXISTING SURFACE LEVEL (ESL)	59.896
CHAINAGE (CH)	15.409

DATUM RL	53.000
PROPERTY DESCRIPTION	RR
PIPE SIZE (mm), CLASS	DN150 uPVC SN8
GRADE (1 IN X)	37.459 38 / 26
LENGTH	13.448
EMBEDMENT TYPE	TYPE 3
DEPTH OF INVERT BELOW FSL	2.411 2.304
INVERT LEVEL (IL)	56.732 56.736 56.856 56.856
FINISHED SURFACE LEVEL (FSL)	59.190 59.141
EXISTING SURFACE LEVEL (ESL)	59.896
CHAINAGE (CH)	13.448

HORIZONTAL BEND NOTE:
 DEFLECTION ANGLES FOR IN LINE BENDS EXCEEDING 45° SHALL BE ACHIEVED BY THE R.R.J. CONNECTION OF TWO BENDS (MAXIMUM 45° INDIVIDUAL BEND DEFLECTION ANGLE).
PROPERTY CONNECTION NOTE:
 CONTRACTOR TO ENSURE MINIMUM CLEARANCE BETWEEN PROPOSED PROPERTY CONNECTION AND PROPOSED WATER MAIN IS ACHIEVED.
MANHOLE COVER NOTE:
 ALL MANHOLE COVERS IN VERGE WITHOUT FOOTPATH TO HAVE CONCRETE SURROUND.

REGISTERED SURVEYOR'S CERTIFICATION
 I, Dale DeLaforce, hereby certify that the vertical and horizontal locations and dimensions shown on this plan are a true and correct record and were located by survey.
 Registered Surveyor (sg) Reg. Surveyor No. 6175 Date: 07/03/2026

FOR CONSTRUCTION

DATE	REV	DESCRIPTION	REC	APP
15/08/2025	C	UPDATED WATER CROSSING	KK	PB
24/01/2025	B	ISSUED FOR CONSTRUCTION	KK	PB
28/05/2024	A	ISSUED FOR APPROVAL	KK	PE

Premise
 BRISBANE OFFICE
 LEVEL 11, 300 ADELAIDE STREET
 BRISBANE, QLD 4000
 PH: (07) 3253 2222
 WEB: www.premise.com.au

DESIGNED
 KLYNT KIWANG
 CHECKED
 ANDREW LANGDON
 PROJECT MANAGER
 NICK SOMERVILLE
 PROJECT DIRECTOR
 PATRICK BRADY
 RPEQ 7112

SCALE
 HORIZONTAL 1:500 (A1)
 VERTICAL 1:50 (A1)
 ORIGINAL SHEET SIZE A1

CLIENT
MIRVAC QLD PTY LTD
 PROJECT
EVERLEIGH PRECINCT 8.3 SUBDIVISION DEVELOPMENT
 LOCATION
TEVIOT ROAD, GREENBANK
 SHEET TITLE
SEWERAGE GRAVITY MAIN LONG SECTIONS - SHEET 4

JOB CODE
MIR-0803
 SHEET NUMBER
C523
 REV
C

