

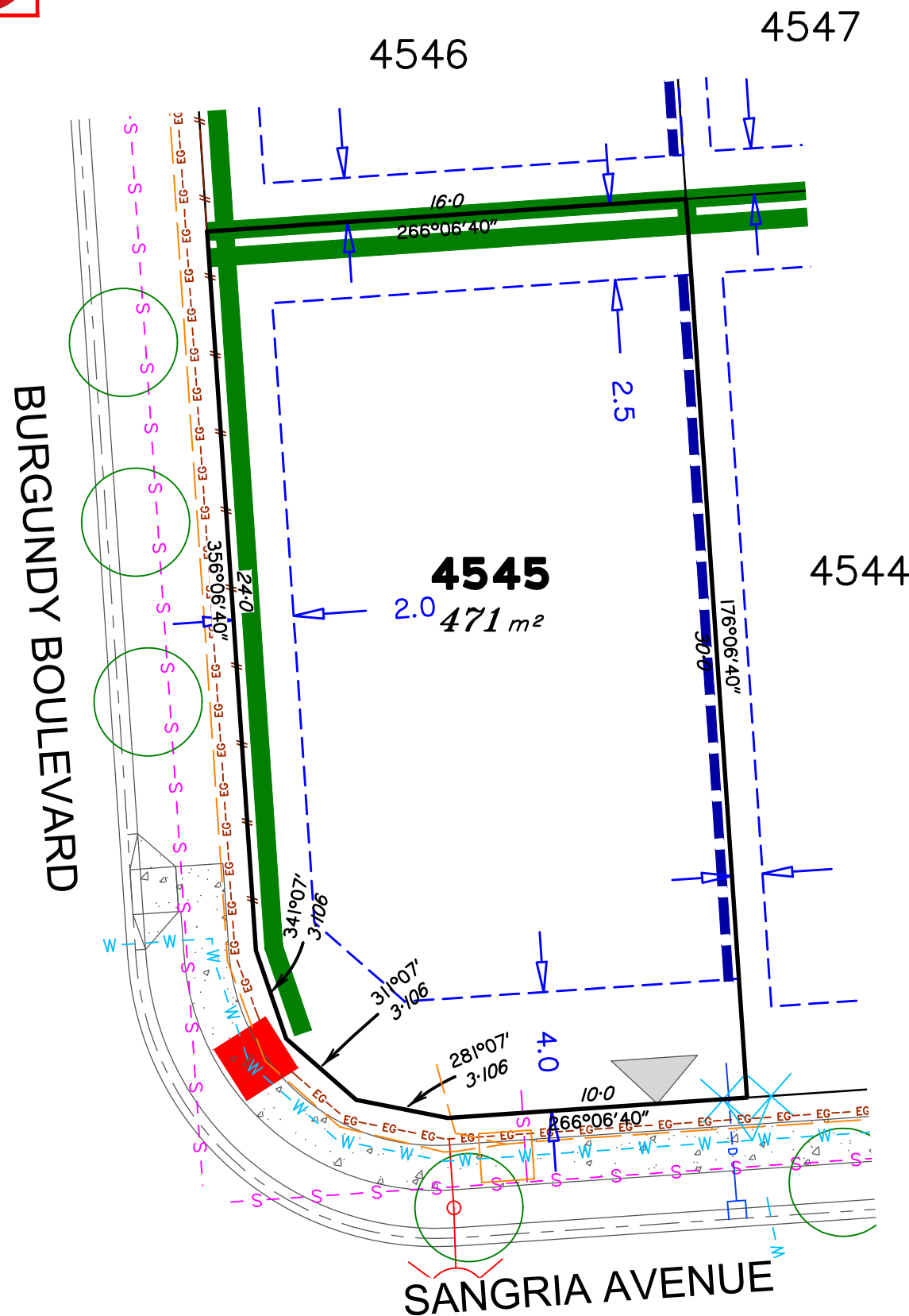

Everleigh

PRECINCT 8.1

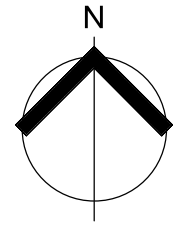

NOTES

1. The lot boundaries & area shown hereon were not marked at the time of publication and have been determined from calculated dimensions supplied by Saunders Havill Group.
2. Services shown hereon have been plotted from the latest design information available at the time of publication. The relevant authorities and/or service provider should be contacted for "As Constructed" or DBYD information prior to any design and/or construction of any structure.
3. These notes form an integral part of this plan. This plan may not be reproduced unless these notes are included. If others use this information, they should be advised of its purpose and limitations.
4. Services design information supplied by Premise Civil Engineers & Robin Russell & Associates Electrical Engineers. Landscape and Plan of Development information supplied by Urbis.

LEGEND

Services & Features

- E --- Electrical (Stand Alone Trench)
- EG --- Electrical & Gas Shared Trench
- G --- Gas (Stand Alone Trench)
- NBN
- S --- Sewer Line / Manhole
- SW --- Stormwater Line / Manhole
- D --- Roofwater Line / Pit / Kerb Adaptor
- W --- Water
- Proposed Retaining Wall
- Acoustic Fence (To be constructed by Mirvac)
- Feature Fence (To be constructed by Mirvac)
- Stormwater Gully Pit
- Streetlight
- Electrical Pillar
- NBN Pit
- Water Meter Box (Meter by Owner/Builder)
- Street Tree

Approved Plan of Development - Envelope Plan and Design Criteria

- Building Envelope
- Built-to-Boundary Wall
- Driveway Crossover Location
- Buildings will require acoustic design to upper floors only
- Buildings will require acoustic design to the ground and upper floors



SCALE @A3 1:200 - LENGTHS ARE IN METRES

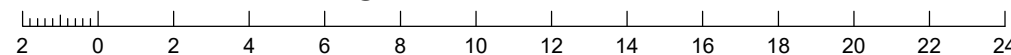

No.	by	Date	Chkd	Description
A	TG	22/10/24	TG	Original Issue



Saunders Havill Group Pty Ltd ABN 24 144 972 949
 Brisbane Springfield
 head office 9 Thompson St Bowen Hills Q 4006
 phone 1300 123 SHG web www.saundershavill.com

■ surveying ■ town planning ■ urban design ■ environmental management ■ landscape architecture

This information is compiled from design plans only, unless otherwise stated, and therefore is subject to final survey and construction of operational works.

Services & Other Features Plan for Proposed Lot 4545 on SP348261

Locality of Greenbank (Logan City Council)

Scale @A3 1: 200

Dwg No. 7598 S 72 AD A_4545