

**Everleigh**

PRECINCT 10.3

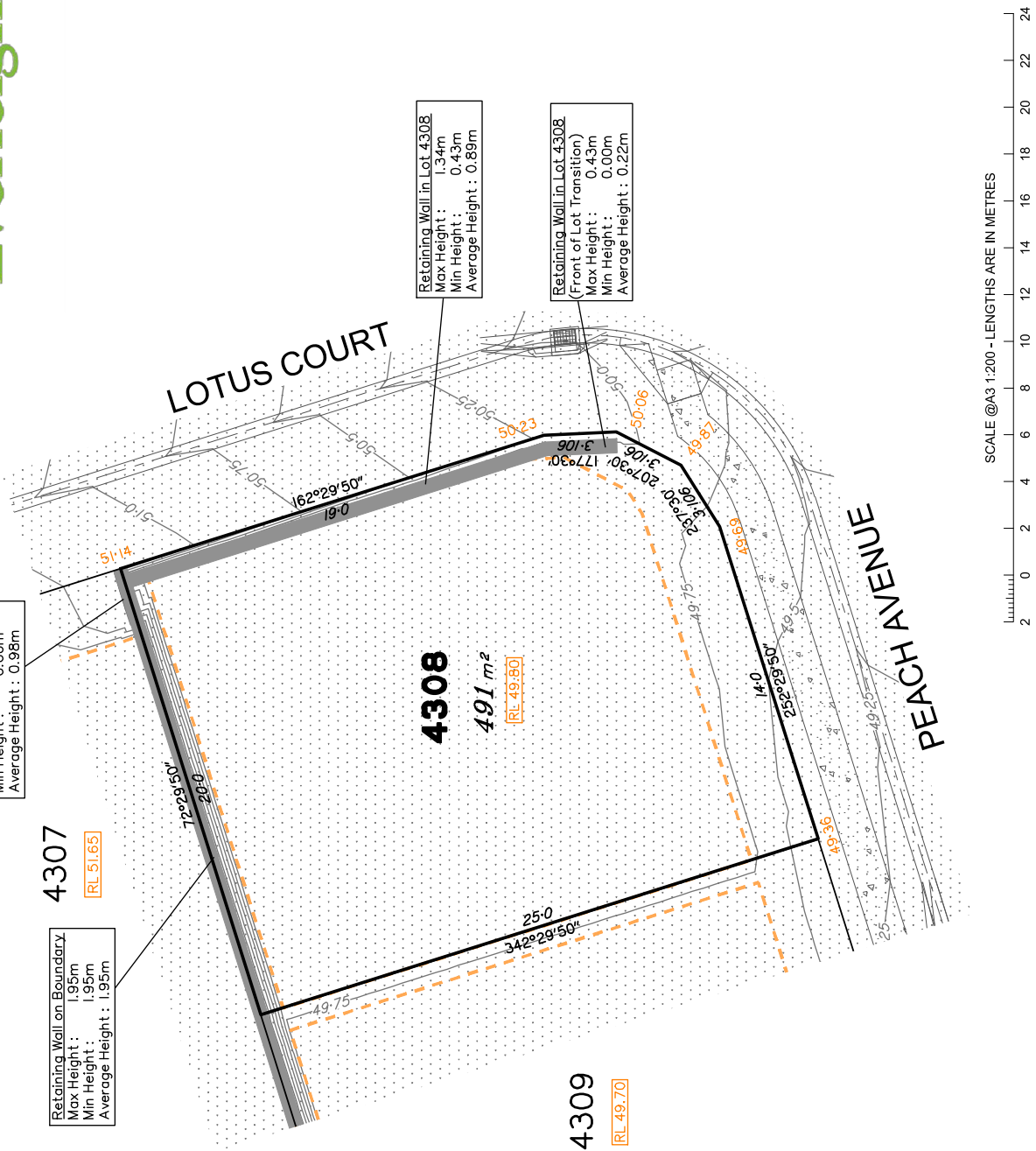

**Retaining Wall on Boundary (Front of Lot Transition)**  
 Max Height : 1.95m  
 Min Height : 0.00m  
 Average Height : 0.98m

**Retaining Wall on Boundary**  
 Max Height : 1.95m  
 Min Height : 1.95m  
 Average Height : 1.95m

**Retaining Wall in Lot 4308**  
 Max Height : 1.34m  
 Min Height : 0.43m  
 Average Height : 0.89m

**Retaining Wall in Lot 4308 (Front of Lot Transition)**  
 Max Height : 0.43m  
 Min Height : 0.00m  
 Average Height : 0.22m

- LEGEND**
- Area of Fill
  - Area of Cut
  - Design Contours
  - Depth of Fill Contours
  - Retaining Wall
  - Tiered Retaining Wall
  - Earthworks Pad
  - Finished Pad Design Level
  - Finished Surface Design Level

(Not all items in this legend may be relevant to the lot shown hereon)

This Disclosure Plan is prepared for the sole purpose of satisfying the disclosure requirements of the Land Sales Act and SHOULD NOT be used for any other purpose, particularly as-constructed purposes. This information is compiled from design plans only, unless otherwise stated, and therefore is subject to final survey and construction of operational works.

Saunders Havill Group Pty Ltd ABN 24 144 972 949  
 Brisbane @ Springfield  
 head office 9 Thompson St, Bowen Hills, Q 4006  
 phone 1800 838 516 web www.saundershavill.com



Level Datum: AHD der.  
 Origin of Levels: PSM 203673  
 RL of Origin: 54.070  
 Contour Interval: 0.25m  
 Scale @A3 1:200  
 Dwg No. 7598 S 65 DP A\_4308

**Disclosure Plan for Proposed Lot 4308 on SP344913**  
 Described as part of Lot 9003 on SP344891  
 Existing Title Reference: 51344722  
 Locality of Greenbank (Logan City Council)

**NOTES**

- This plan has been prepared from preliminary survey plan (SP344913) and engineering plans provided on the 11/03/2024 by Premise Civil Engineering Pty Ltd.
- The current development approval was granted for this subdivision (DEV202212777) by the Minister for Economic Development Queensland on 15th of December 2023.
- The relevant authorities have granted operational works approval for the proposed lot.
- The purchaser should refer to the applicable development approvals for building and/or other requirements that may be applicable to the lot.
- Extent of retaining walls shown indicatively only. Retaining walls may not extend the full length of a lot boundary where finished level between allotments is less than 0.5m.
- Parts of this lot may be subject to rip and re-compact earthwork procedures as determined by site conditions. This process may be completed in cut locations to assist the horse pad construction. Any re-compaction will comply with AS3796 requirements and certified by a third party company.

No.	by	Date	Checked	Description
A	MD	03/04/24	PS	Original Issue