

# Everleigh



Retaining Wall in Lot 4086  
(Front of Lot Transition)  
Max Height : 0.43m  
Min Height : 0.00m  
Average Height : 0.22m

Retaining Wall in Lot 4086  
Max Height : 0.43m  
Min Height : 0.10m  
Average Height : 0.27m

Retaining Wall on Boundary  
Max Height : 0.70m  
Min Height : 0.70m  
Average Height : 0.70m

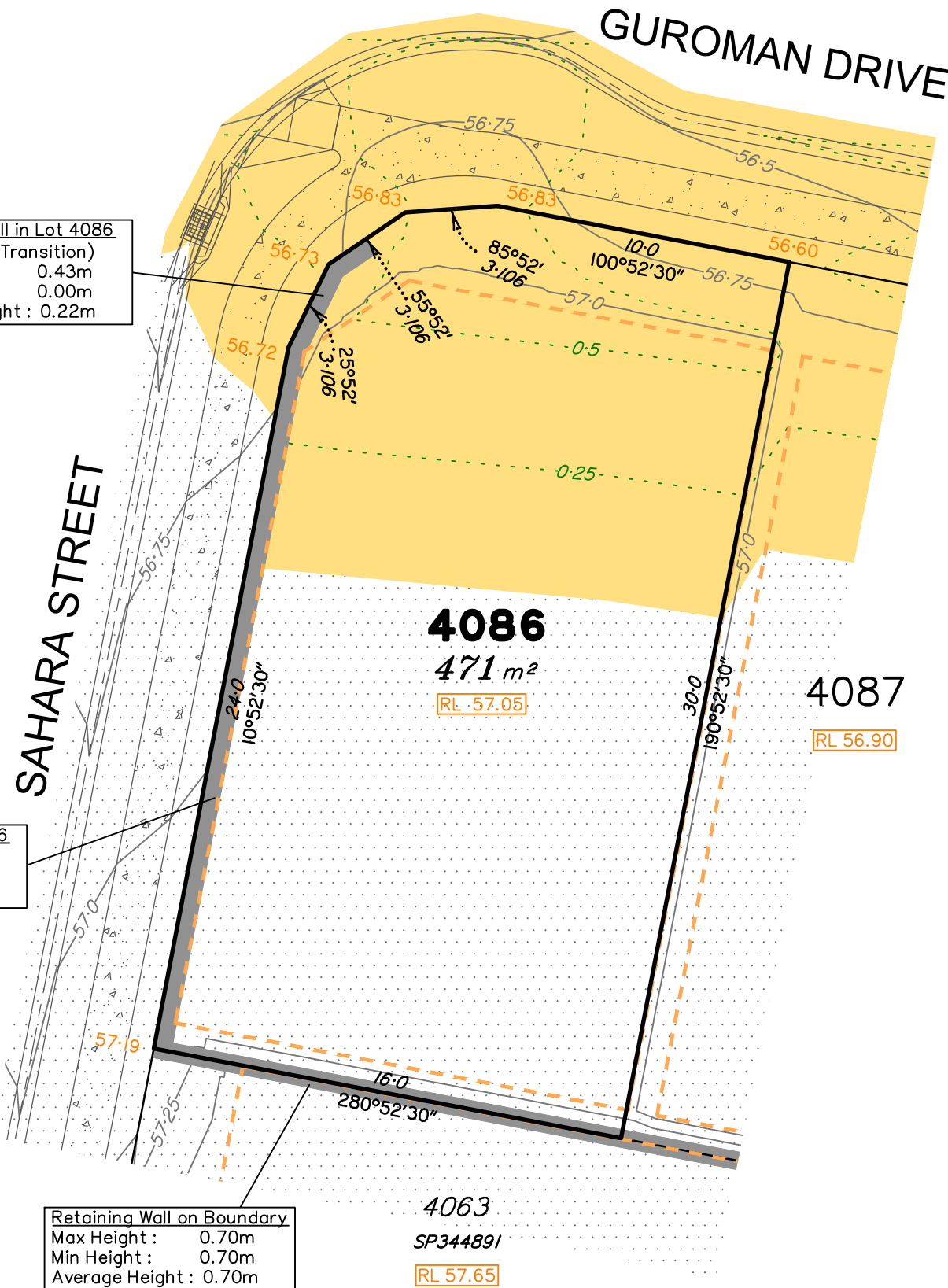

- LEGEND**
- Area of Fill
  - Area of Cut
  - Design Contours
  - Depth of Fill Contours
  - Retaining Wall
  - Tiered Retaining Wall
  - Earthworks Pad
  - RL XX.XX Finished Pad Design Level
  - XX.XX Finished Surface Design Level

(Not all items in this legend may be relevant to the lot shown hereon)

SCALE @A3 1:200 - LENGTHS ARE IN METRES

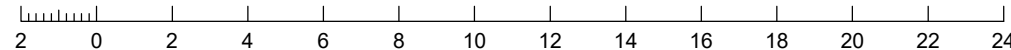

**NOTES**

This plan has been prepared from preliminary survey plan (SP344892) and engineering plans provided on the 26/09/2023 by Premise Civil Engineering Pty Ltd.

The current development approval was granted for this subdivision (DEV2022/12777) by the Minister for Economic Development Queensland on 15th of December 2023.

The relevant authorities have granted operational works approval for the proposed lot.

The purchaser should refer to the applicable development approvals for building and/or other requirements that may be applicable to the lot.

Extent of retaining walls shown indicatively only. Retaining walls may not extend the full length of a lot boundary where finished level between allotments is less than 0.5m.

Parts of this lot may be subject to rip and re-compact earthwork procedures as determined by site conditions. This process may be completed in cut locations to assist the house pad construction. Any re-compaction will comply with AS3798 requirements and certified by a third party company.

All fill shall be placed and compacted in a controlled manner so that Level 1 level of responsibility may be achieved and certified as per AS3798-2007.

No.	by	Date	Chkd	Description
A	MS	08/12/23	PS	Original Issue



Saunders Havill Group Pty Ltd ABN 24 144 972 949  
Brisbane Springfield  
head office 9 Thompson St Bowen Hills Q 4006  
phone 1300 123 SHG web www.saundershavill.com

■ surveying ■ town planning ■ urban design ■ environmental management ■ landscape architecture

This Disclosure Plan is prepared for the sole purpose of satisfying the disclosure requirements of the Land Sales Act and SHOULD NOT be used for any other purpose, particularly as-constructed purposes. This information is compiled from design plans only, unless otherwise stated, and therefore is subject to final survey and construction of operational works.

**Disclosure Plan for Proposed Lot 4086 on SP344892**

Described as part of Lot 9003 on SP334747  
Existing Title Reference: 51337250

Locality of Greenbank (Logan City Council)

Level Datum: AHD der.  
Origin of Levels: PSM 203673  
RL of Origin: 54.070  
Contour Interval: 0.25m  
Scale @A3 1: 200  
Dwg No. 7598 S 61 DP A\_4086