

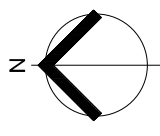

Everleigh



SAHARA STREET

PRECINCT 10.1

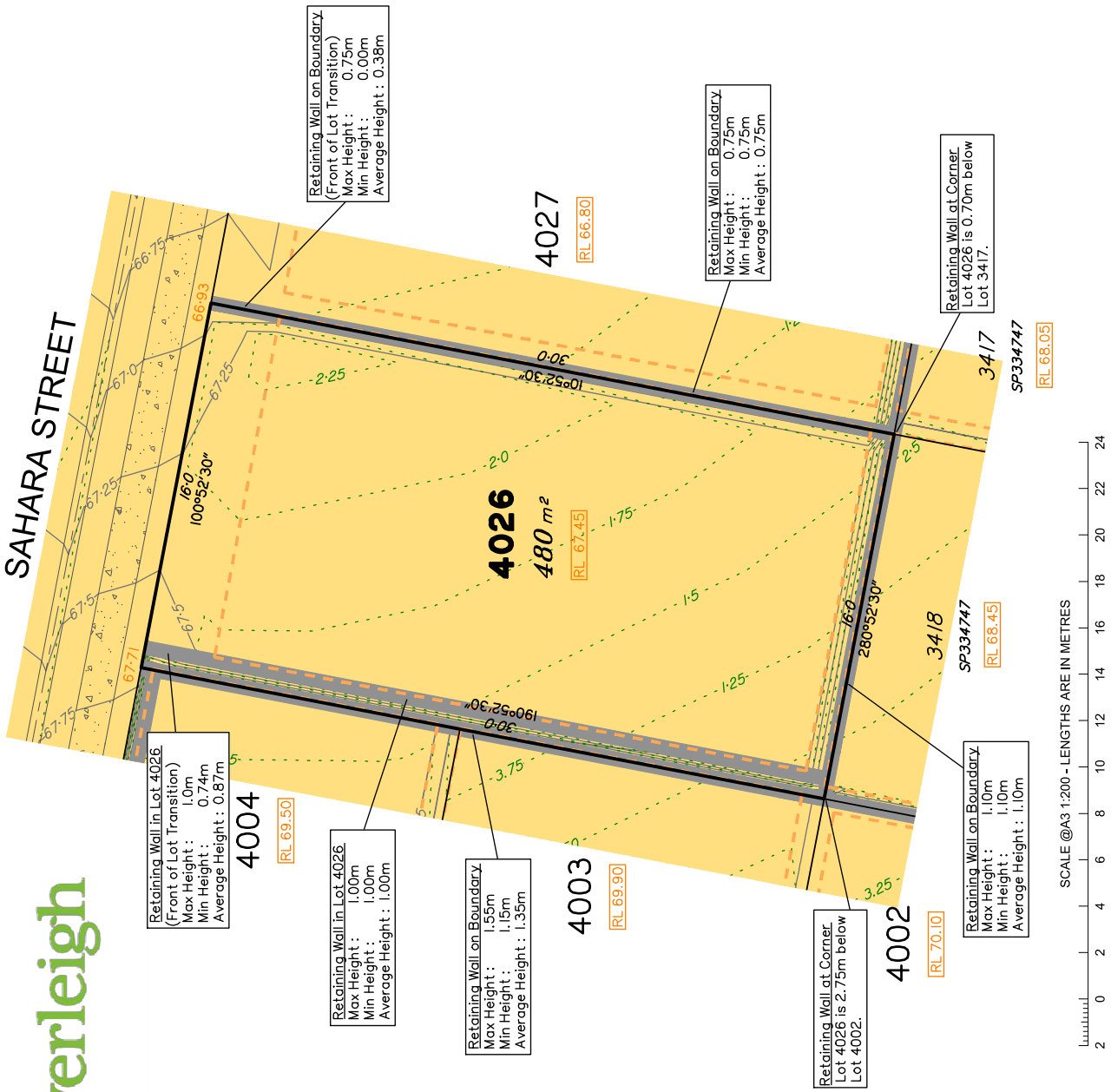

Retaining Wall in Lot 4026
(Front of Lot Transition)
Max Height : 1.0m
Min Height : 0.74m
Average Height : 0.87m

Retaining Wall in Lot 4026
Max Height : 1.00m
Min Height : 1.00m
Average Height : 1.00m

Retaining Wall on Boundary
Max Height : 1.55m
Min Height : 1.15m
Average Height : 1.35m

4000
RL 69.90

Retaining Wall on Boundary
Max Height : 0.75m
Min Height : 0.75m
Average Height : 0.75m

4027
RL 66.80

Retaining Wall at Corner
Lot 4026 is 2.75m below
Lot 4002.

4002
RL 70.10

Retaining Wall on Boundary
Max Height : 1.10m
Min Height : 1.10m
Average Height : 1.10m

Retaining Wall at Corner
Lot 4026 is 0.70m below
Lot 3417.

3417
SP3334747
RL 68.05

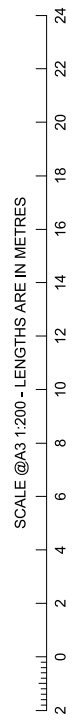

- LEGEND**
- Area of Fill
 - Area of Cut
 - Design Contours
 - Depth of Fill Contours
 - Retaining Wall
 - Tiered Retaining Wall
 - Earthworks Pad
 - Finished Pad Design Level
 - Finished Surface Design Level

(Not all items in this legend may be relevant to the lot shown hereon)

NOTES

This plan has been prepared from preliminary survey plan (SP344891) and engineering plans provided on the 26/09/2023 by Premise Civil Engineering Pty Ltd.
Development approval was granted for this subdivision (DEV2022/1277) by the Minister for Economic Development Queensland on 11th of November 2022.

The relevant authorities have granted operational works approval for the proposed lot.

The purchaser should refer to the applicable development approvals for building and/or other requirements that may be applicable to the lot.

Extent of retaining walls shown indicatively only. Retaining walls may not extend the full length of a lot boundary where finished level between allotments is less than 0.5m.

Parts of this lot may be subject to rip and re-compact earthwork procedures as determined by site conditions. This process may be completed in cut locations to assist the house pad construction. Any re-compaction will comply with AS3798 requirements and certified by a third party company.

All fill shall be placed and compacted in a controlled manner so that Level 1 level of responsibility may be achieved and certified as per AS3798-2007.

No.	by	Date	Chkd	Description
A	MS	11/10/23	PS	Original Issue
Issues				

Level Datum: AHD der.
Origin of Levels: PSM 203673
RL of Origin: 54.070
Contour Interval: 0.25m
Scale @A3 1: 200
Dwg No. 7598 S 60 DP A_4026

Disclosure Plan for Proposed Lot 4026 on SP344891
Described as part of Lot 9003 on SP334746
Existing Title Reference: 51326509
Locality of Greenbank (Logan City Council)

This Disclosure Plan is prepared for the sole purpose of satisfying the disclosure requirements of the Land Sales Act and SHOULD NOT be used for any other purpose, particularly as-constructed purposes. This information is compiled from design plans only, unless otherwise stated, and therefore is subject to final survey and construction of operational works.

Saunders Havill Group Pty Ltd ABN 24 144 972 949
Brisbane # Springfield
head office 9 Thompson St Bowen Hills Q 4006
phone 1800 828 516 web www.saundershavill.com

