

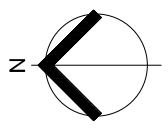

**Everleigh**



**ANDERSON DRIVE**



**PRECINCT 9.7**

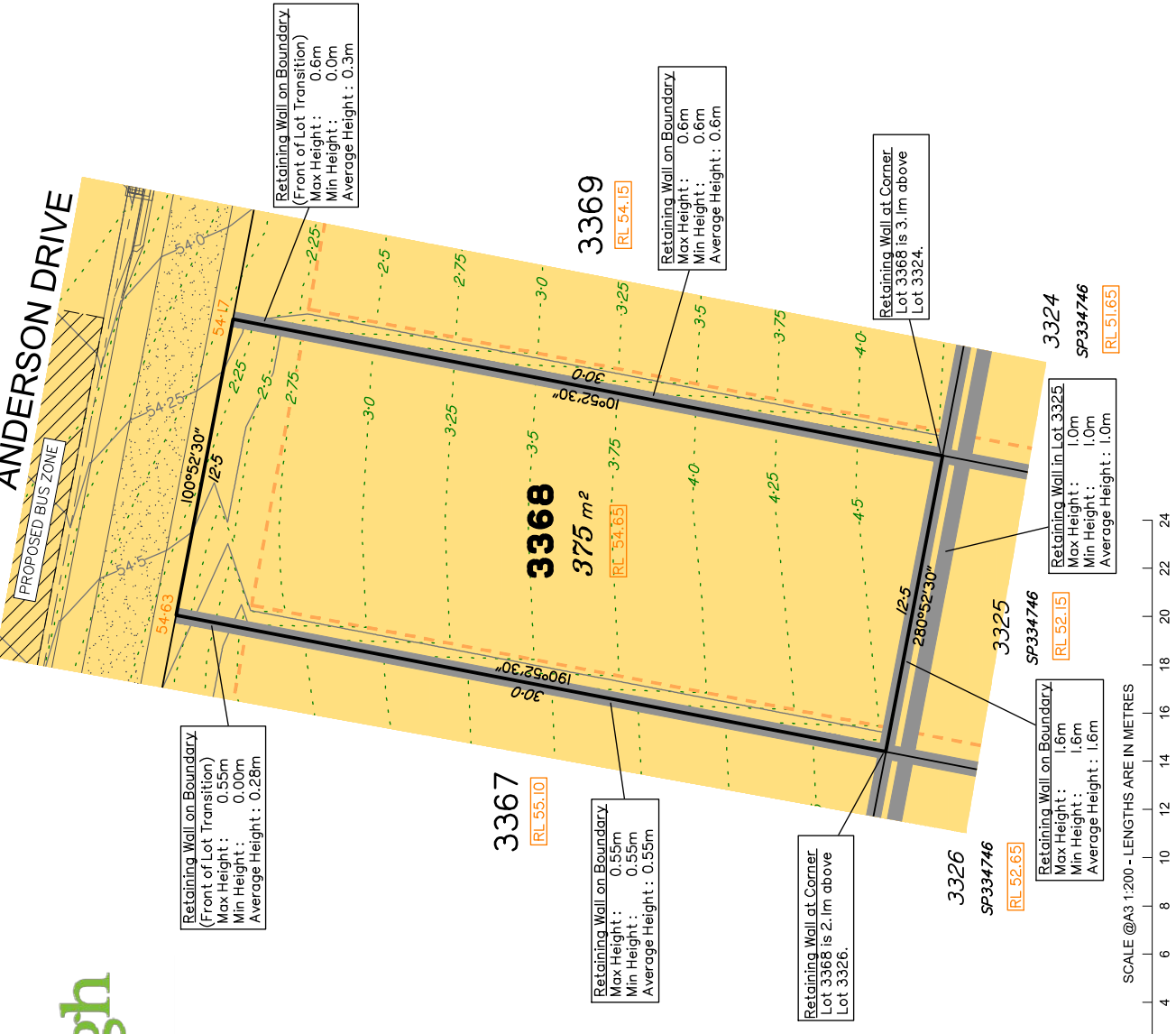

This Disclosure Plan is prepared for the sole purpose of satisfying the disclosure requirements of the Land Sales Act and SHOULD NOT be used for any other purpose, particularly as-constructed purposes. This information is compiled from design plans only, unless otherwise stated, and therefore is subject to final survey and construction of operational works.

Saunders Havill Group Pty Ltd ABN 24 144 972 949  
 Brisbane # Springfield # Rockhampton  
 head office 9 Thompson St Bowen Hills Q 4006  
 phone 1800 123 516 web www.saundershavill.com

**saunders havill group**  
 # surveying # town planning # urban design # environmental management # landscape architecture

**Disclosure Plan for Proposed Lot 3368 on SP334747**  
 Described as part of Lot 9003 on SP334746  
 Existing Title Reference: 51326509  
 Locality of Greenbank (Logan City Council)

Level Datum: AHD der.  
 Origin of Levels: PSM 203673  
 RL of Origin: 54.070  
 Contour Interval: 0.25m  
 Scale @A3: 1:200  
 Dwg No. 7598 S 55 DP B\_3368

**NOTES**

This plan has been prepared from preliminary survey plan (SP334747), engineering plans provided on the 06/02/2023 by Premise Civil Engineering Pty Ltd and advice received by Mirvac on 21/11/2023.  
 Development approval was granted for this subdivision (DEV2020/1160) by the Minister for Economic Development Queensland on 26th of August 2021.

The relevant authorities have granted operational works approval for the proposed lot.

The purchaser should refer to the applicable development approvals for building and/or other requirements that may be applicable to the lot.

Extent of retaining walls shown inductively only. Retaining walls may not extend the full length of a lot boundary where finished level between allotments is less than 0.5m.

All fill shall be placed and compacted in a controlled manner so that Level 1 level of responsibility may be achieved and certified as per AS3798-2007.

**LEGEND**

- Area of Fill
- Area of Cut
- Proposed Bus Zone Area
- Design Contours
- Depth of Fill Contours
- Retaining Wall
- Tiered Retaining Wall
- Earthworks Pad
- Finished Pad Design Level
- Finished Surface Design Level

(Not all items in this legend may be relevant to the lot shown hereon)

SCALE @A3 1:200 - LENGTHS ARE IN METRES



No.	by	Date	Chkd	Description
A	MS	24/05/23	LMF	Original Issue
B	TG	24/11/23	TG	Proposed Bus Zone in Anderson Dr added.