

**Premise Reviewed & Accepted**  
Subject to the Red Pen mark-ups by Premise are addressed

**LEGEND**

- CL400 SUBSOIL DRAIN
- SUBSOIL DRAINAGE OUTLET PIT
- ✕ SUBSOIL DRAIN STUB FOR FUTURE CONNECTION

**LEGEND - PROPOSED**

- PROPOSED IPWEA TYPE 'M3' KERB & CHANNEL. REFER IPWEA STD DWG RS-080.
- PROPOSED IPWEA TYPE 'B1' KERB & CHANNEL. REFER IPWEA STD DWG RS-080.
- PROPOSED IPWEA TYPE 'B2' KERB. REFER IPWEA STD DWG RS-080.
- PROPOSED IPWEA TYPE 'ER1' EDGE RESTRAINT. REFER IPWEA STD DWG RS-080.
- PROPOSED IPWEA TYPE 'INV' CHANNEL. REFER IPWEA STD DWG RS-080.
- PROPOSED 1.5m WIDE (U.N.O.) CONCRETE FOOTPATH. REFER LCC STD DWGS.
- PROPOSED KERB RAMP. REFER IPWEA STD DWG RS-090.
- DURATHEM THRESHOLD TREATMENT COLOUR - LIME GREEN (EX BRICK'N PAVE CODE 603B) PATTERN - HONEYCOMB
- PROPOSED STORMWATER
- PROPOSED STORMWATER STRUCTURE No.
- ROOFWATER DRAINAGE KERB ADAPTORS WITH TWIN 125x75 GALVANISED RHS. REFER DETAIL ON DWG C400.
- ROOFWATER DRAINAGE KERB ADAPTORS. REFER DETAIL ON DWG C400.
- ROOFWATER DRAINAGE KERB ADAPTORS & PROPERTY PIT. REFER DETAIL ON DWG C400.
- PROPOSED ROOFWATER HOUSE CONNECTION (150 Ø uPVC)
- PROPOSED RETAINING WALL
- ZERO LOT BOUNDARY
- PROPOSED FUTURE DRIVEWAY LOCATION
- PROPOSED SEWER
- PROPOSED WATER
- PROPOSED ELECTRICAL
- PROPOSED WATER CONDUIT
- PMT PAD MOUNTED TRANSFORMER
- PROPOSED LANDSCAPING WITHIN VERGE. CONCRETE EDGE RESTRAINT BY LANDSCAPING CONTRACTOR. CIVIL CONTRACTOR TO COORDINATE WITH LANDSCAPING CONTRACTOR TO CARRY OUT THEIR WORKS. REFER TO LANDSCAPE DRAWINGS FOR FURTHER DETAIL.

**LEGEND - CONSTRUCTED**

- STORMWATER
- SEWER
- WATER
- ELECTRICAL
- TELSTRA
- GAS
- RISING MAIN
- RETAINING WALL
- STORMWATER STRUCTURE No.

JOINS DRAWING C101

**STORMWATER TRENCH BACKFILL NOTE:**  
ALL STORMWATER TRENCH BACKFILL MATERIAL SHALL BE SOURCED FROM ON SITE EXCAVATED MATERIAL.

FOR TYPICAL SECTIONS AND NOTES REFER TO DRAWING No. C300 - ROADWORKS TYPICAL SECTIONS AND NOTES, AND DRAWING No. C400 - STORMWATER DRAINAGE DETAILS AND NOTES.

**PAVEMENT SUBGRADE GUARANTEE:**  
CONTRACTOR SHALL UNDERTAKE EARTHWORKS REQUIRED IN EITHER CUT OR FILL TO ENSURE THE SUBGRADE QUALITY IS AT CBR10 OR GREATER. CONTRACTOR TO LIAISE WITH OWN GEOTECHNICAL ENGINEER TO ACHIEVE REQUIREMENT.

**FOR CONSTRUCTION**

DATE	REV	DESCRIPTION	REVISIONS
15/01/2022	B	AMENDED TEXT AND ADDED ELECTRICAL LINework	KK PB
15/10/2021	A	ORIGINAL ISSUE	VKH PB

**Premise**

BRISBANE OFFICE  
LEVEL 11, 300 ADELAIDE STREET  
BRISBANE, QLD 4000  
PH: (07) 3253 2222  
WEB: www.premise.com.au

DESIGNED: K KIWIANG  
CHECKED: R BARGER  
PROJECT MANAGER: S STEINHOFER  
PROJECT DIRECTOR: PATRICK BRADY

SCALE: 1:500 (A1)

0 10 20 30m

SCALE 1:500 (A1)

ORIGINAL SHEET SIZE A1

CLIENT: MIRVAC QLD PTY LTD

PROJECT: EVERLEIGH PRECINCT 9.3A, B, C, D, E SUBDIVISION DEVELOPMENT

LOCATION: TEVIOT ROAD, GREENBANK

SHEET TITLE: ROADWORKS AND DRAINAGE LAYOUT - SHEET 1 OF 2

RECEIVED  
By Document Control at 1:51 pm, Jan 19, 2022

JOB CODE: MIR009-03

SHEET NUMBER	REV
C100	B



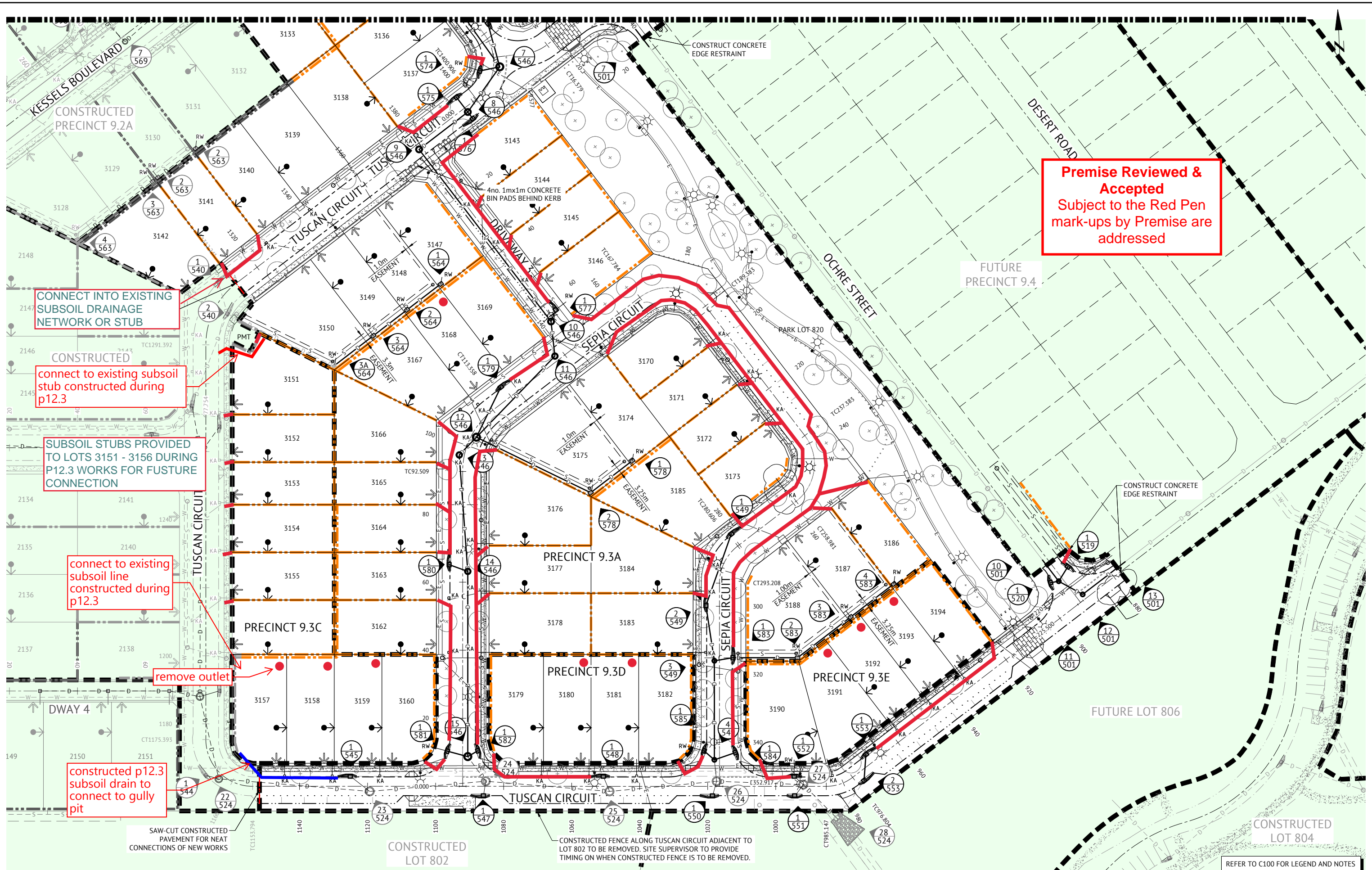

**Premise Reviewed & Accepted**  
 Subject to the Red Pen mark-ups by Premise are addressed

CONNECT INTO EXISTING SUBSOIL DRAINAGE NETWORK OR STUB

connect to existing subsoil stub constructed during p12.3

SUBSOIL STUBS PROVIDED TO LOTS 3151 - 3156 DURING P12.3 WORKS FOR FUTURE CONNECTION

connect to existing subsoil line constructed during p12.3

remove outlet

constructed p12.3 subsoil drain to connect to gully pit

**FOR CONSTRUCTION**

DATE	REV	DESCRIPTION	KK	PB
15/01/2022	B	MOVED KERB ADAPTOR, AND ADDED DRIVEWAY AND ELECTRICAL LINEWORK	KK	PB
15/10/2021	A	ORIGINAL ISSUE	VKH	PB
			REC	APP



**BRISBANE OFFICE**  
 LEVEL 11, 300 ADELAIDE STREET  
 BRISBANE, QLD 4000  
 PH: (07) 3253 2222  
 WEB: www.premise.com.au

DESIGNED  
**K KIWANG**  
 CHECKED  
**R BARGER**  
 PROJECT MANAGER  
**S STEINHOFER**  
 PROJECT DIRECTOR  
**PATRICK BRADY**  
 RPEQ 7112

SCALE  
 0 10 20 30m  
 SCALE 1:500 (A1)  
 ORIGINAL SHEET SIZE A1

CLIENT  
**MIRVAC QLD PTY LTD**  
 PROJECT  
**EVERLEIGH PRECINCT 9.3A, B, C, D, E SUBDIVISION DEVELOPMENT**  
 LOCATION  
**TEVIOT ROAD, GREENBANK**  
 SHEET TITLE  
**ROADWORKS AND DRAINAGE LAYOUT - SHEET 2 OF 2**

**RECEIVED**  
 By Document Control at 1:51 pm, Jan 19, 2022

JOB CODE  
**MIR009-03**  
 SHEET NUMBER  
**C101**  
 REV  
**B**