

NOTES

This plan has been prepared from preliminary survey plan (SP334746) and engineering plans provided on the 06/02/2023 by Premise Civil Engineering Pty Ltd.

Development approval was granted for this subdivision (DEV2020/1160) by the Minister for Economic Development Queensland on 26th of August 2021.

The relevant authorities have granted operational works approval for the proposed lot.

The purchaser should refer to the applicable development approvals for building and/or other requirements that may be applicable to the lot.

All fill shall be placed and compacted in a controlled manner so that Level 1 level of responsibility may be achieved and certified as per AS3798-2007.

Extent of retaining walls shown indicatively only. Retaining walls may not extend the full length of a lot boundary where finished level between allotments is less than 0.5m.

No.	by	Date	Checked	Description
A	MS	31/03/23	LMP	Original Issue

Level Datum: AHD der.
 Origin of Levels: PSM 2003673
 RL of Origin: 54.070
 Contour Interval: 0.25m
 Scale @A3: 1:200
 Dwg No. 7598 S 54 DP A_3314

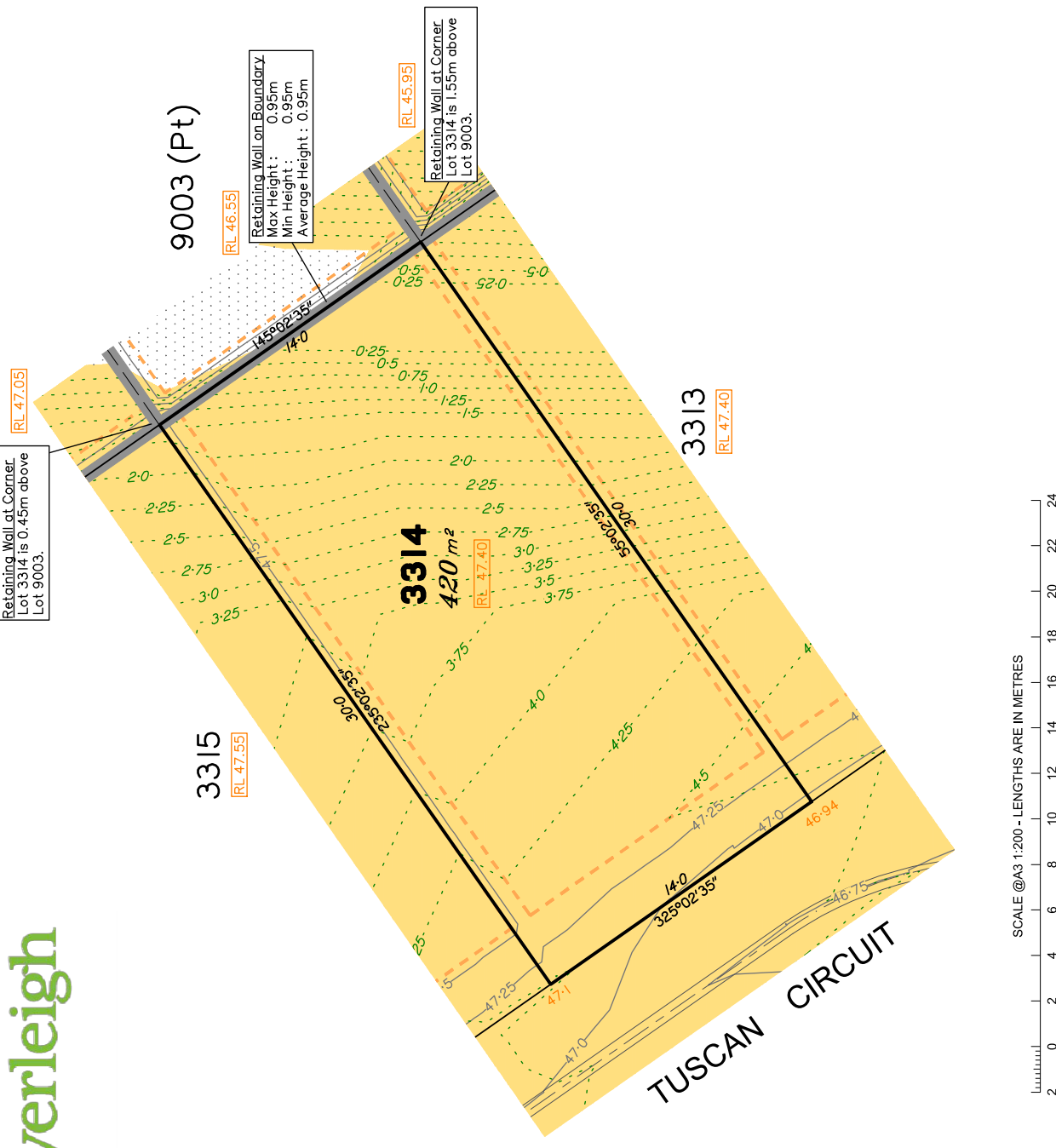

Retaining Wall at Corner
 Lot 3314, is 0.45m above
 Lot 9003.

Retaining Wall on Boundary
 Max Height : 0.95m
 Min Height : 0.95m
 Average Height : 0.95m

Retaining Wall at Corner
 Lot 3314 is 1.55m above
 Lot 9003.

Everleigh

SCALE @A3 1:200 - LENGTHS ARE IN METRES

This Disclosure Plan is prepared for the sole purpose of satisfying the disclosure requirements of the Land Sales Act and SHOULD NOT be used for any other purpose, particularly as-constructed purposes. This information is compiled from design plans only, unless otherwise stated, and therefore is subject to final survey and construction of operational works.

Disclosure Plan for Proposed Lot 3314 on SP334746
 Described as part of Lot 9002 on SP338104
 Existing Title Reference: 51310819
 Locality of Greenbank (Logan City Council)

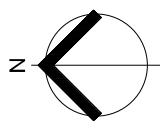

- LEGEND**
- Area of Fill
 - Area of Cut
 - Design Contours
 - Depth of Fill Contours
 - Retaining Wall
 - Tiered Retaining Wall
 - Earthworks Pad
 - Finished Pad Design Level
 - Finished Surface Design Level
 - XX.XX
- (Not all items in this legend may be relevant to the lot shown hereon)

Saunders Havill Group Pty Ltd ABN 24 144 972 949
 Brisbane # Springfield # Rockhampton
 head office 9 Thompson St Bowen Hills Q 4006
 phone 1800 123 516 web www.saundershavill.com

saunders havill group
 # surveying # town planning # urban design # environmental management # landscape architecture