

EVERLEIGH EARTHWORKS TOLERANCE TABLE

ITEM	TOLERANCE
EARTHWORKS IN ALLOTMENTS AND VERGES ^(a)	FSL +/- 50mm
CUT BATTERS (OTHER THAN IN LOTS)	FSL +/- 150mm ^(b)
FILL BATTERS (OTHER THAN IN LOTS)	FSL +/- 300mm ^(b)
EARTHWORKS IN PARKS	EWL +/- 50mm

^(a) TOLERANCE IS -0mm / +50mm WHERE ADJACENT DRAINAGE ELEMENT.
^(b) MEASURED FROM THE AVERAGE SLOPE PLANE.

TOLERANCE NOTES

1. EARTHWORKS LEVEL (EWL) IS 100mm BELOW FINISHED SURFACE LEVEL (FSL).
2. FINISHED SURFACE LEVEL (FSL) IS TOP OF TURF / STABILISED TOPSOIL LEVEL.
3. ROADWORKS SUBGRADE, PAVEMENT, ASPHALT CONSTRUCTION LEVEL TOLERANCES AS PER LCC PSP No. 5.
4. STORMWATER DRAINAGE CONSTRUCTION LEVEL TOLERANCES AS PER LCC PSP No. 5.
5. SEWER AND WATER RETICULATION CONSTRUCTION LEVEL TOLERANCES AS PER SEQ D & C CODE.

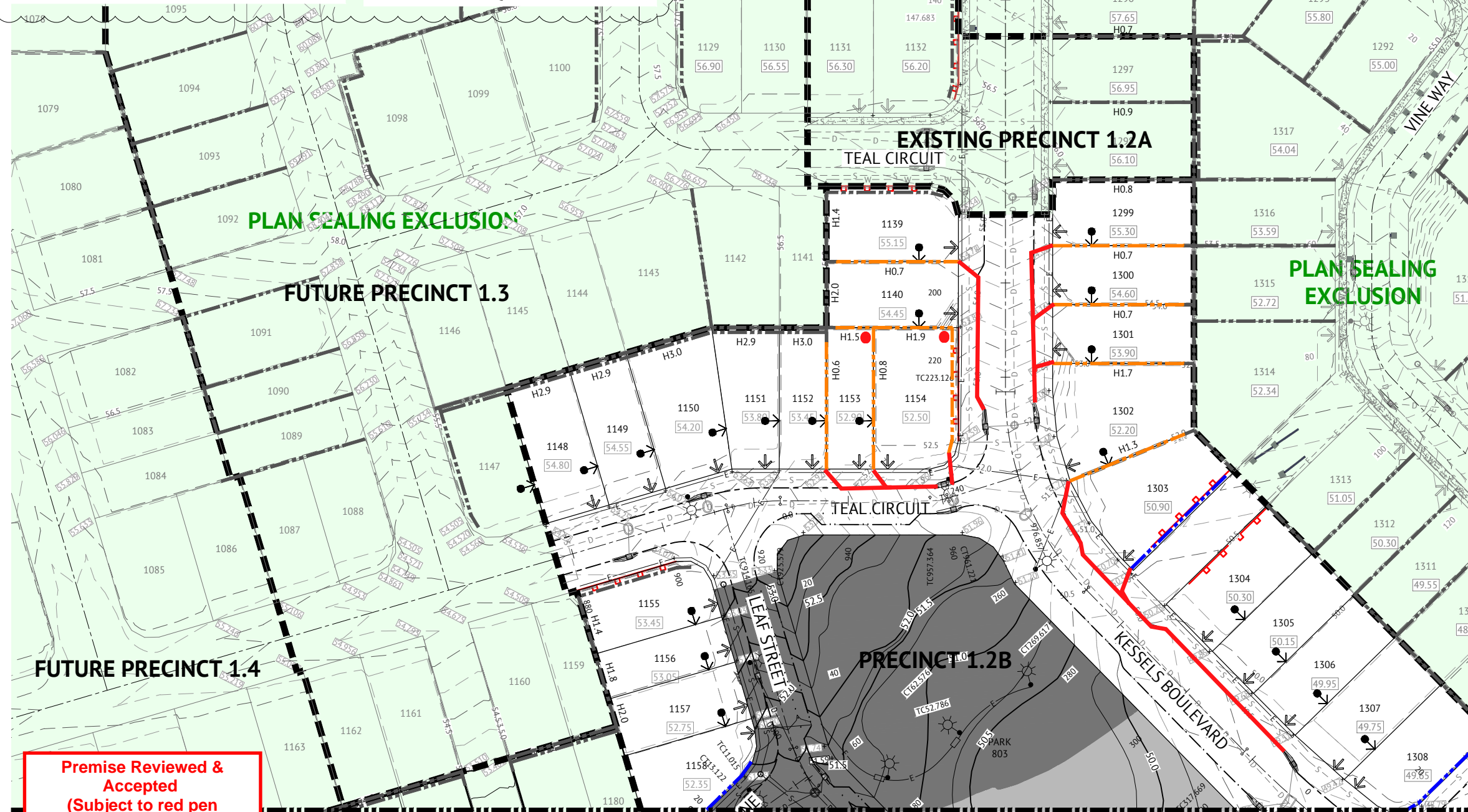

LEGEND - PROPOSED

- EXTENT OF CUT
- EXTENT OF FILL
- 12.0 FINISHED MAJOR CONTOURS (0.50m)
- FINISHED MINOR CONTOURS (0.10m)
- 55.50 FINISHED SURFACE PAD LEVEL
- H1.0 PROPOSED CONCRETE SLEEPER RETAINING WALL (AND HEIGHT). TIMBER TEXTURED SLEEPERS AND 2 COAT PAINT. DESIGN SPECIFICATION BY MANUFACTURER
- H1.0 PROPOSED CONCRETE PANEL RETAINING WALL (AND HEIGHT). 2 COAT TEXTURED PAINT. DESIGN SPECIFICATION BY MANUFACTURER
- PROPOSED MASONRY WALL TO ENERGEX STANDARDS
- FEATURE FENCE ON TOP OF RETAINING WALL BY LANDSCAPER
- 58.25+ FOOTPATH SPOT LEVEL
- ZERO LOT LINE
- STAGE BOUNDARY

LEGEND - EXISTING

- EXISTING RETAINING WALL
- 12.0 EXISTING CONTOURS (0.50m)
- EXISTING STORMWATER
- EXISTING SEWER
- EXISTING WATER
- EXISTING ELECTRICITY
- EXISTING TELECOMMUNICATIONS
- EXISTING GAS

RETAINING WALL DESIGN:

ALL RETAINING WALLS SHALL BE DESIGNED & CONSTRUCTED IN ACCORDANCE WITH THE "DESIGN AND CONSTRUCTION RETAINING WALL SPECIFICATION" PREPARED BY PREMISE ENGINEERING.

NOTES

1. REFER BULK EARTHWORKS NOTES AND DETAILS DRAWINGS.
2. PROPOSED SERVICES WITHIN THE VICINITY OF RETAINING WALLS. REFER SERVICE DRAWINGS FOR SERVICE LOCATIONS.
3. EXISTING DWELLINGS, FENCES ETC. TO BE DEMOLISHED & REMOVED OFF SITE BY OTHERS.
4. FINAL RETAINING WALL TYPES TO BE CONFIRMED BY DEVELOPER PRIOR TO CONSTRUCTION.
5. FOR TYPICAL SECTIONS AND NOTES REFER TO DRAWING No. C205 - EARTHWORKS NOTES AND DETAILS.

PROPERTY SERVICES UNDER RETAINING WALLS:

CONTRACTOR SHALL REFER TO ALL LATEST SERVICE DRAWINGS TO ENSURE PROVISIONS ARE MADE FOR ALL PROPERTY SERVICE CONNECTIONS UNDER RETAINING WALLS.

PAD MOUNTED TRANSFORMER NOTE

- RETAINING WALLS AND THEIR FOOTINGS SHALL NOT ENCRoACH INTO THE PMT SITE (AS PER RETAINING WALLS LOCATED ADJACENT ROAD RESERVES DETAIL).
- RETAINING WALL DESIGN SHALL CONSIDER ENERGEX REQUIREMENT WHERE RETAINING WALLS ARE LOCATED WITHIN 2m OF PMT SITE.

Premise Reviewed & Accepted
 (Subject to red pen comments)
 18-08-2020

TRENCH EXCAVATION AND SPOIL:

ALL TRENCH EXCAVATIONS SHALL INCLUDE TREATING, SIZING, CONDITIONING AND PROCESSING OF ALL TYPES OF ROCK. CONTRACTOR SHALL PLACE ALL EXCESS TRENCH SPOIL TO A LOCATION NOMINATED BY THE SUPERINTENDENT INCLUDING ALL LEVEL ONE COMPACTION REQUIREMENTS AND TESTING, AND MUST BE FREE-DRAINING. THE PLACEMENT OF THE SPOIL SHALL MEET ALL REQUIREMENTS OF THE FILL SPECIFICATION PROVIDED WITHIN THESE PROJECT DRAWINGS.

DISPERSIVE SOILS MANAGEMENT NOTES:

1. STABILISATION OF DISTURBED AREAS AND MANAGEMENT OF EROSION AND SEDIMENT SHALL BE UNDERTAKEN IN ACCORDANCE WITH THE EROSION AND SEDIMENT CONTROL PLANS IN THIS DRAWING SET.
2. CONTRACTOR MUST CONSTRUCT AND ESTABLISH THE EROSION AND SEDIMENT CONTROL DEVICES, CONSTRUCTION WATER HOLDING DAM AND HES BASIN PRIOR TO COMMENCING EARTHWORKS OPERATION.
3. ALL DISTURBED AREAS SHALL BE STABILISED AS SOON AS PRACTICABLE (BUT NOT MORE THAN 10 DAYS) FOLLOWING FINALISATION OF LEVELS. STABILISATION TO BE IN ACCORDANCE WITH DRAWING C405 - EROSION & SEDIMENT CONTROL - STABILISATION PHASE.

RETAINING WALL SHOP DRAWINGS

CONTRACTOR MUST PREPARE RETAINING WALL SHOP DRAWINGS FOR APPROVAL BY SUPERINTENDENT PRIOR TO COMMENCING RETAINING WALL CONSTRUCTION. SHOP DRAWINGS ARE TO DETAIL THE FOLLOWING ELEMENTS:

- ELEVATIONS OF ALL PROPOSED RETAINING WALLS AND ACOUSTIC FENCES
- TOP AND BOTTOM RLS TO SLEEPER/PANEL FINISHED PAD/ROAD SURFACE LEVELS
- DIMENSIONS OF RETAINING WALL END FINISHING CONFIGURATION, OFFSETS FROM BOUNDARIES
- POST DETAILS FOR INTRICATE INTERSECTION POINTS

RETAINING WALL SUBSOIL DRAINAGE OUTLET DESIGN:

RETAINING WALL SUBSOIL DRAINAGE PIPE OUTLET LOCATIONS SHALL BE IN ACCORDANCE WITH THE EVERLEIGH RETAINING WALL DESIGN SPECIFICATION. THE PRINCIPAL CIVIL CONTRACTOR SHALL DETERMINE THE LOCATION OF RETAINING WALL SUBSOIL DRAINAGE PIPES IN ACCORDANCE WITH THE EVERLEIGH RETAINING WALL DESIGN SPECIFICATION AND PROVIDE PROPOSAL TO THE SUPERINTENDENT FOR APPROVAL PRIOR TO COMMENCING RETAINING WALL CONSTRUCTION.

FOR CONSTRUCTION	<p>BRISBANE OFFICE LEVEL 1, 100 BRUNSWICK STREET PO BOX 361 FORTITUDE VALLEY, QLD 4006 PH: (07) 3253 2222 WEB: www.premise.com.au</p>	<p>DESIGNED: MICHAEL MAJZNER CHECKED: MICHAEL MAJZNER PROJECT MANAGER: JOSHUA STONE PROJECT DIRECTOR: JOSHUA STONE</p>	<p>RPEQ: JOSHUA STONE DATE: RPEQ 15187</p> <p>SCALE: 1:500 (A1)</p>	<p>CLIENT: MIRVAC</p> <p>PROJECT: EVERLEIGH PRECINCT 1.2B SUBDIVISION DEVELOPMENT</p> <p>LOCATION: TEVIOT ROAD, GREENBANK</p> <p>SHEET TITLE: EARTHWORKS LAYOUT PLAN - SHEET 1 OF 3</p>	<p>JOB CODE: MIR001-02B</p> <p>SHEET NUMBER: C200</p> <p>REV: C</p>
-------------------------	---	---	--	---	--

DATE	REV	DESCRIPTION
25/03/20	C	ADDED NOTES
08/08/18	B	PAD FRONT BDY OFFSET REDUCED TO 3M & MINOR EARTHWORKS ALONG P1.1 INTERFACE WITH LOTS
02/07/18	A	ORIGINAL ISSUE



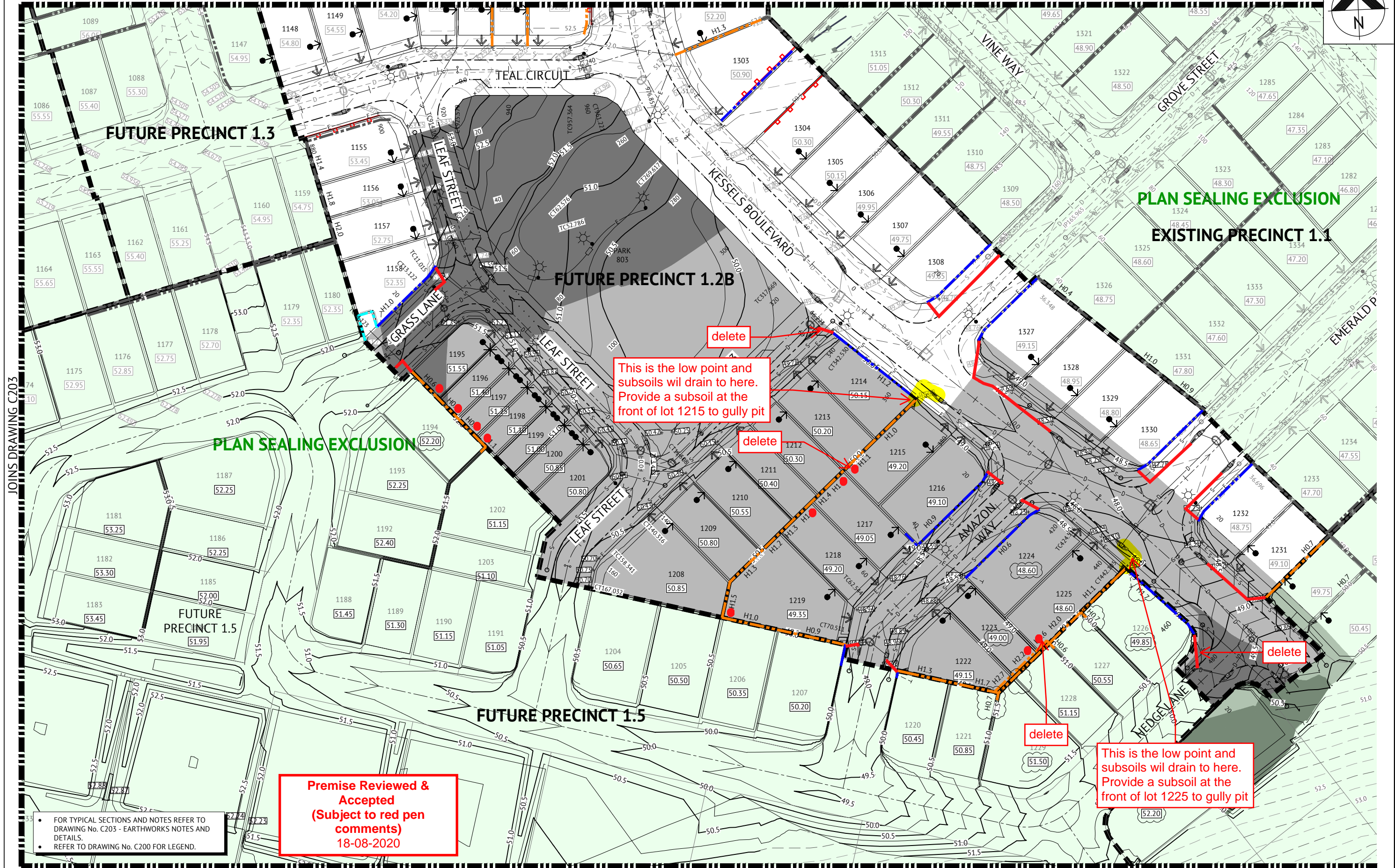
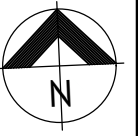

<p>FOR CONSTRUCTION</p>		<p>BRISBANE OFFICE LEVEL 1, 100 BRUNSWICK STREET PO BOX 361 FORTITUDE VALLEY, QLD 4006 PH: (07) 3253 2222 WEB: www.premise.com.au</p>	<p>DESIGNED: MICHAEL MAJZNER</p> <p>CHECKED: MICHAEL MAJZNER</p> <p>PROJECT MANAGER: JOSHUA STONE</p> <p>PROJECT DIRECTOR: JOSHUA STONE</p>	<p>RPEQ: JOSHUA STONE</p> <p>RPEQ: RPEQ 15187</p> <p>SCALE: 1:500 (A1)</p>	<p>CLIENT: MIRVAC</p> <p>PROJECT: EVERLEIGH PRECINCT 1.2B SUBDIVISION DEVELOPMENT</p> <p>LOCATION: TEVIOT ROAD, GREENBANK</p> <p>SHEET TITLE: EARTHWORKS LAYOUT PLAN - SHEET 2 OF 3</p>	<p>JOB CODE: MIR001-02B</p> <p>SHEET NUMBER: C201</p> <p>REV: D</p>
<p>16/06/20 D ADJUSTED PAD LEVELS, DELETED RET WALL STUB BETWEEN 1228/1229</p> <p>25/03/20 C AMENDED CUT AND FILL HATCHES AND CONTOURS</p> <p>08/08/18 B PAD FRONT BODY OFFSET REDUCED TO 3M & MINOR EARTHWORKS ALONG P1.1 INTERFACE WITH LOTS</p> <p>02/07/18 A ORIGINAL ISSUE</p>	<p>DATE: 18/08/2020</p> <p>REV: 1</p> <p>DESCRIPTION: PREMISE REVIEWED & ACCEPTED (SUBJECT TO RED PEN COMMENTS)</p> <p>REVISIONS:</p>		<p>RECEIVED</p> <p>By Document Control at 10:44 am, Jun 18, 2020</p>			