

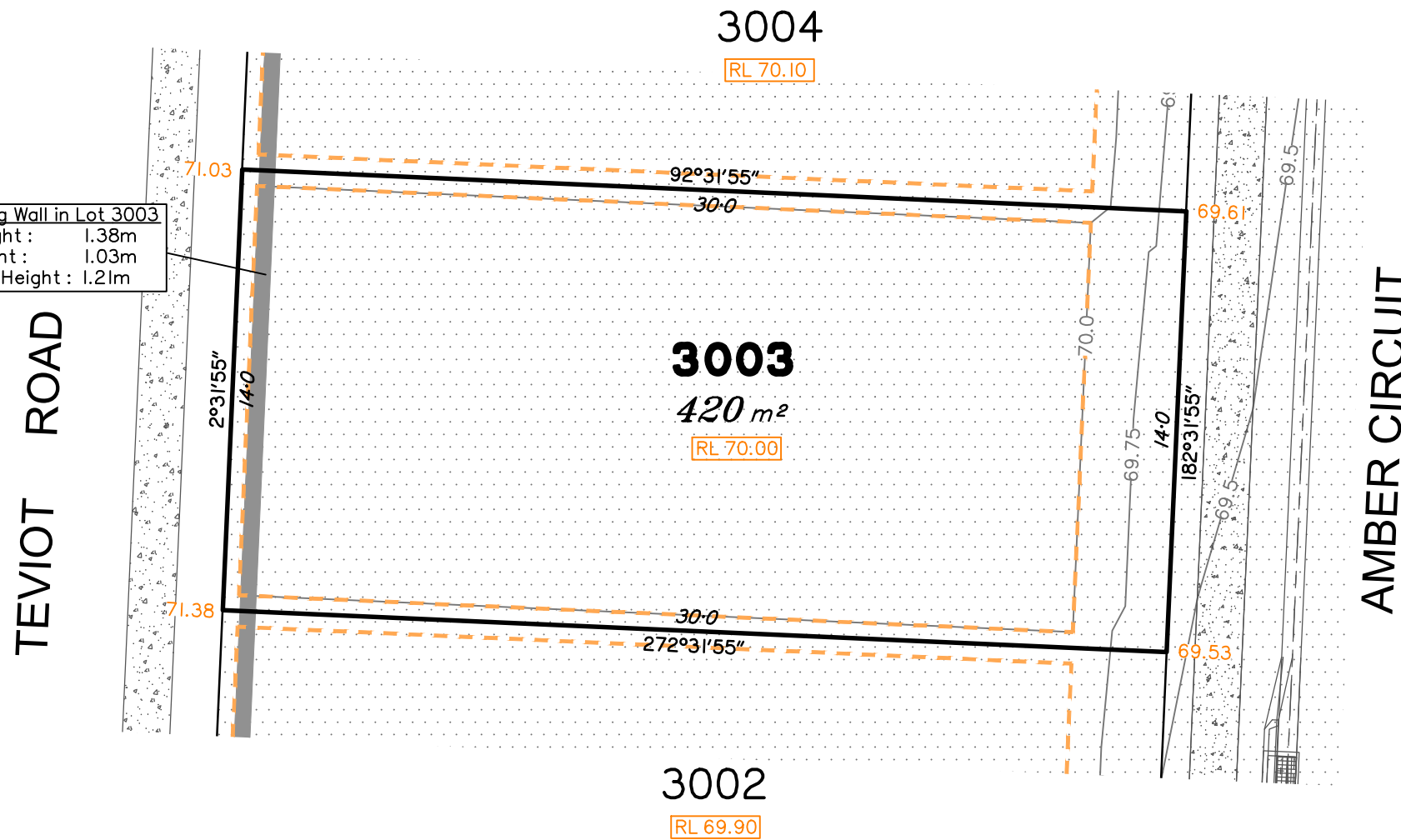

# Everleigh

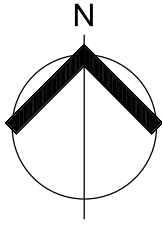

Retaining Wall in Lot 3003  
 Max Height : 1.38m  
 Min Height : 1.03m  
 Average Height : 1.21m

- LEGEND**
- Area of Fill
  - Area of Cut
  - Design Contours
  - Depth of Fill Contours
  - Retaining Wall
  - Tiered Retaining Wall
  - Earthworks Pad
  - RL XX.XX Finished Pad Design Level
  - XX.XX Finished Surface Design Level

(Not all items in this legend may be relevant to the lot shown hereon)

SCALE @A3 1:200 - LENGTHS ARE IN METRES

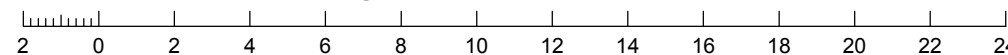

PRECINCT 9.1



**NOTES**

This plan has been prepared from preliminary survey plan (SP327532) and engineering plans provided on the 02/09/2021 by Premise Engineering Pty Ltd.

Development approval was granted for this subdivision (DEV2020/1160) by the Minister for Economic Development Queensland on 26th of August 2021.

The relevant authorities have granted operational works approval for the proposed lot.

The purchaser should refer to the applicable development approvals for building and/or other requirements that may be applicable to the lot.

All fill shall be placed and compacted in a controlled manner so that Level 1 level of responsibility may be achieved and certified as per AS3798-2007.

Parts of this lot may be subject to rip and re-compact earthwork procedures as determined by site conditions. This process may be completed in cut locations to assist the house pad construction. Any re-compaction will comply with AS3798 requirements and certified by a third party company.

No.	by	Date	Chkd	Description
A	TBG	14/09/21	CU	Original Issue



Saunders Havill Group Pty Ltd ABN 24 144 972 949  
 Brisbane Springfield Rockhampton  
 head office 9 Thompson St Bowen Hills Q 4006  
 phone 1300 123 SHG web www.saundershavill.com

■ surveying ■ town planning ■ urban design ■ environmental management ■ landscape architecture

This Disclosure Plan is prepared for the sole purpose of satisfying the disclosure requirements of the Land Sales Act and SHOULD NOT be used for any other purpose, particularly as-constructed purposes. This information is compiled from design plans only, unless otherwise stated, and therefore is subject to final survey and construction of operational works.

## Disclosure Plan for Proposed Lot 3003 on SP327532

Described as part of Lot 9003 on SP323156  
 Existing Title Reference: 51257297

Locality of Greenbank (Logan City Council)

Level Datum: AHD der.  
 Origin of Levels: PSM 203673  
 RL of Origin: 54.070  
 Contour Interval: 0.25m

Scale @A3 1: 200  
 Dwg No. 7598 S 41 DP A\_3003