

**LEGEND - PROPERTY SERVICE CONNECTIONS**

- W** WATER - POLY SERVICE FROM WATER MAIN, METER BOX & COVER INSTALLED. BUILDER TO MAKE APPLICATION TO LOGAN CITY COUNCIL FOR METER ASSEMBLY SUPPLY AND INSTALLATION. WHERE WATER METER IS LOCATED BEHIND RETAINING WALL, 25mm POLYPIPE WILL BE SUPPLIED UNDER WALL INTO LOT AND WILL BE MARKED WITH 900x50x25 HW STAKE LABELLED "WATER."
- S** SEWER - CAPPED Ø100 PVC PIPE (BURIED MAX 1.5m). MARKED WITH 40Ø ORANGE PVC CONDUIT AT SURFACE (BURIED TO CAPPED PIPE). CONDUIT LABELLED "SEWER."
- RW** ROOFWATER - CONNECTION LOCATION CAN BE EITHER FRONT OF LOT VIA KERB ADAPTOR OUTLET TO ROAD, OR REAR OF LOT INTO ROOFWATER DRAINAGE PIPE VIA PIT. CAPPED PVC Ø100 PIPES (BURIED MAX 1.5m) MARKED WITH 900x50x25 HW STAKE LABELLED "ROOFWATER."
- SSD** RETAINING WALL SUB-SOIL DRAINAGE - OUTLET POINT TO LOT FOR RETAINING WALL SUB-SOIL DRAINAGE TO BE CONNECTED TO YARD DRAINAGE BY BUILDER. Ø100 NON-SLOTTED AGG PIPE CAPPED AND TERMINATED 200m ABOVE SURFACE. PVC DUCT TAPED TO 900x50x25 HW STAKE LABELLED "RETAINING WALL SUBSOIL OUTLET".
- T** TELECOMMUNICATIONS/NBN - PVC CONDUIT (BURIED APPROX 300mm). MARKED WITH 900x50x25 HW STAKE LABELLED "TELECOMMS".
- E** ELECTRICITY - ELECTRICITY PILLAR EXISTS IN ROAD VERGE. BUILDER TO MAKE APPLICATION WITH ENERGY PROVIDER FOR SERVICE INSTALLATION TO LOT. WHERE ELECTRICITY PILLAR IS LOCATED BEHIND RETAINING WALL, CONDUIT WILL BE SUPPLIED UNDER WALL INTO LOT AND WILL BE MARKED WITH 900x50x25 HW STAKE LABELLED "ELECTRICITY".
- G** GAS - GAS MAIN EXISTS IN ROAD VERGE. BUILDER/HOME OWNER TO MAKE APPLICATION TO GAS PROVIDER FOR SERVICE INSTALLATION TO LOT.
- ---** RETAINING WALL
- ⊗ ⊗** SERVICE TERMINATION POINT MARKER. 900x50x25 HW STAKE, OR 40Ø ORANGE PVC CONDUIT STAKE

**LEGEND - PROPOSED**

- D** STORMWATER
- S** GRAVITY SEWER
- RM** SEWER RISING MAIN
- TS** TRUNK SEWER
- W** WATER
- E** ELECTRICITY

**LEGEND - EXISTING**

- D** STORMWATER
- S** GRAVITY SEWER
- RM** SEWER RISING MAIN
- TS** TRUNK SEWER
- W** WATER
- E** ELECTRICITY

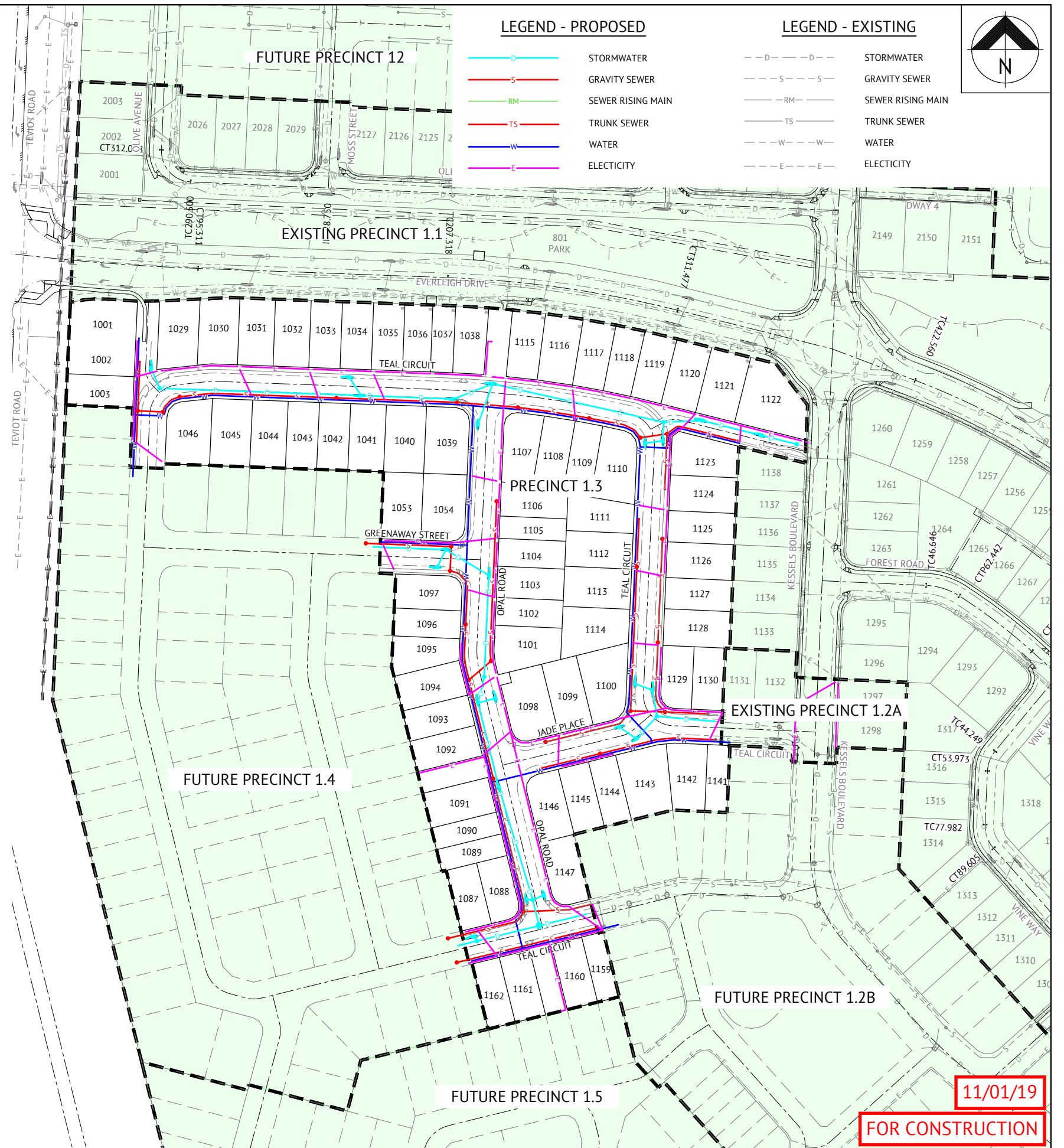
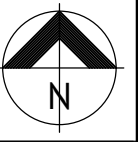

02/07/18		A		ORIGINAL ISSUE	KH		RPEQ								
DATE		REV		DESCRIPTION	REVISIONS										
				<b>BRISBANE OFFICE</b> LEVEL 1, 100 BRUNSWICK STREET PO BOX 361 FORTITUDE VALLEY, QLD 4006 PH: (07) 3253 2222 WEB: www.premise.com.au				DESIGNED MICHAEL MAJZNER CHECKED MICHAEL MAJZNER PROJECT MANAGER JOSHUA STONE PROJECT DIRECTOR JOSHUA STONE		RPEQ JOSHUA STONE DATE 02/07/18 SCALE RPEQ 15187		CLIENT <b>MIRVAC</b> PROJECT <b>EVERLEIGH PRECINCT 1.3 SUBDIVISION DEVELOPMENT</b> LOCATION <b>TEVIOT ROAD, GREENBANK</b> SHEET TITLE <b>OVERALL SERVICES LAYOUT</b>		JOB CODE <b>MIR001-03</b> SHEET NUMBER <b>C003</b> REV <b>A</b>	

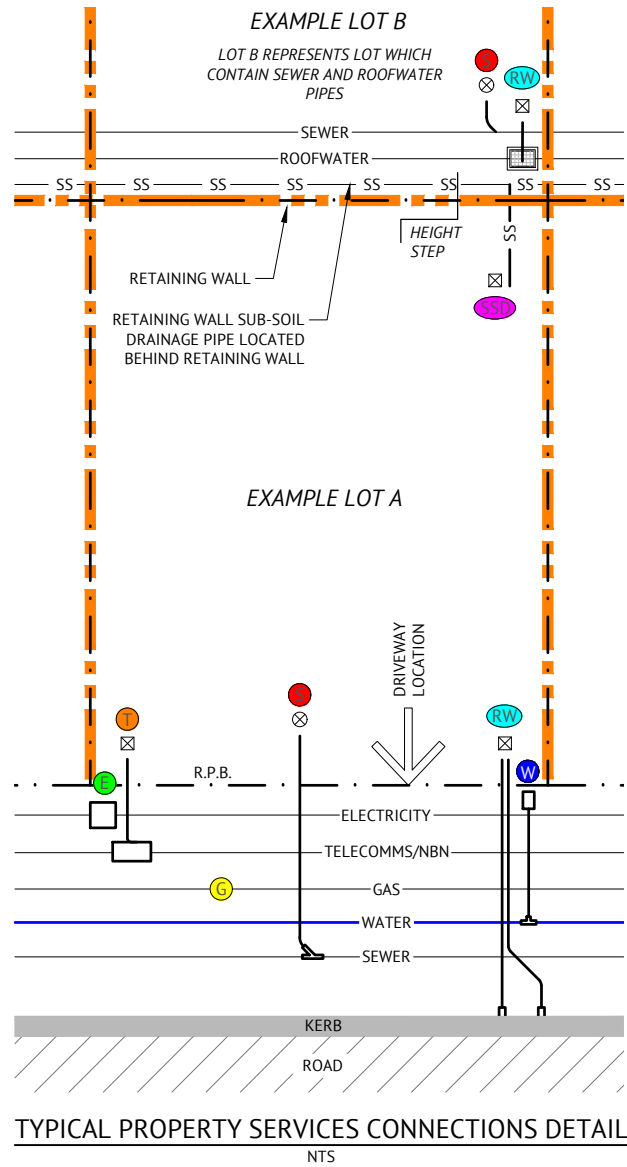

**LEGEND - PROPERTY SERVICE CONNECTIONS**

- W** WATER - POLY SERVICE FROM WATER MAIN, METER BOX & COVER INSTALLED. BUILDER TO MAKE APPLICATION TO LOGAN CITY COUNCIL FOR METER ASSEMBLY SUPPLY AND INSTALLATION. WHERE WATER METER IS LOCATED BEHIND RETAINING WALL, 25mm POLYPIPE WILL BE SUPPLIED UNDER WALL INTO LOT AND WILL BE MARKED WITH 900x50x25 HW STAKE LABELLED "WATER".
- S** SEWER - CAPPED Ø100 PVC PIPE (BURIED MAX 1.5m). MARKED WITH 40Ø ORANGE PVC CONDUIT AT SURFACE (BURIED TO CAPPED PIPE). CONDUIT LABELLED "SEWER."
- RW** ROOFWATER - CONNECTION LOCATION CAN BE EITHER FRONT OF LOT VIA KERB ADAPTOR OUTLET TO ROAD, OR REAR OF LOT INTO ROOFWATER DRAINAGE PIPE VIA PIT. CAPPED PVC Ø100 PIPES (BURIED MAX 1.5m) MARKED WITH 900x50x25 HW STAKE LABELLED "ROOFWATER."
- SSD** RETAINING WALL SUB-SOIL DRAINAGE - OUTLET POINT TO LOT FOR RETAINING WALL SUB-SOIL DRAINAGE TO BE CONNECTED TO YARD DRAINAGE BY BUILDER. Ø100 NON-SLOTTED AGG PIPE CAPPED AND TERMINATED 200m ABOVE SURFACE. PVC DUCT TAPED TO 900x50x25 HW STAKE LABELLED "RETAINING WALL SUBSOIL OUTLET".
- T** TELECOMMUNICATIONS/NBN - PVC CONDUIT (BURIED APPROX 300mm), MARKED WITH 900x50x25 HW STAKE LABELLED "TELECOMMS".
- E** ELECTRICITY - ELECTRICITY PILLAR EXISTS IN ROAD VERGE. BUILDER TO MAKE APPLICATION WITH ENERGY PROVIDER FOR SERVICE INSTALLATION TO LOT. WHERE ELECTRICITY PILLAR IS LOCATED BEHIND RETAINING WALL, CONDUIT WILL BE SUPPLIED UNDER WALL INTO LOT AND WILL BE MARKED WITH 900x50x25 HW STAKE LABELLED "ELECTRICITY".
- G** GAS - GAS MAIN EXISTS IN ROAD VERGE. BUILDER/HOME OWNER TO MAKE APPLICATION TO GAS PROVIDER FOR SERVICE INSTALLATION TO LOT.
- RETAINING WALL
- ⊗** SERVICE TERMINATION POINT MARKER. 900x50x25 HW STAKE, OR 40Ø ORANGE PVC CONDUIT STAKE

**LEGEND - PROPOSED**

- D** STORMWATER
- S** GRAVITY SEWER
- RM** SEWER RISING MAIN
- TS** TRUNK SEWER
- W** WATER
- E** ELECTRICITY

**LEGEND - EXISTING**

- D** STORMWATER
- S** GRAVITY SEWER
- RM** SEWER RISING MAIN
- TS** TRUNK SEWER
- W** WATER
- E** ELECTRICITY

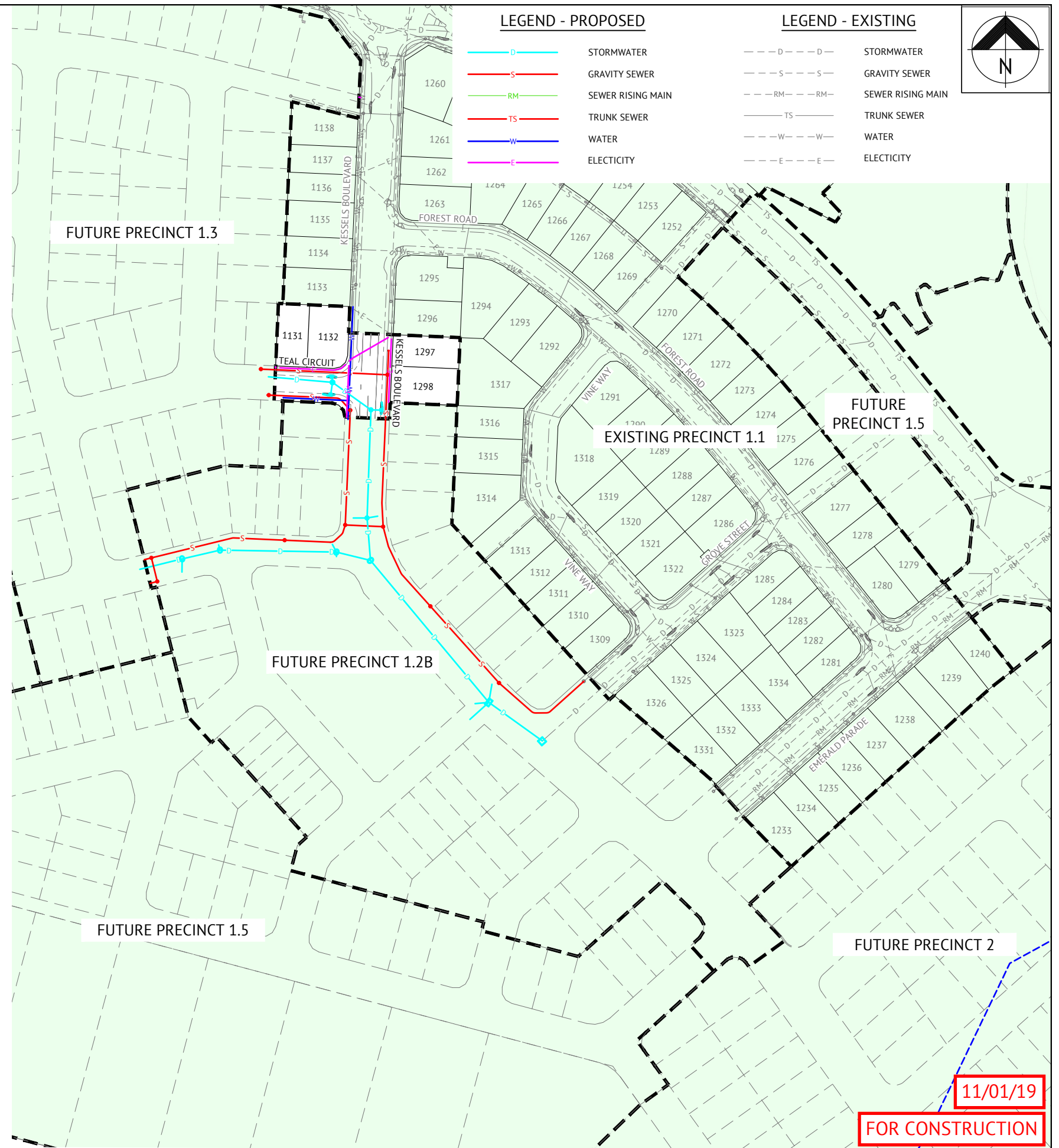
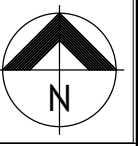

11/01/19

FOR CONSTRUCTION

DATE	REV	DESCRIPTION	REVISIONS
02/07/18	A	ORIGINAL ISSUE	

**Premise**

**BRISBANE OFFICE**  
LEVEL 1, 100 BRUNSWICK STREET  
PO BOX 361  
FORTITUDE VALLEY, QLD 4006  
PH: (07) 3253 2222  
WEB: www.premise.com.au

DESIGNED	MICHAEL MAJZNER	RPEQ	DATE	02/07/18
CHECKED	MICHAEL MAJZNER			
PROJECT MANAGER	JOSHUA STONE			
PROJECT DIRECTOR	JOSHUA STONE		DATE	02/07/18

CLIENT	MIRVAC	JOB CODE	MIR001-02A
PROJECT	EVERLEIGH PRECINCT 1.2A SUBDIVISION DEVELOPMENT	SHEET NUMBER	C003
LOCATION	TEVIOT ROAD, GREENBANK	REV	A
SHEET TITLE	OVERALL SERVICES LAYOUT		