

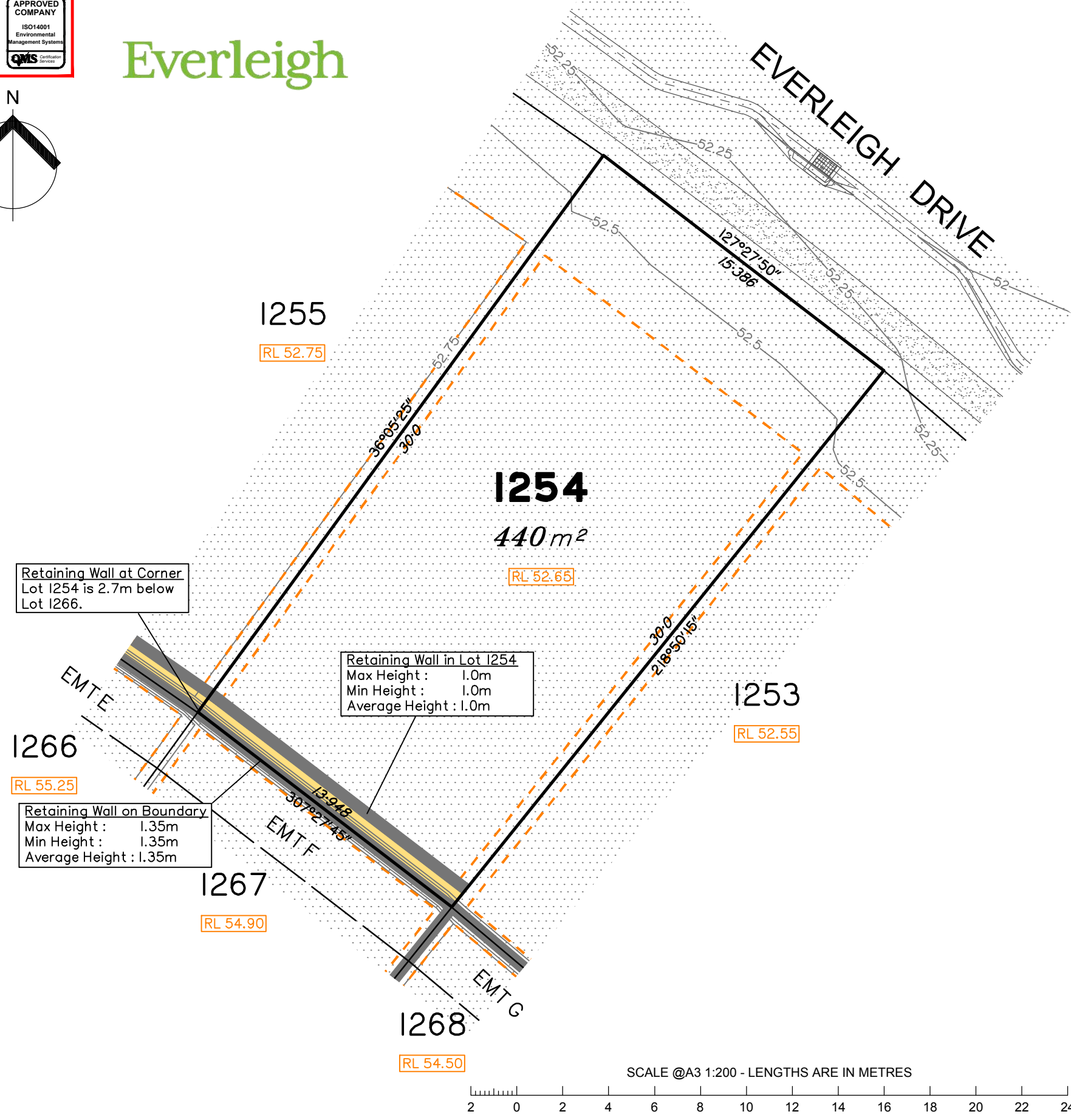

**Everleigh**

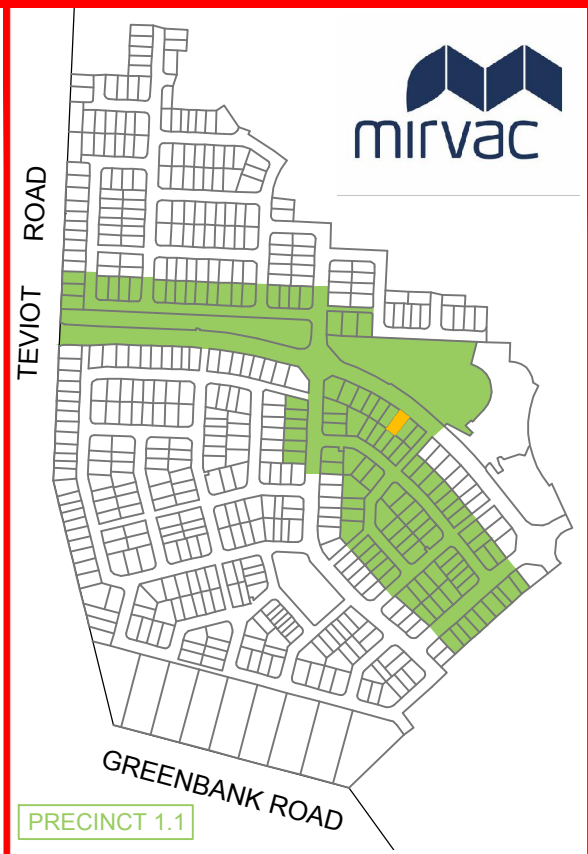

- LEGEND**
- Area of Fill
  - Area of Cut
  - Design Contours
  - Depth of Fill Contours
  - Proposed Retaining Wall
  - Proposed Tiered Retaining Wall
  - Proposed Earthworks Pad
  - RL XX.XX Finished Pad Design Level
  - XX.XX Finished Surface Design Level
- (Not all items in this legend may be relevant to the lot shown hereon)



**PRECINCT 1.1**

**NOTES**

This plan has been prepared from preliminary survey plan (SP300871) and engineering plans & mark-ups provided on the 25/01 & 12/04/18 by Premise Engineering Pty Ltd.

Development approval was granted for this subdivision (DEV2016/768) by the Minister for Economic Development Queensland (20/03/18).

The relevant authorities have granted operational works approval, for the proposed lot.

Extent of retaining walls shown indicatively only. Retaining walls may not extend the full length of a lot boundary where finished level between allotments is less than 0.5m.

The purchaser should refer to the applicable development approvals for building and/or other requirements that may be applicable to the lot.

Parts of this lot may be subject to rip and re-compact earthwork procedures as determined by site conditions. This process may be completed in cut locations to assist the house pad construction. Any re-compaction will comply with AS3798 requirements and certified by a third party company.

Fill placed between proposed tiered retaining walls will generally be equal to the height of the top of the bottom retaining wall.

No.	by	Date	Description
A	TBG	17/04/18	Original Issue

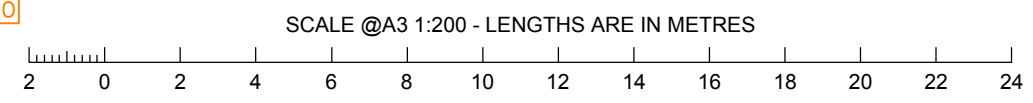

**saunders havill group**

Saunders Havill Group Pty Ltd ABN 24 144 972 949  
 Brisbane • Emerald • Rockhampton  
 head office 9 Thompson St Bowen Hills Q 4006  
 phone 1300 123 SHG web www.saundershavill.com

■ surveying ■ town planning ■ urban design ■ environmental management ■ landscape architecture

This Disclosure Plan is prepared for the sole purpose of satisfying the disclosure requirements of the Land Sales Act and SHOULD NOT be used for any other purpose, particularly as-constructed purposes. This information is compiled from design plans only, unless otherwise stated, and therefore is subject to final survey and construction of operational works.

**Disclosure Plan for Proposed Lot 1254 on SP300871**

Described as part of Lot 2 on SP297192  
 Existing Title Reference: 51103071

Locality of Greenbank (Logan City Council)

Level Datum: AHD der.  
 Origin of Levels: PM61308  
 RL of Origin: 54.66  
 Contour Interval: 0.25m

Scale @A3 1: 200  
 Dwg No. 7598 S 13 DP A\_1254